

DC Connector, Socket, 6.3 mm, 2.35 mm, 2-pole, solder terminal



Description

- Solder terminal:
Screw-on mounting, from rear-side
- Low Voltage DC Plug and Socket
- DC Plug: 2-pole, straight

Weblinks

[pdf-datasheet](#), [html-datasheet](#), [General Product Information](#), [RoHS](#), [CHINA-RoHS](#), [REACH](#), [Mating Connectors](#), [e-Shop](#), [SCHURTER-Stock-Check](#), [Distributor-Stock-Check](#)

Technical Data

Diameter	6.3 mm / 2.35 mm
Number of Poles	2-pole
Ratings DC	1 A / 12VDC
Dielectric Strength	500VDC
Insulation Resistance	> 100 MΩ @ 500VDC

Allowable Operation Temp.	-20°C to 70°C
Terminal	solder terminal silver plated
Mounting	Screw-on mounting wall thickness max. 5.5 mm
Style	straight
Lifetime	5000 Insertions

Dimensions

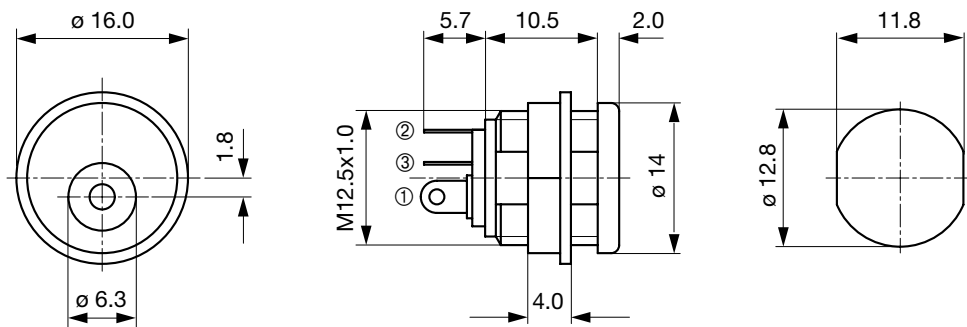

Diagrams

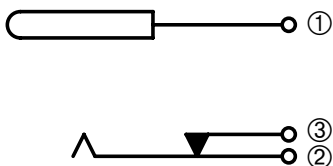

All Variants

Product group	Diameter [mm]	Number of Poles	Terminal	Order Number
DC Plug/Socket	6.3	2-pole	solder terminal	4840.2210

Most Popular.

Availability for all products can be searched real-time: <http://www.schurter.com/en/Stock-Check/Stock-Check-SCHURTER>

Packaging unit 250 Pcs

Mating Inlets/Plugs

Category / Description

[DC Plug/Socket Overview complete](#)



DC Connector, Plug, 5.5x2.5 mm, 2-pole, solder terminal	4840.1210
DC Connector, Plug, 5.5x2.5 mm, 2-pole, straight, with cable	4840.5210
DC Connector, Plug, 5.5x2.5 mm, 2-pole, angled, with cable	4840.5211
DC Plug/Socket further types to 4840 DC-Stecker, verschiedene	

AMEYA360

Components Supply Platform

Authorized Distribution Brand :



Website :

Welcome to visit www.ameya360.com

Contact Us :

➤ Address :

401 Building No.5, JiuGe Business Center, Lane 2301, Yishan Rd
Minhang District, Shanghai , China

➤ Sales :

Direct +86 (21) 6401-6692

Email amall@ameya360.com

QQ 800077892

Skype [ameyasales1](#) [ameyasales2](#)

➤ Customer Service :

Email service@ameya360.com

➤ Partnership :

Tel +86 (21) 64016692-8333

Email mkt@ameya360.com