

## Antenna, Sensor, and Communications Trunk Line Connections

# GT17 Series

— Ideal as Automotive USB Connectors —  
<2 mm pitch>

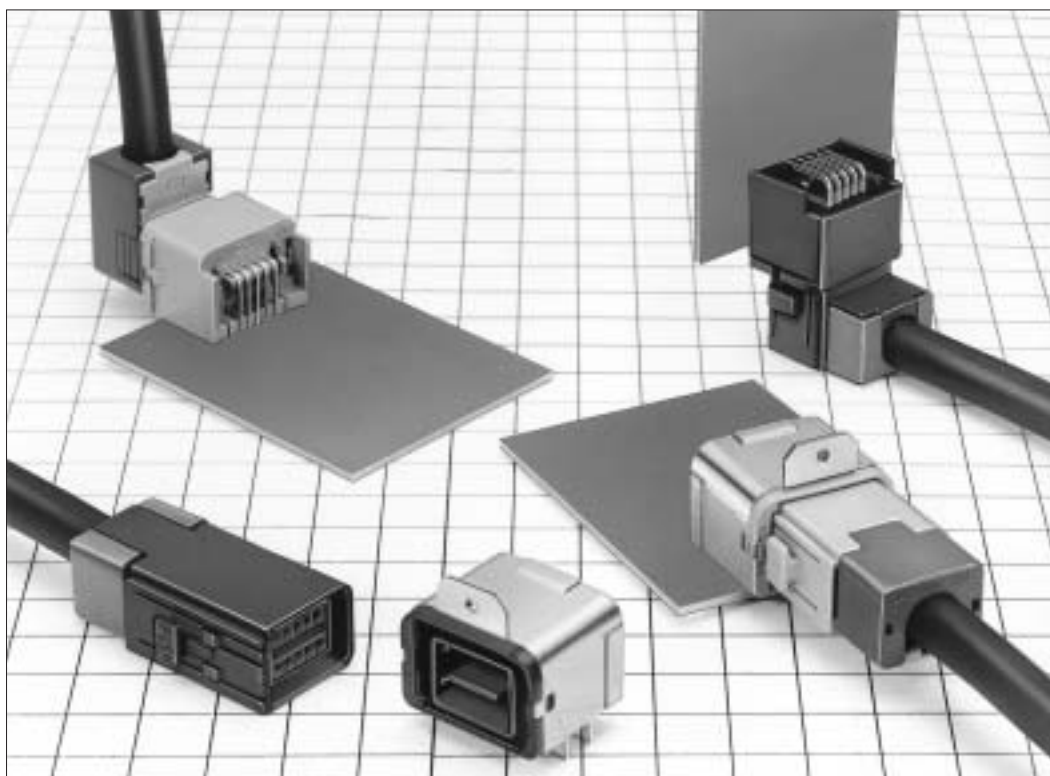

### Features

- All surface shielded construction.
- Ideal for use as Automotive USB connectors.

### Applications

In-car data communications, etc.

## GT17 Series

### F Connectors

#### ● Center Terminals (Used with 6, 8, and 10 conductor cable)

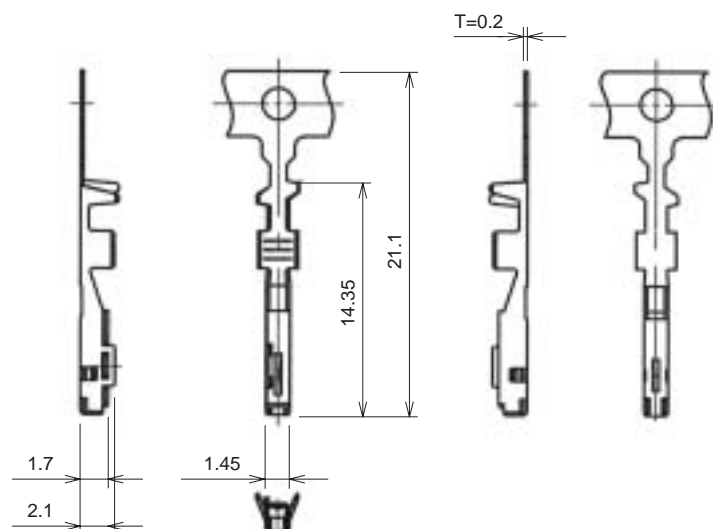

Part Number	CL No.	Material	Finish	Conductor Size (AWG)	Outer Diameter	Packaging
GT17-2022SCF	767-0009-0	Copper alloy	Tin plating	#20 to 22	1.1 to 1.3 mm	10,000 pcs. per reel
GT17-2428SCF	767-0010-0	Copper alloy	Tin plating	#24 to 28	0.7 to 1.0 mm	10,000 pcs. per reel
GT17-30SCF	767-0064-9	Copper alloy	Tin plating	#30	1.1 to 1.3 mm	10,000 pcs. per reel

### F Connectors (6-Conductor Type)

#### ● Insulator

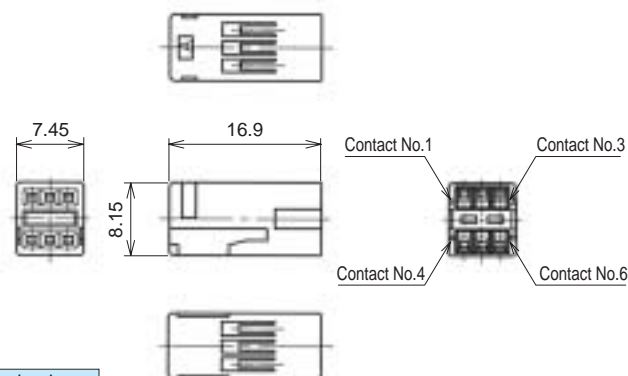

Part Number	CL No.	Material	Color	Packaging
GT17V-6DS-2C	767-0026-0	PBT	Dark gray	1

Note: Applicable Cable will have an Insulator diameter of 0.7 to 1.3 mm.

#### ● Outer terminal

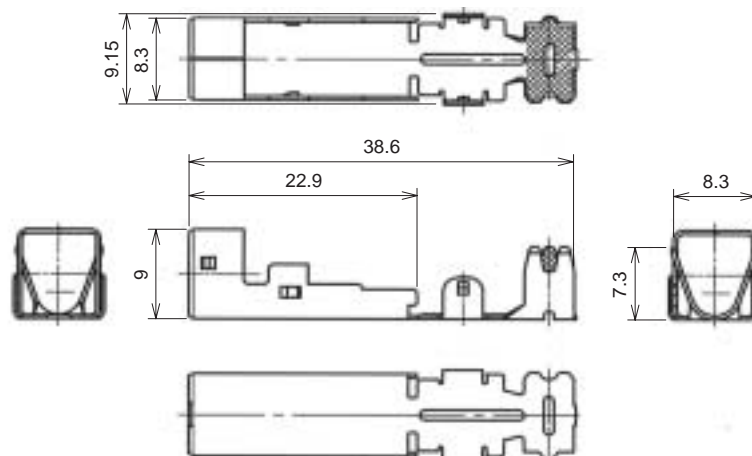
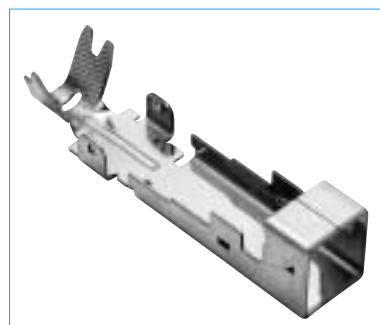

Part Number	CL No.	Material	Finish	Outer Diameter	Packaging
GT17V-6DS-5CF	767-0027-2	Copper alloy	Tin plating	4.8 to 5.2 mm	1

Note: The crimping conditions will differ depending on the construction and material of the cable. In view of this, please make arrangements to ascertain whether crimping is possible for each cable.

## ● Shield Cover

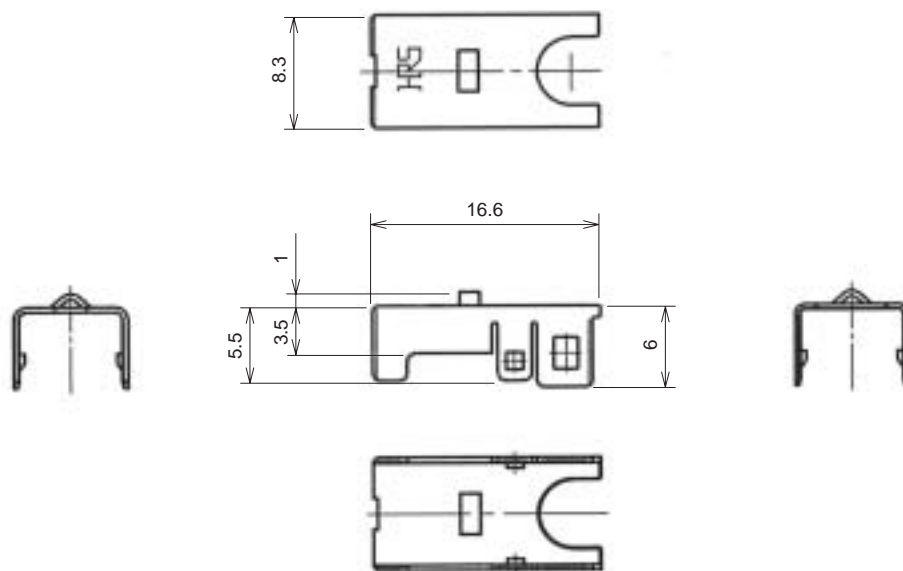
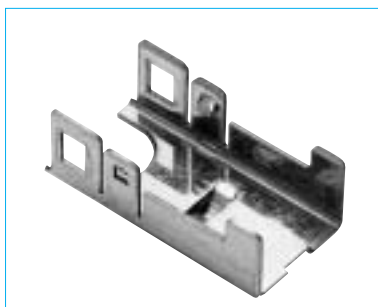

Part Number	CL No.	Material	Finish	Packaging
GT17V-6DS-SC	767-0028-5	Copper alloy	Tin plating	1

## ● Housing



GT17V-6DS-HU

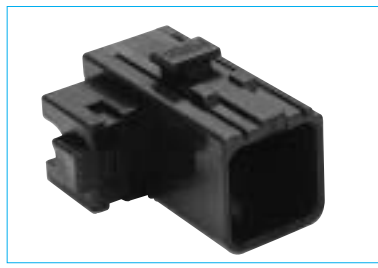

GT17VA-6DS-HU

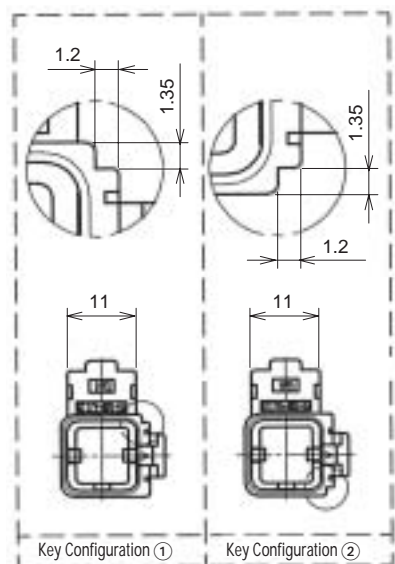

Key Configuration ①

Key Configuration ②

## ◆ Shown with inserted retainer

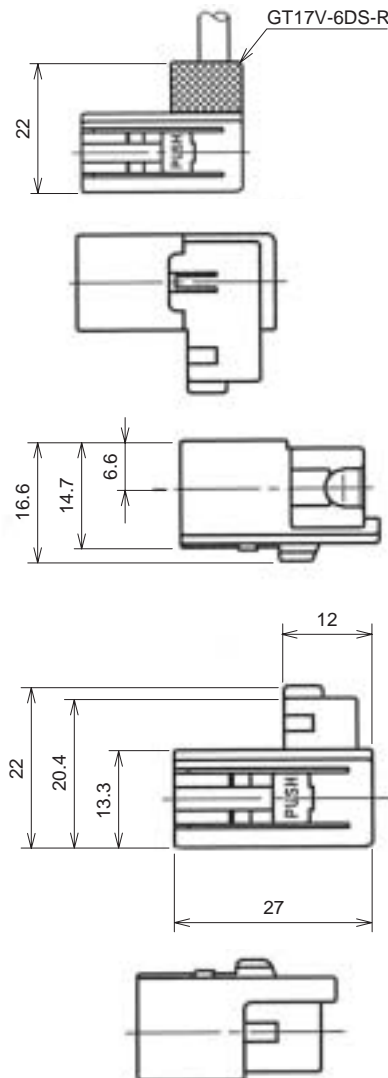

Part Number	CL No.	Material	Color	Key Configurations	Packaging
GT17V-6DS-HU	767-0029-8	PBT	Light gray	①	1
GT17VA-6DS-HU	767-0030-7	PBT	Black	②	1

Note 1: Used with the separate retainer (GT17V-6DS-R).

Note 2: Applicable Cable will have an outside sheath diameter of 4.8 to 5.2 mm.

## GT17 Series

### ● Retainer (Used with GT17V-6DS-HU and GT17VA-6DS-HU)

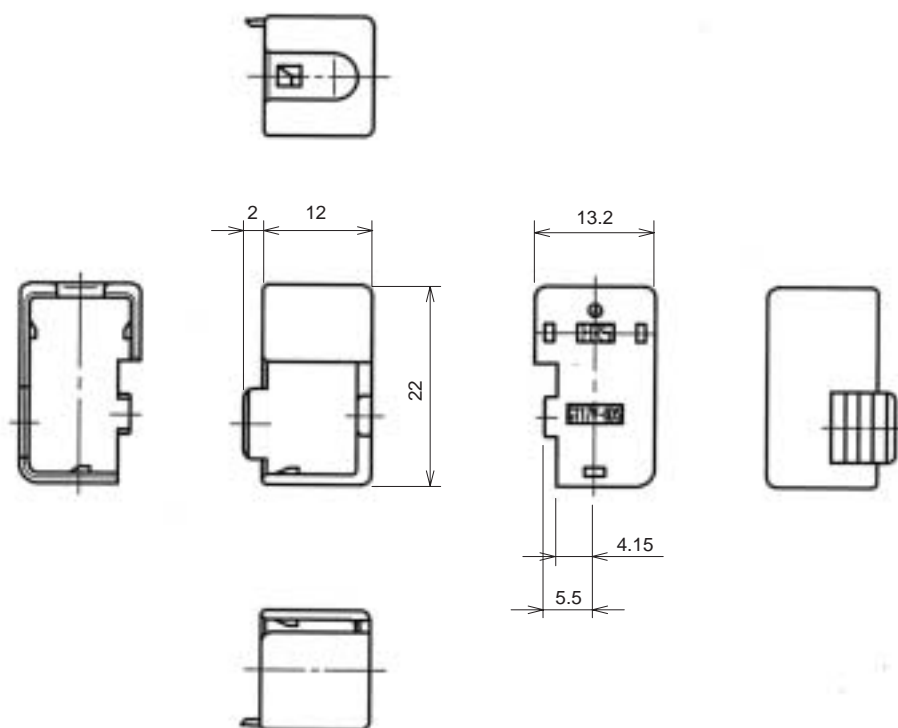

Part Number	CL No.	Material	Color	Packaging
GT17V-6DS-R	767-0031-0	PBT	Dark gray	1

Note: Applicable Cable will have an Insulator diameter of 4.8 to 5.2 mm.

### ◆ F Connector (6-Conductor Type) Composition Table

Inner Terminal	Insulator	Outer Terminal	Shield Cover	Housing	Retainer
GT17-2022SCF	GT17V-6DS-2C	GT17V-6DS-5CF	GT17V-6DS-SC	GT17V-6DS-HU	GT17V-6DS-R
GT17-2428SCF				GT17VA-6DS-HU	
GT17-30SCF					

### ◆ 6-Conductor Type Mating Table

F Connector	M Connector	Color
GT17V-6DS-HU	GT17V-6DP-DS	Light gray
	GT17VB-6DP-DS	
GT17VA-6DS-HU	GT17VA-6DP-DS	Black
	GT17VC-6DP-DS	

## M Connectors (6-Conductor Type)

### ● Printed Circuit Board Type

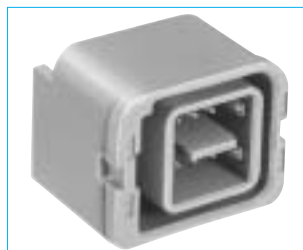

GT17V-6DP-DS



GT17VA-6DP-DS

#### ◆ Panel Insertion Portion Dimensions

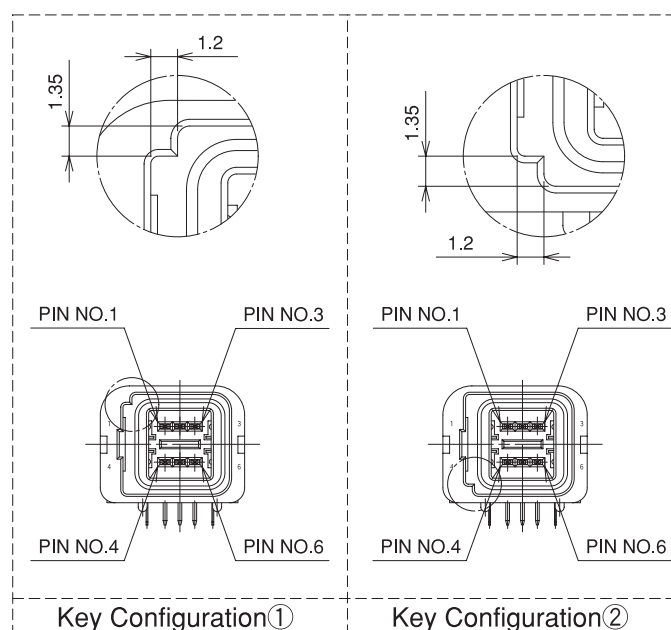
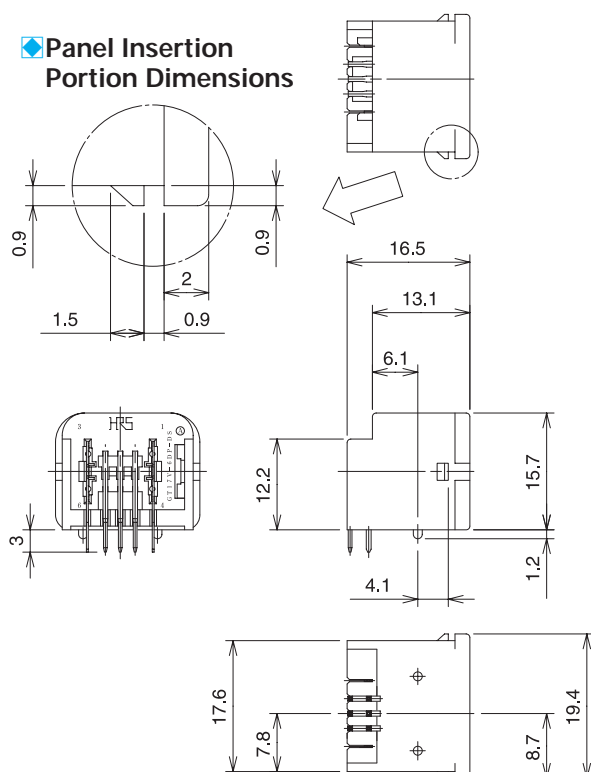

#### ◆ Mounted and fully mated connector assemblies

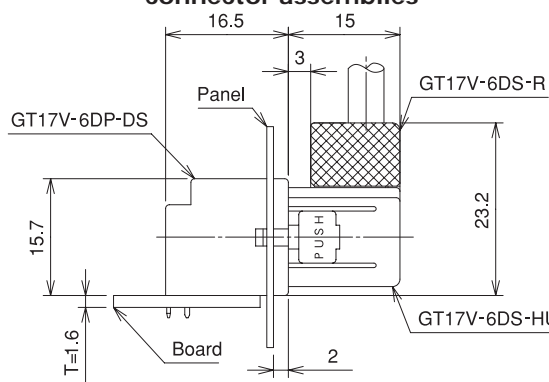

#### ◆ Recommended PCB Mounting Pattern

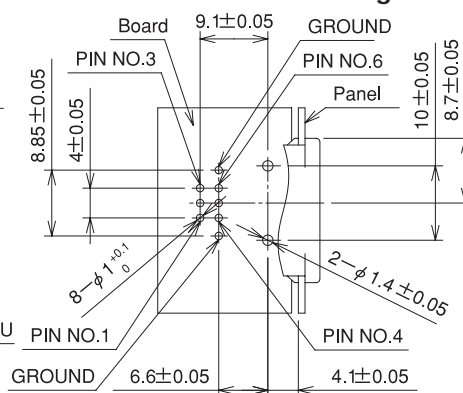

#### ◆ Recommended Panel Cut-out

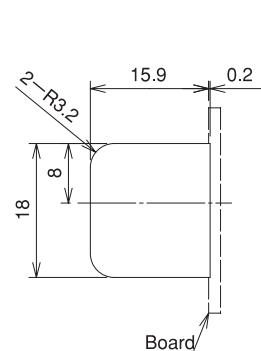

Part Number	HRS No.	Material	Color	Key Configurations	Direction of Cable Pull-off	Packaging
GT17V-6DP-DS	767-0024-4	Brass (Center terminal) Copper alloy (Outer terminals)	Light gray	①	Upward with respect to the mounting surface	1
GT17VA-6DP-DS	767-0025-7	PBT (Housing)	Black	②		1
GT17V-6DP-DS(70)	767-0024-4-70		Light gray	①		1
GT17VA-6DP-DS(70)	767-0025-7-70		Black	②		1

(70):Pb free products.

## GT17 Series



GT17VB-6DP-DS



GT17VC-6DP-DS

### Panel Insertion Portion Dimensions

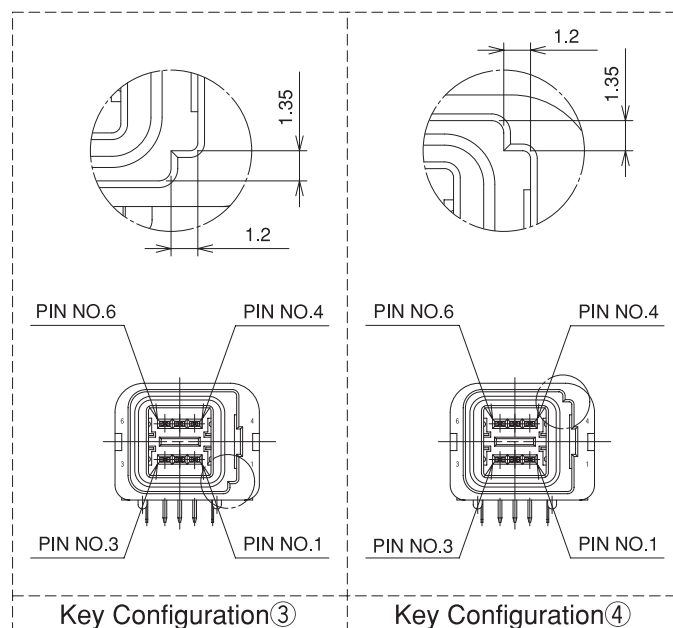
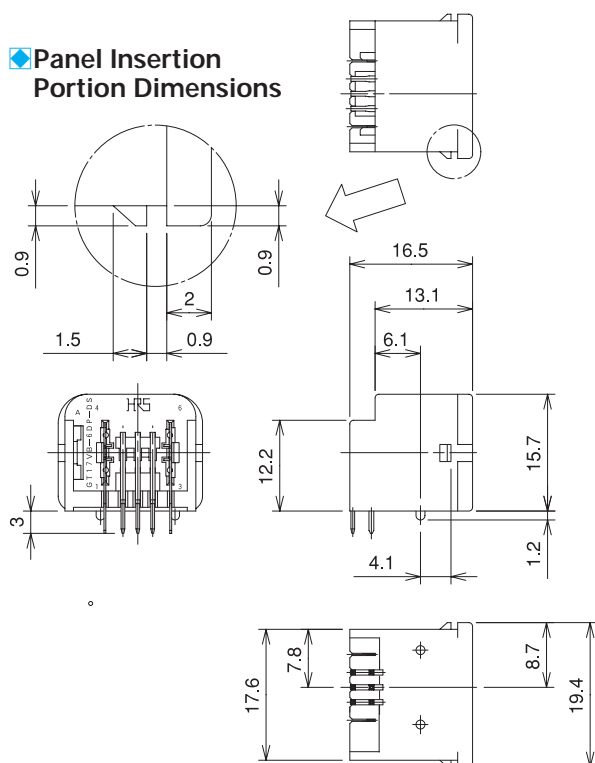

### Mounted and fully mated connector assemblies

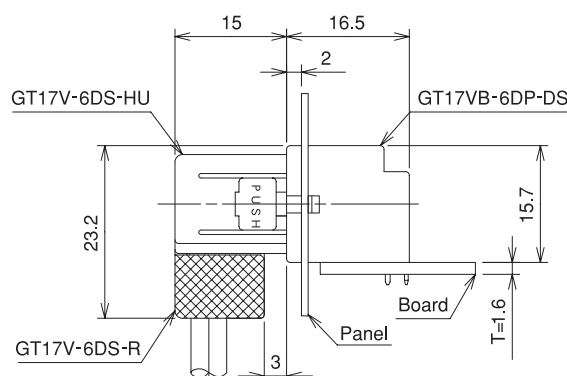

### Recommended PCB Mounting Pattern

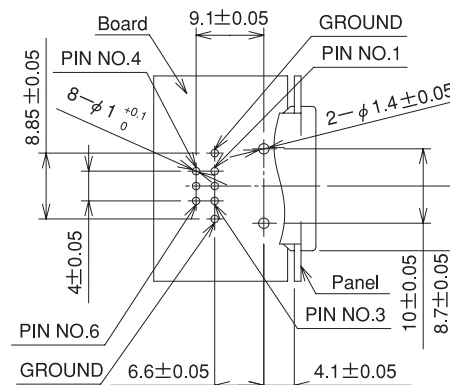

### Recommended Panel Cut-out

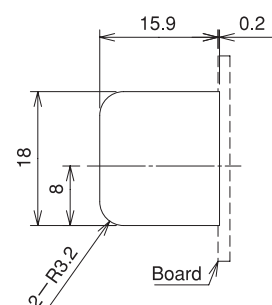

Part Number	HRS No.	Material	Color	Key Configurations	Direction of Cable Pull-off	Packaging
GT17VB-6DP-DS	767-0032-2	Brass (Center terminal)	Light gray	③	Downward with respect to the mounting surface	1
GT17VC-6DP-DS	767-0033-5	Copper alloy (Outer terminals)	Black	④		1
GT17VB-6DP-DS(70)	767-0032-2-70	PBT (Housing)	Light gray	③		1
GT17VC-6DP-DS(70)	767-0033-5-70		Black	④		1

(70):Pb free products.

## F Connectors (8-Conductor Type)

### ● Insulator

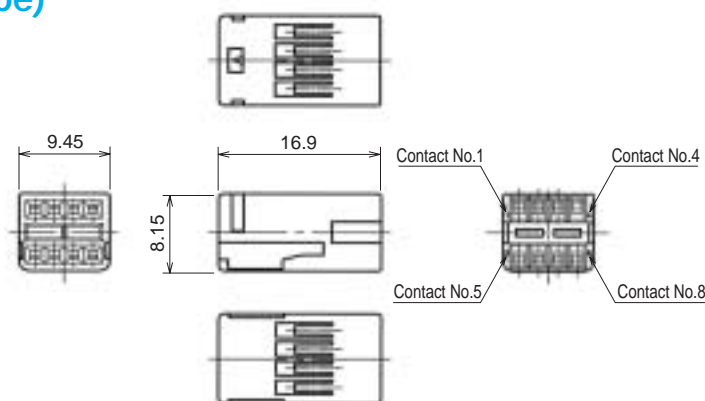

Part Number	CL No.	Material	Color	Packaging
GT17-8DS-2C	767-0005-0	PBT	Dark gray	1

Note: Applicable Cable will have an Insulator diameter of 0.7 to 1.3 mm.

### ● Outer terminals

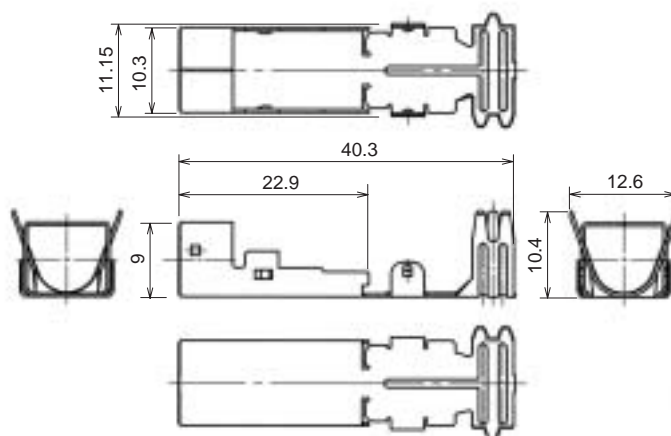

Part Number	CL No.	Material	Finish	Outer Diameter	Packaging
GT17-8DS-7CF	767-0007-5	Phosphor bronze	Tin plating	6.8 to 7.2 mm	1
GT17-8DS-7CF(70)	767-0007-5(70)	Phosphor bronze	Tin plating	6.8 to 7.2 mm	1

(70):Pb free products.

Note: The crimping conditions will differ depending on the construction and material of the cable. In view of this, please make arrangements to ascertain whether crimping is possible for each cable.

### ● Shield Cover

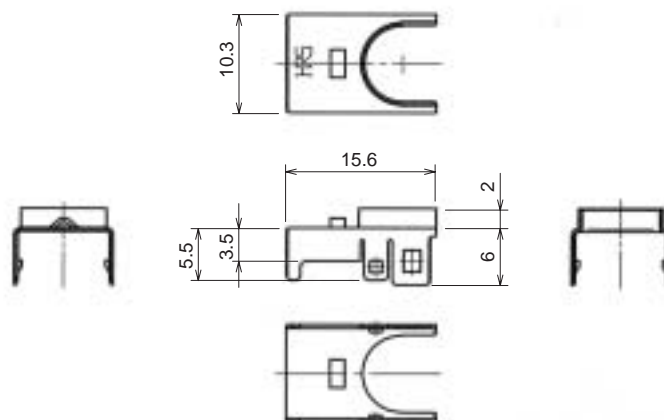

Part Number	CL No.	Material	Finish	Packaging
GT17-8DS-SC	767-0006-2	Brass	Tin plating	1
GT17-8DS-SC(70)	767-0006-2(70)	Brass	Tin plating	1

(70):Pb free products.



## GT17 Series

### ● Housing



GT17-8DS-HU



GT17A-8DS-HU

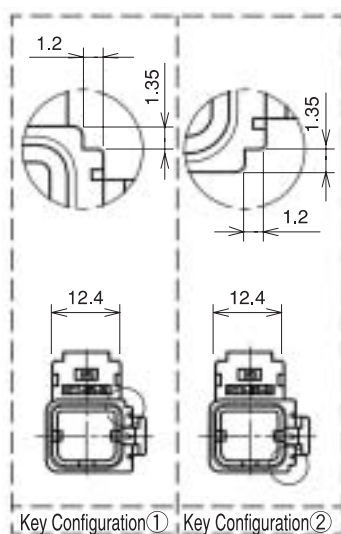

Key Configuration ① Key Configuration ②

### ◆ Shown with inserted retainer

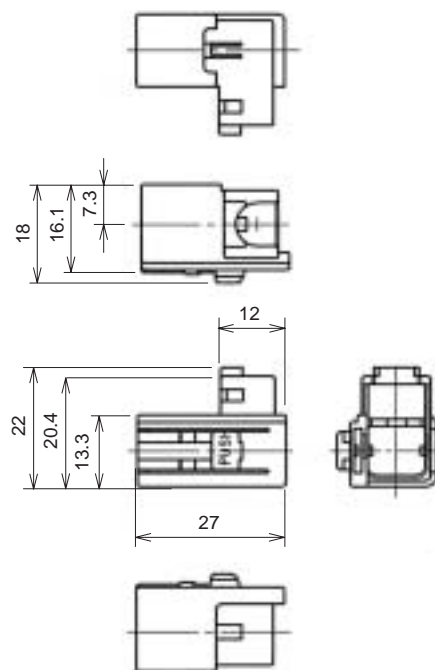
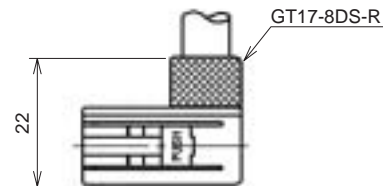

Part Number	CL No.	Material	Color	Key Configurations	Packaging
GT17-8DS-HU	767-0003-4	PBT	Light gray	①	1
GT17A-8DS-HU	767-0004-7	PBT	Black	②	1

Note 1: Used with the separate retainer (GT17-8DS-R).

Note 2: Applicable Cable will have an outside sheath diameter of 6.8 to 7.2 mm.

### ● Retainer

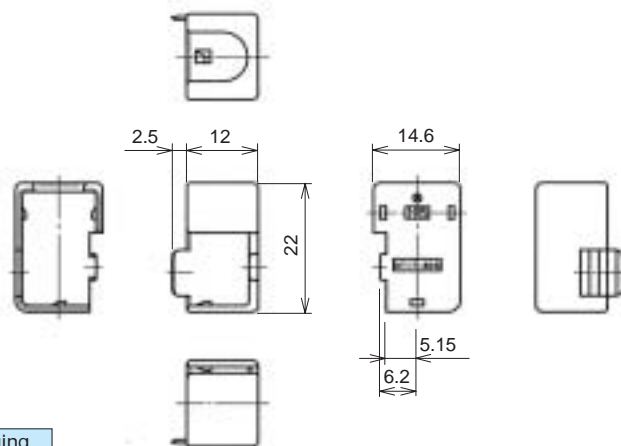

Part Number	CL No.	Material	Color	Packaging
GT17-8DS-R	767-0008-8	PBT	Dark gray	1

Note: Applicable Cables will have an outside sheath diameter of 6.8 to 7.2 mm.



## ◆ F Connector (8-Conductor Type) Composition Table

Inner Terminal	Insulator	Outer Terminal	Shield Cover	Housing	Retainer
GT17-2022SCF	GT17-8DS-2C	GT17-8DS-7CF	GT17-8DS-SC	GT17-8DS-HU	GT17-8DS-R
GT17-2428SCF				GT17A-8DS-HU	
GT17-30SCF					

## ◆ 8-Conductor Type Mating Table

F Connector	M Connector	Color
GT17-8DS-HU	GT17-8DP-DS	Light gray
	GT17B-8DP-DS	
GT17A-8DS-HU	GT17A-8DP-DS	Black
	GT17C-8DP-DS	

## GT17 Series

### M Connectors (8-Conductor Type)

#### Printed Circuit Board Type



GT17-8DP-DS



GT17A-8DP-DS

#### Panel Insertion Portion Dimensions

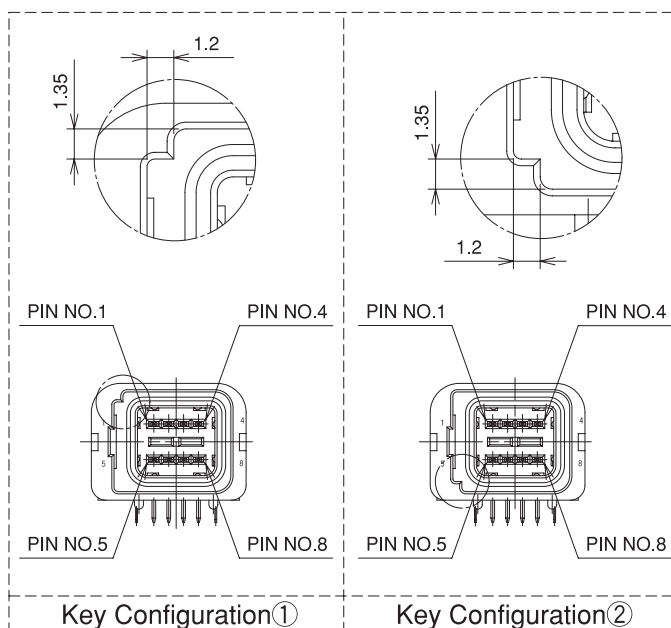
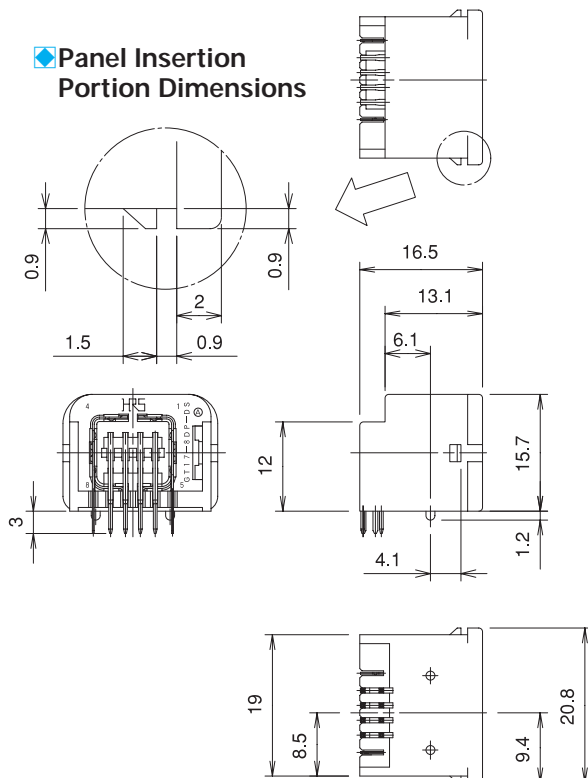

#### Mounted and fully mated connector assemblies

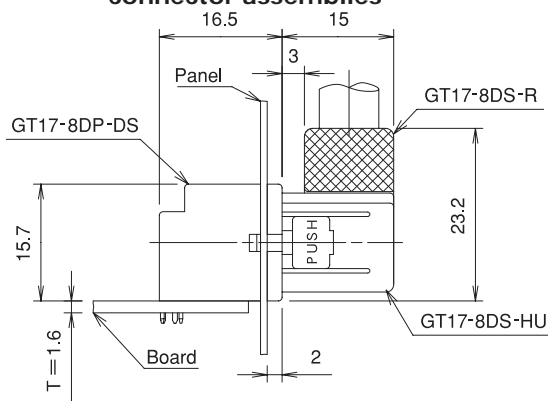

#### Recommended PCB Mounting Pattern

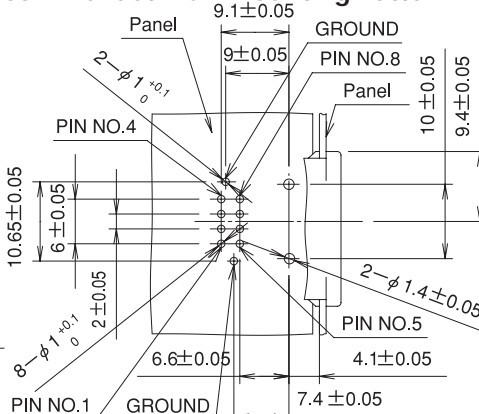

#### Recommended Panel Cut-out

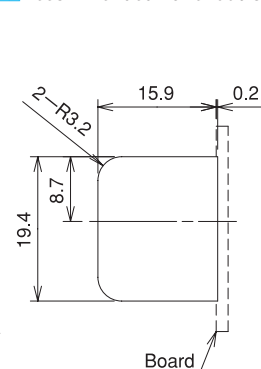

Part Number	HRS No.	Material	Color	Key Configurations	Direction of Cable Pull-off	Packaging
GT17-8DP-DS	767-0001-9	Brass (Center terminal)	Light gray	①	Upward with respect to the mounting surface	1
GT17A-8DP-DS	767-0002-1	Phosphor bronze (Outer terminals)	Black	②		1
GT17-8DP-DS(70)	767-0001-9-70	PBT (Housing)	Light gray	①		1
GT17A-8DP-DS(70)	767-0002-1-70		Black	②		1

(70):Pb free products.



GT17B-8DP-DS



GT17C-8DP-DS

◆ Panel Insertion Portion Dimensions

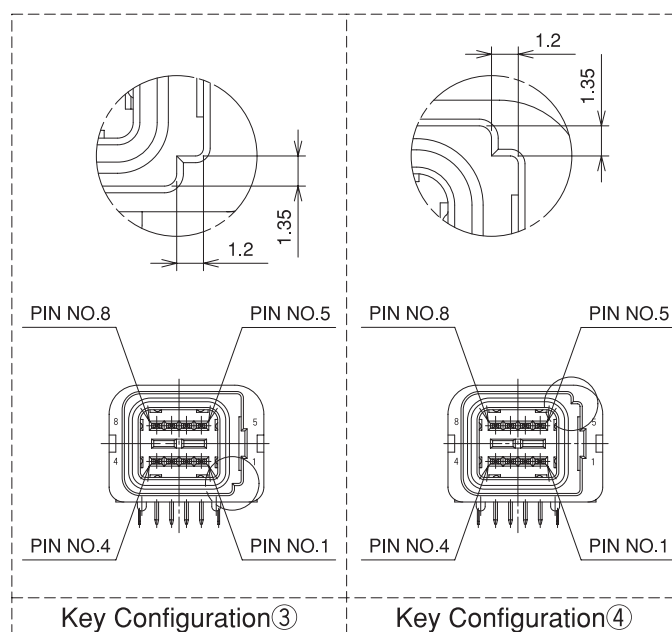
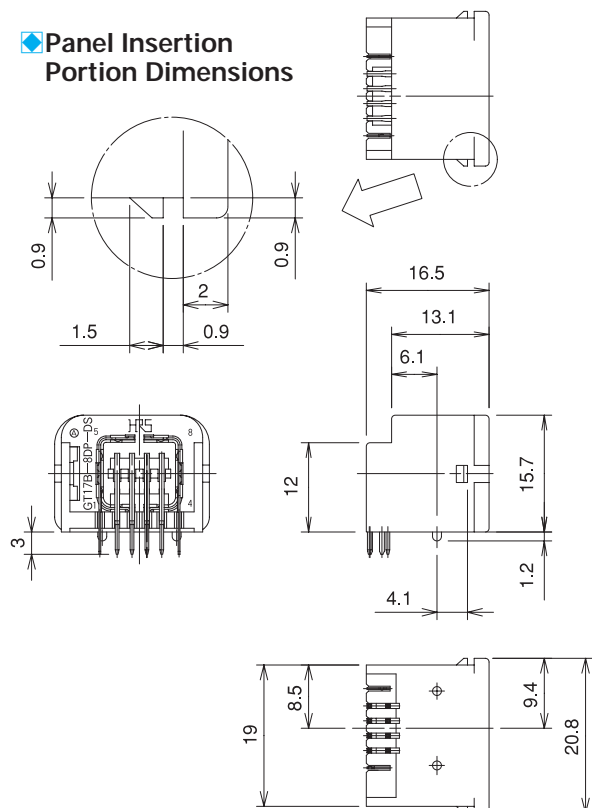

◆ Mounted and fully mated connector assemblies

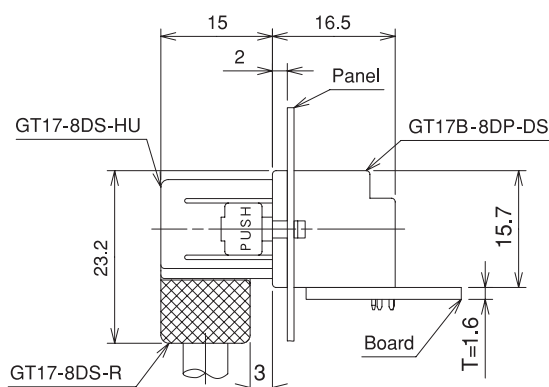

◆ Recommended PCB Mounting Pattern

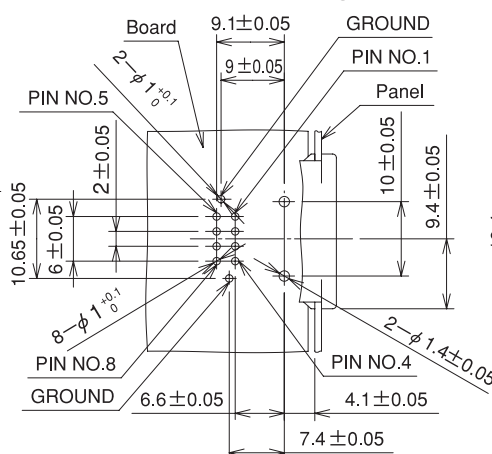

◆ Recommended Panel Cut-out

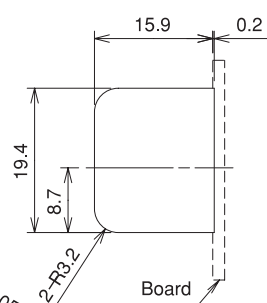

Part Number	HRS No.	Material	Color	Key Configurations	Direction of Cable Pull-off	Packaging
GT17B-8DP-DS	767-0020-3	Brass (Center terminal)	Light gray	③	Downward with respect to the mounting surface	1
GT17C-8DP-DS	767-0021-6	Phosphor bronze (Outer terminals)	Black	④		1
GT17B-8DP-DS(70)	767-0020-3-70	PBT (Housing)	Light gray	③		1
GT17C-8DP-DS(70)	767-0021-6-70		Black	④		1

(70):Pb free products.

## GT17 Series

### F Connectors (10-Conductor Type)

#### ● Insulator (used for both right-angle and straight types)

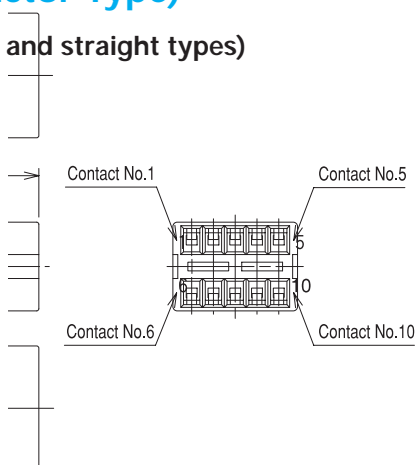

Part Number	CL No.	Material	Color	Packaging
GT17V-10DS-2C	767-0036-3	PBT	Dark gray	1

Note: Applicable Cable will have an Insulator diameter of 0.7 to 1.3 mm.

#### ● Outer terminals (Right Angle Type)

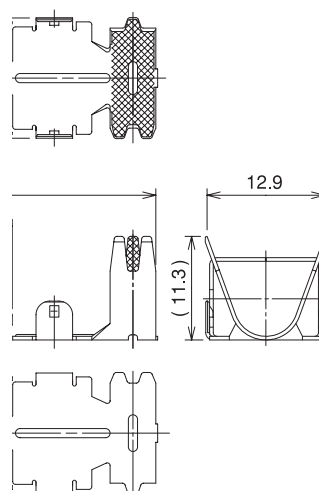
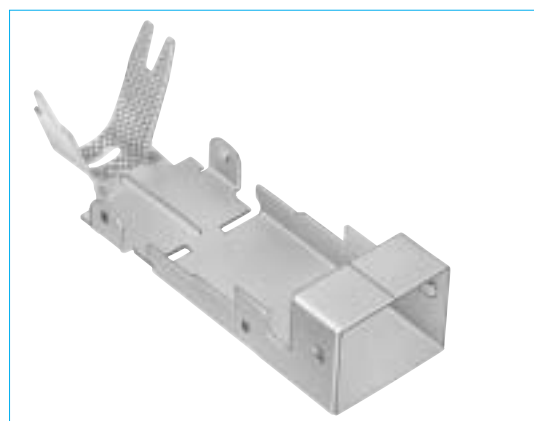

Part Number	CL No.	Material	Finish	Outer Diameter	Packaging
GT17V-10DS-8CF	767-0037-6	Copper alloy	Tin plating	7.5 to 8.0 mm	1

Note: The crimping conditions will differ depending on the construction and material of the cable. In view of this, please make arrangements to ascertain whether crimping is possible for each cable.

#### ● Shield Cover (Right Angle Type)

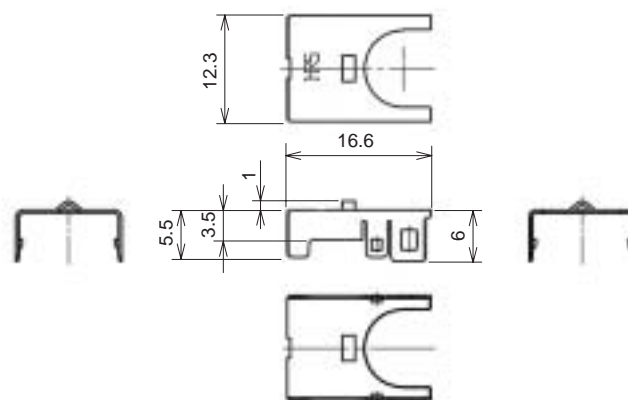
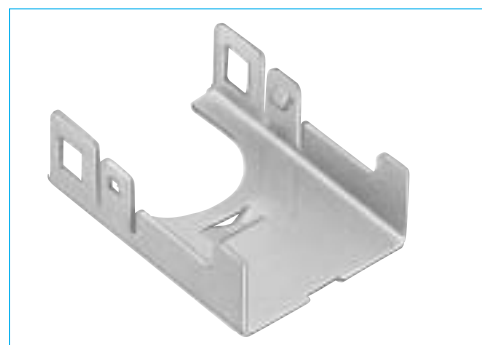

Part Number	CL No.	Material	Finish	Packaging
GT17V-10DS-SC	767-0038-9	Copper alloy	Tin plating	1

## ● Housing (Right-angle Type)

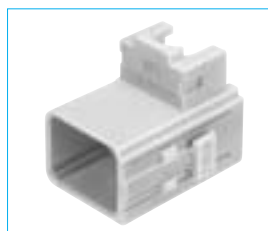

GT17V-10DS-HU



GT17VA-10DS-HU

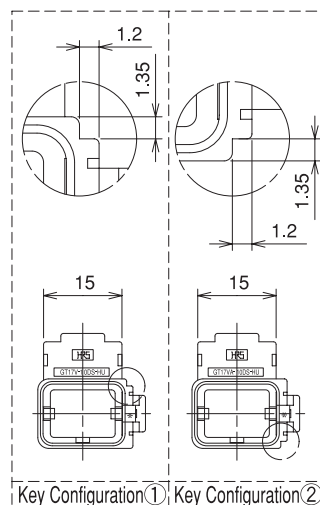

## ◆ Shown with inserted retainer

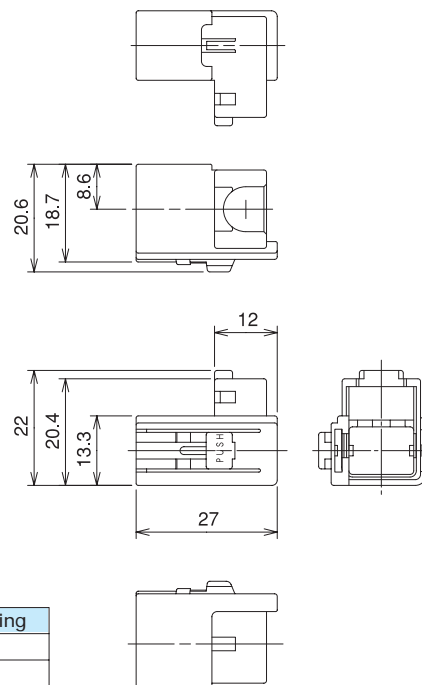
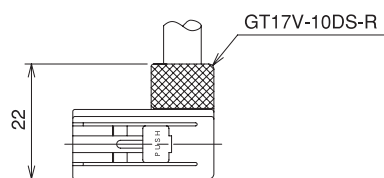

Part Number	CL No.	Material	Color	Key Configurations	Packaging
GT17V-10DS-HU	767-0039-1	PBT	Light gray	①	1
GT17VA-10DS-HU	767-0040-0	PBT	Black	②	1

Note: Used with the separate retainer (GT17-10DS-R).

## ● Retainer (Right-angle Type)

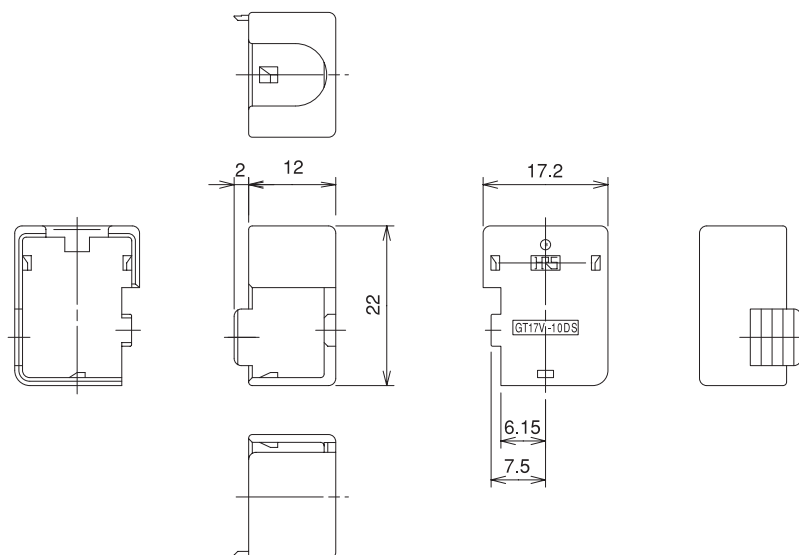

Part Number	CL No.	Material	Color	Packaging
GT17V-10DS-R	767-0041-3	PBT	Dark gray	1

Note: Applicable Cable will have an outside sheath diameter of 7.5 to 8.0 mm.

## GT17 Series

### ● Outer terminals (Straight Type)

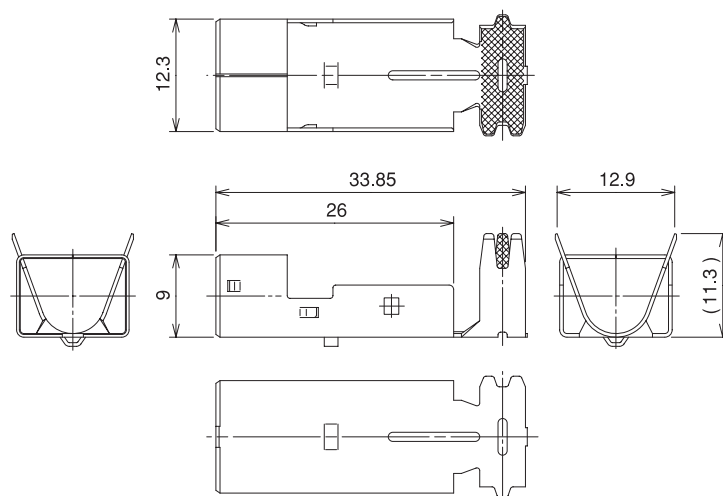
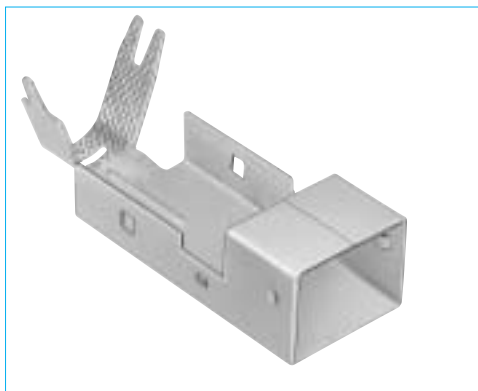

Part Number	CL No.	Material	Finish	Outer Diameter	Packaging
GT17VS-10DS-8CF	767-0059-9	Copper alloy	Tin plating	7.5 to 8.0 mm	1

Note: The crimping conditions will differ depending on the construction and material of the cable. In view of this, please make arrangements to ascertain whether crimping is possible for each cable.

### ● Shield Cover (Straight Type)

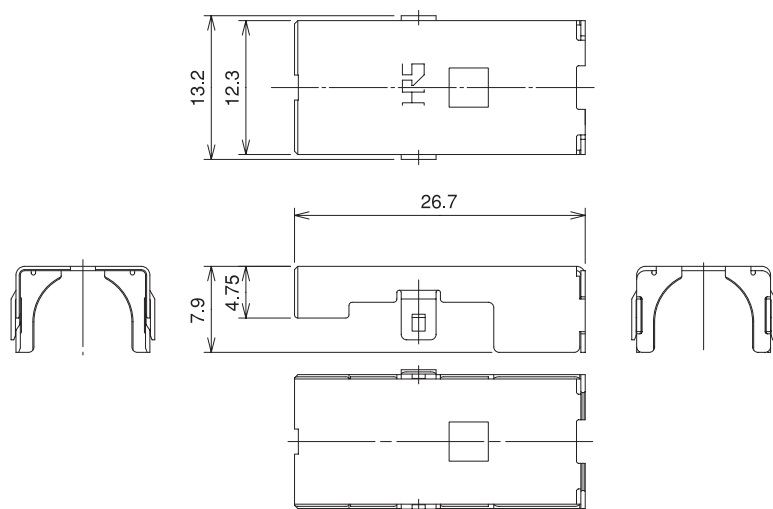
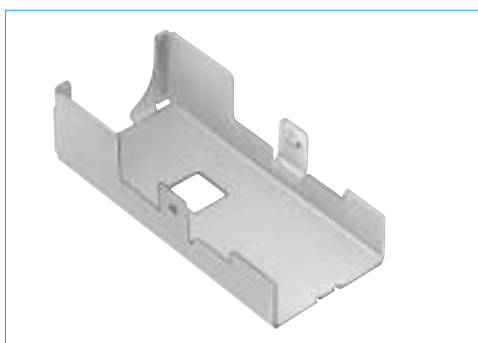

Part Number	CL No.	Material	Finish	Packaging
GT17VS-10DS-SC	767-0060-8	Copper alloy	Tin plating	1

Note: Applicable Cables will have an outside sheath diameter of 7.5 to 8.0 mm.

### ● Retainer (Straight Type)

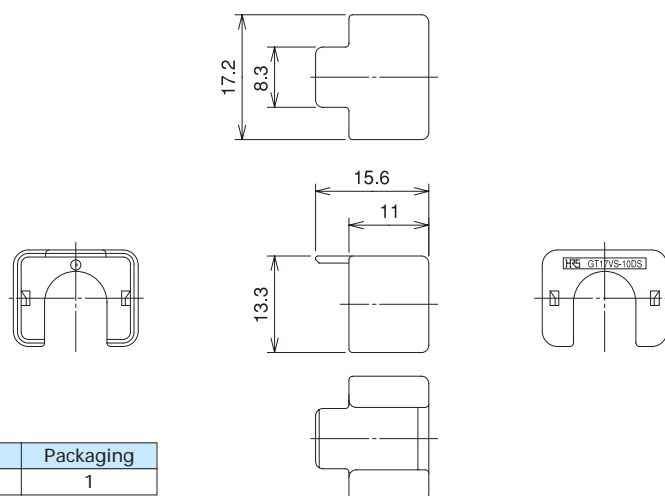

Part Number	CL No.	Material	Color	Packaging
GT17VS-10DS-R	767-0063-6	PBT	Dark gray	1

Note: Applicable Cables will have an outside sheath diameter of 7.5 to 8.0 mm.

## ● Housing (Straight Type)

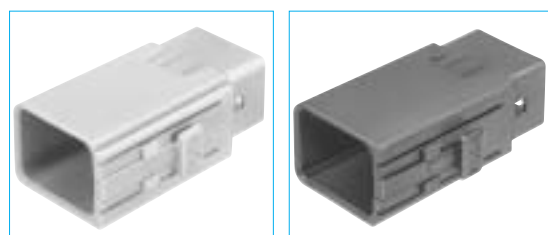

GT17VS-10DS-HU

GT17VSA-10DS-HU

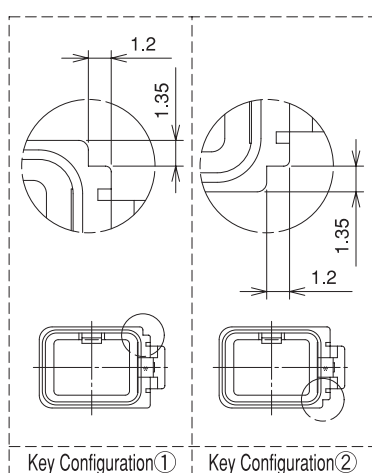

## ◆ Shown with inserted retainer

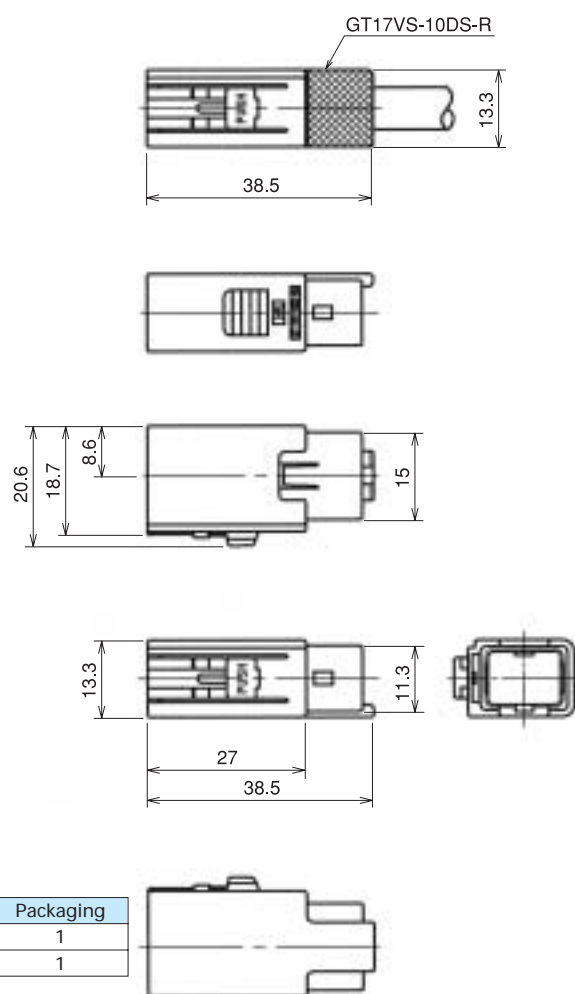

Part Number	CL No.	Material	Color	Key Configurations	Packaging
GT17VS-10DS-HU	767-0061-0	PBT	Light gray	①	1
GT17VSA-10DS-HU	767-0062-3	PBT	Black	②	1

Note 1: Used with the separate retainer (GT17-10DS-R).

Note 2: Applicable Cable will have an outside sheath diameter of 7.5 to 8.0 mm.

## ◆ F Connector (10-Conductor Type) Composition Table

Inner Terminal	Insulator	Outer Terminal	Shield Cover	Housing	Retainer
GT17-2022SCF	GT17V-10DS-2C	GT17V-10DS-8CF	GT17V-10DS-SC	GT17V-10DS-HU	GT17V-10DS-R
GT17-2428SCF		GT17VS-10DS-8CF	GT17VS-10DS-SC	GT17VA-10DS-HU	
GT17-30SCF				GT17VS-10DS-HU GT17VSA-10DS-HU	GT17VS-10DS-R

## ◆ 10-Conductor Type Mating Table

F Connector	M Connector	Color
GT17V-10DS-HU	GT17V-10DP-DS	Light gray
	GT17V-10DP-DSA	
GT17VS-10DS-HU	GT17V-10DP-DS-SB	Black
GT17VA-10DS-HU	GT17VA-10DP-DS	
	GT17VA-10DP-DSA	
GT17VSA-10DS-HU	GT17VA-10P-DS-SB	



## GT17 Series

### M Connectors (10-Conductor Type)

#### ● Printed Circuit Board Type (Right-angle Type)



GT17V-10DP-DS



GT17VA-10DP-DS

#### ◆ Panel Insertion Portion Dimensions

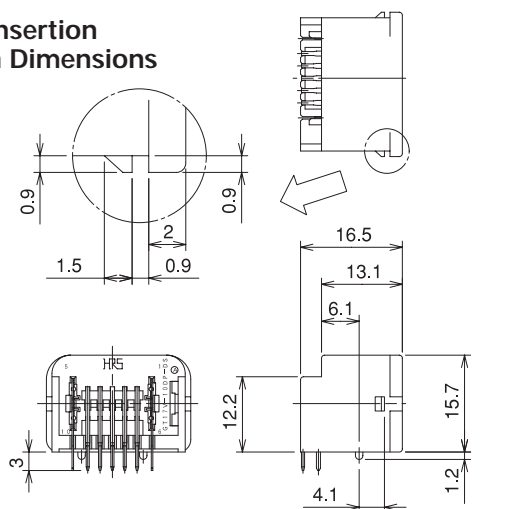

#### ◆ Mounted and fully mated connector assemblies

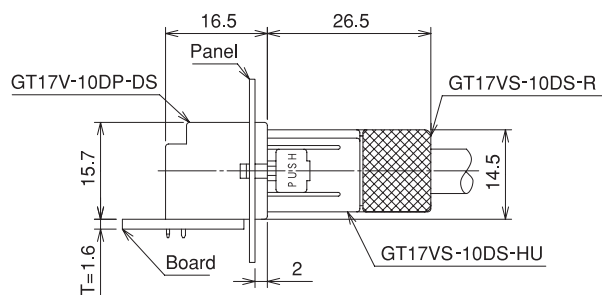

#### ◆ Recommended Panel Cut-out

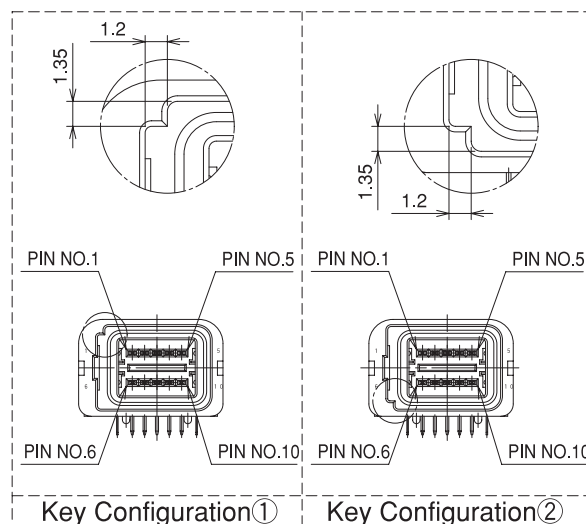
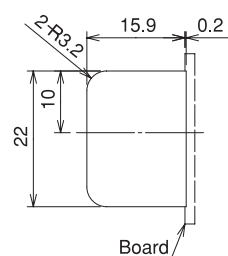

#### ◆ Recommended PCB Mounting Pattern

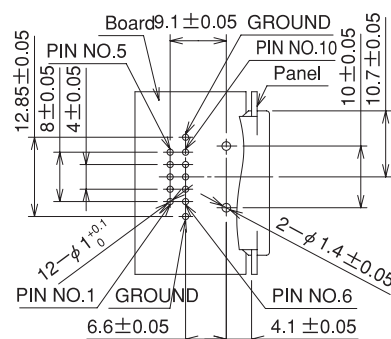

#### ◆ Mounted and fully mated connector assemblies

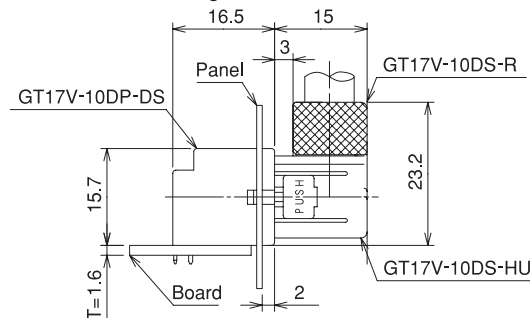

Part Number	HRS No.	Material	Color	Key Configurations	Direction of Cable Pull-off	Packaging
GT17V-10DP-DS	767-0034-8	Brass (Center terminal)	Light gray	①	Upward with respect to the mounting surface	1
GT17VA-10DP-DS	767-0035-0	Copper alloy (Outer terminals)	Black	②		1
GT17V-10DP-DS(70)	767-0034-8-70	PBT (Housing)	Light gray	①		1
GT17VA-10DP-DS(70)	767-0035-0-70		Black	②		1

(70):Pb free products.

## ● Printed Circuit Board Type (Straight Type)

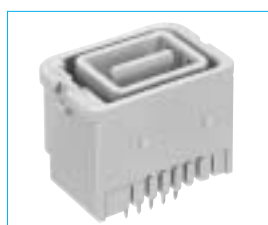

GT17V-10DP-DSA

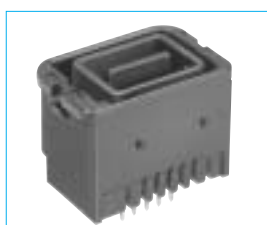

GT17VA-10DP-DSA

### ◆ Panel Insertion Portion Dimensions

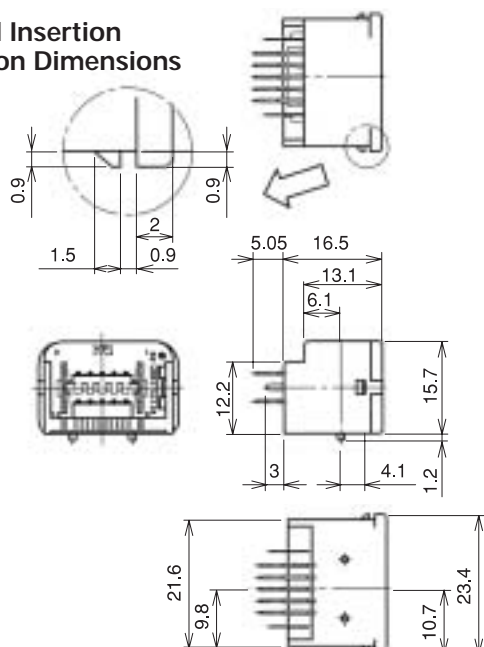

### ◆ Mounted and fully mated connector assemblies

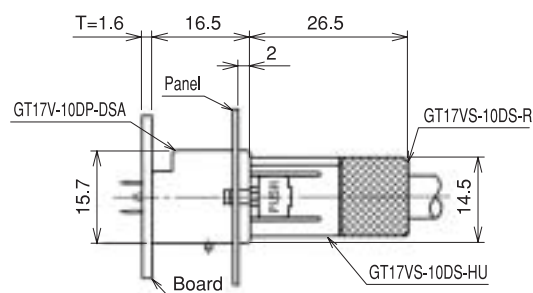

### ◆ Recommended Panel Cut-out

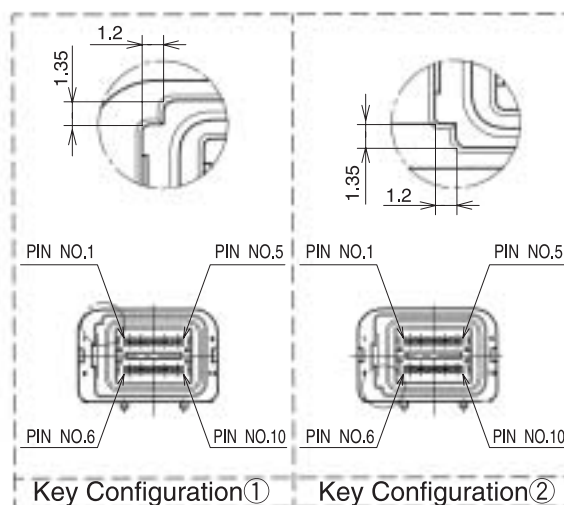
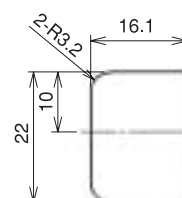

### ◆ Recommended PCB Mounting Pattern

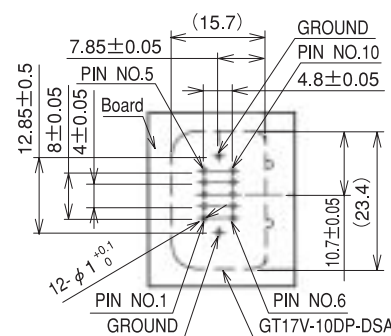

### ◆ Mounted and fully mated connector assemblies

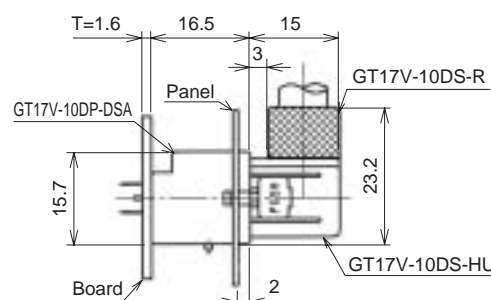

Part Number	HRS No.	Material	Color	Key Configurations	Direction of Cable Pull-off	Packaging
GT17V-10DP-DSA	767-0067-7	Brass (Center terminal)	Light gray	①	Upward with respect to the mounting surface	1
GT17VA-10DP-DSA	767-0068-0	Copper alloy (Outer terminals)	Black	②		1
GT17V-10DP-DSA(70)	767-0067-7-70	PBT (Housing)	Light gray	①		1
GT17VA-10DP-DSA(70)	767-0068-0-70		Black	②		1

(70):Pb free products.

## GT17 Series

### ● Printed Circuit Board Type (Shield Reinforced Type)

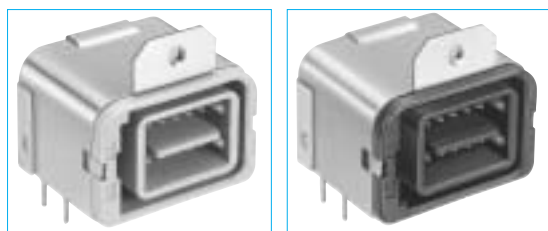

GT17V-10DP-DS-SB GT17VA-10DP-DS-SB

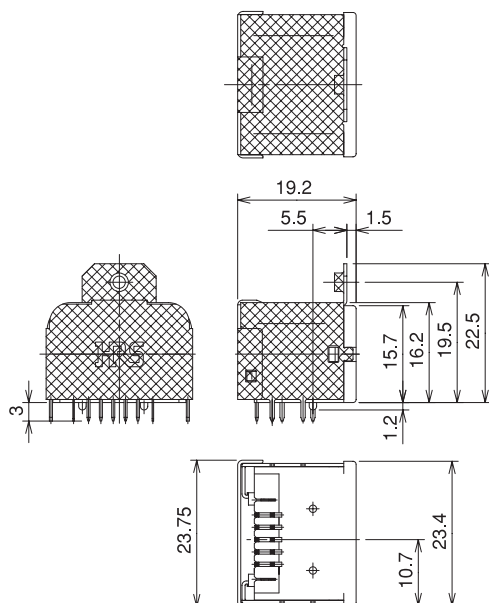

### ◆ Mounted and fully mated connector assemblies

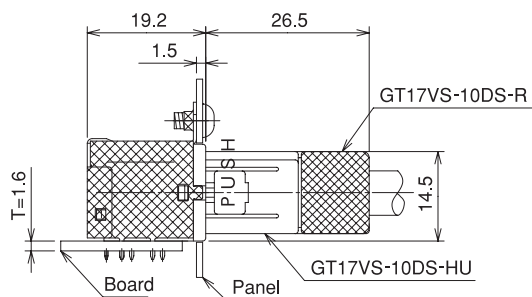

### ◆ Mounted and fully mated connector assemblies

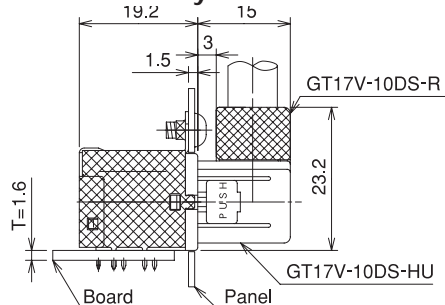

### ◆ Recommended Panel Cut-out

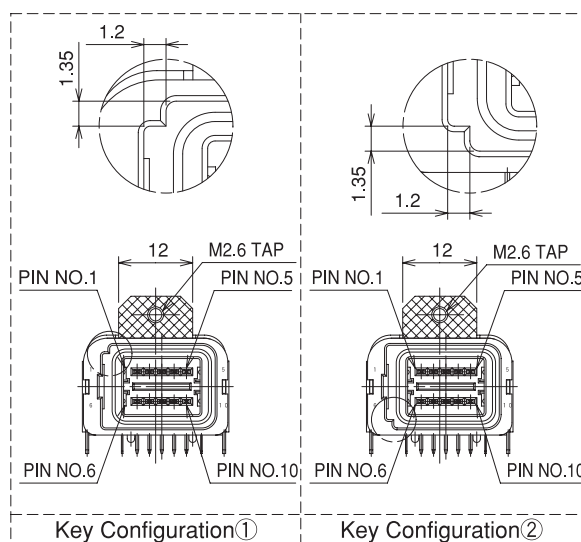
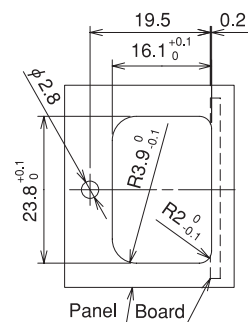

### ◆ Recommended PCB Mounting Pattern

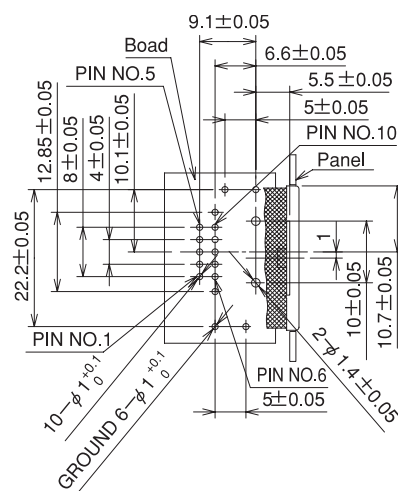

Part Number	HRS No.	Material	Color	Key Configurations	Direction of Cable Pull-off	Packaging
GT17V-10DP-DS-SB	767-0069-2	Brass (Center terminal)	Light gray	①	Upward with respect to the mounting surface	1
GT17VA-10DP-DS-SB	767-0070-1	Copper alloy (Outer terminals)	Black	②		1
GT17V-10DP-DS-SB(70)	767-0069-2-70	Brass (Shield)	Light gray	①		1
GT17VA-10DP-DS-SB(70)	767-0070-1-70		Black	②		1

(70):Pb free products.

## ◆ Wiring Method

### ① Strip the outside sheath.

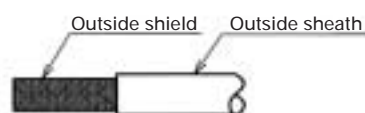

### ② Cut the shield and intermediate material to expose the wire and braid.

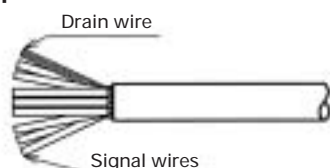

### ③ Bend back the drain wire over the sheath.

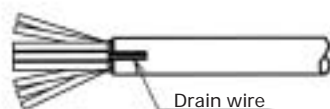

### ④ Wrap with copper tape.

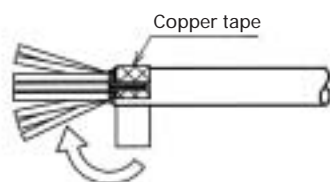

### ⑤ Strip the wire leads.

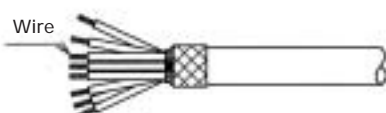

### ⑥ Crimp the center terminals.

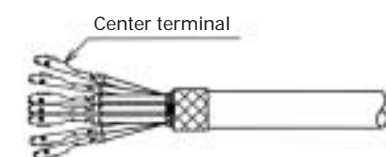

### ⑦ Insert the center terminals into the insulator.



### GT17V-10DS-HU Harness Finish

### ⑧ Insert the insulator into the Outer terminal.

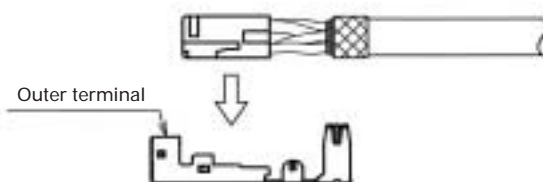

### ⑨ Insert the Shield Cover.



### ⑩ Fold back the Outer terminal.



### ⑪ Crimp the Outer terminal.



### ⑫ Insert the Outer terminal into the housing.



### ⑬ Insert the retainer.

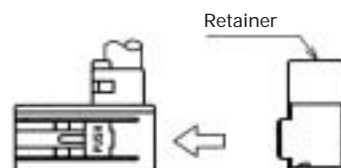

### ⑭ Completion



## GT17 Series

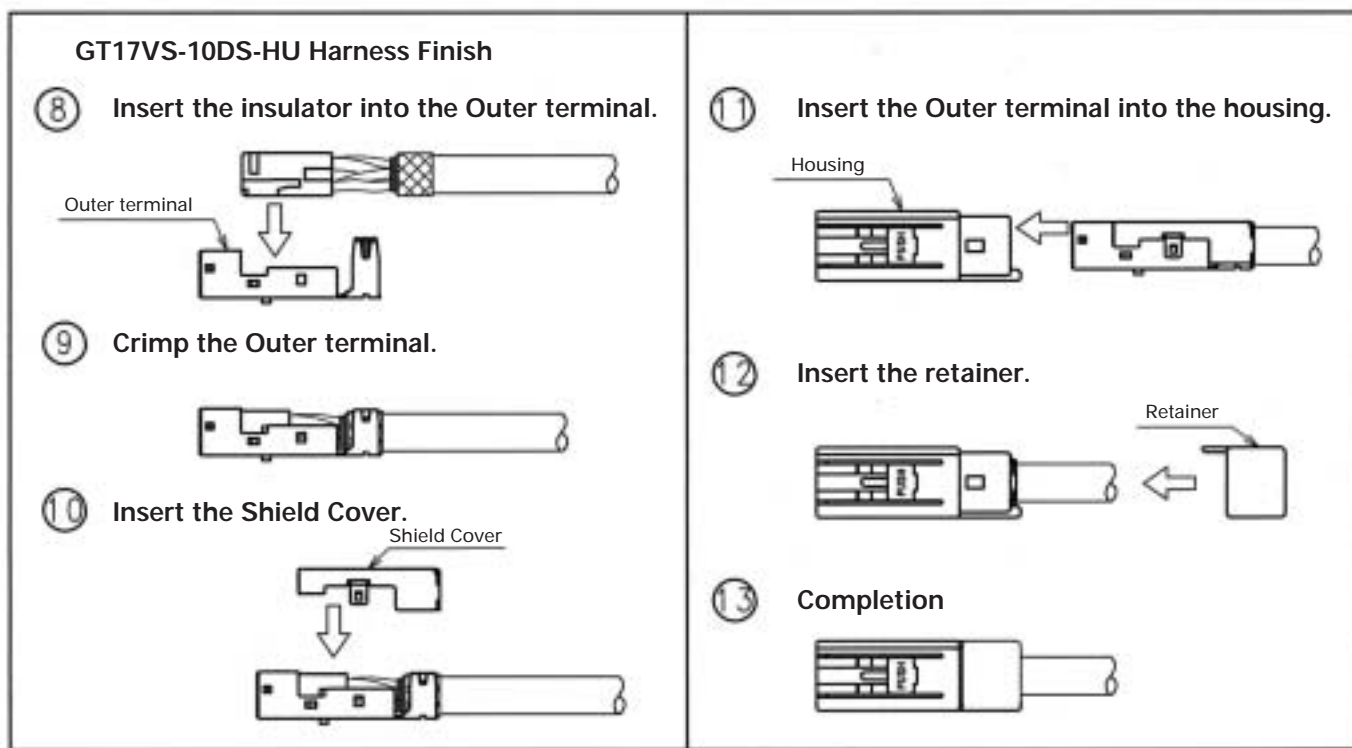

## Termination Tools

User's manuals are available. Please ask your Hirose Electric account representative.

## Automatic Crimping Machine



Part Number CM-105

## Hand Press



## Specifications

Item	Specification	Remarks
Specification	1.5ton	
Stroke Length	30mm	
Number of strokes	200spm (50Hz)	240spm (60Hz)
Weight	75kg	
Motor	0.2kW	AC100V
Crimping speed	2000 to 4000 pcs. per day	

\* Crimp height setting tables are available for each cable type. Please contact your nearest Hirose Electric account representative.  
 Different cables will require different crimp height settings.

# AMEYA360

Components Supply Platform

Authorized Distribution Brand :



Website :

Welcome to visit [www.ameya360.com](http://www.ameya360.com)

Contact Us :

➤ Address :

401 Building No.5, JiuGe Business Center, Lane 2301, Yishan Rd  
Minhang District, Shanghai , China

➤ Sales :

Direct    +86 (21) 6401-6692  
Email     amall@ameya360.com  
QQ        800077892  
Skype     ameyasales1 ameyasales2

➤ Customer Service :

Email     service@ameya360.com

➤ Partnership :

Tel        +86 (21) 64016692-8333  
Email     mkt@ameya360.com