

# BATTERY CONTACTS

Designers' Choice



## "A" • "AA" • "AAA" • "N" SIZE PC BUTTON & SPRING CONTACTS



- Ideal contacts for "A" • "AA" • "AAA" • "N" size batteries.
- Space saving design installs directly onto the PC board
- Ideal for self-contained battery compartments
- Contacts available for .062 and .093 thick PC boards
- Reliable spring and/or button assures low contact resistance



**MATERIAL:** Frame: .015 Steel, Tin Plate

**MATERIAL:** Frame: .015 Steel, Tin Plate  
Uses Cat. No. 211 Spring Contact

### (+) Positive Button

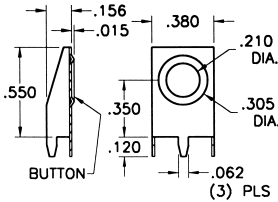

Mounting Detail

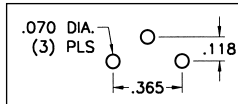

**CAT. NO. 595** - For "A"

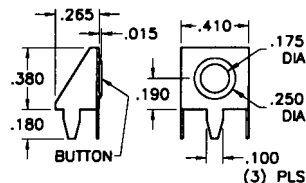

Mounting Detail

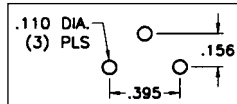

**CAT. NO. 637** - For "AA" • "AAA" • "N"

### (-) Negative Spring

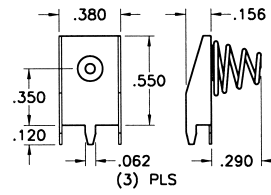

Mounting Detail

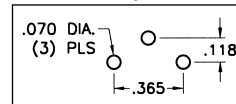

**CAT. NO. 628** - For "A"

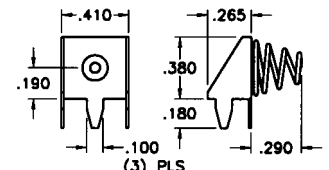

Mounting Detail

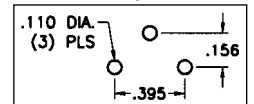

**CAT. NO. 629** - For "AA" • "AAA" • "N"

## SURFACE MOUNT BATTERY CONTACTS

### For "AAA" • "AAAA"

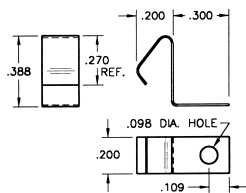

**CAT. NO. 5230**  
**CAT. NO. 5230TR**

**Tape and Reel Spec's:** 24mm wide; 12mm pitch;  
13 inch reel (400 pieces per reel)



### For "A" • "AA" • "9V"

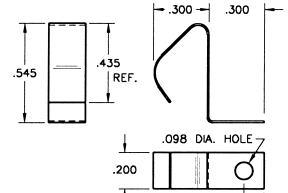

**CAT. NO. 5231**  
**CAT. NO. 5231TR**

**Tape and Reel Spec's:** 32mm wide; 12mm pitch;  
13 inch reel (400 pieces per reel)



- Economical & reliable contacts are ideal for surface mount applications
- Unique spring tension contacts adjust to variations in battery length
- Reliable spring tension contacts assure low contact resistance
- SMT solder tail with "flow-hole" design for increased joint strength

**MATERIAL:** .010 Spring Steel, Nickel Plate

## PC BATTERY CONTACTS

• ECONOMICAL • SPACE SAVING

- Ideal for self-contained battery compartments
- Contact us for modifications and custom design

Mounting Detail

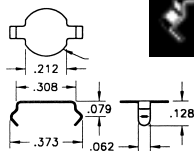

**CAT. NO. 2990** .008 Thick, Phosphor Bronze, Nickel Plate

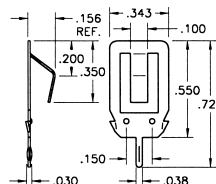

**CAT. NO. 108-2** .012 Thick, Spring Steel, Nickel Plate

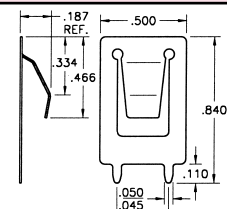

**CAT. NO. 109-2** .012 Thick, Spring Steel, Nickel Plate

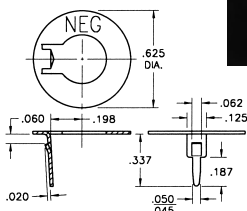

**CAT. NO. 105-3** .020 Thick, Spring Steel, Nickel Plate

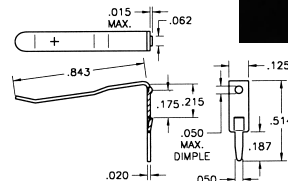

**CAT. NO. 105-2** .020 Thick, Spring Steel, Nickel Plate

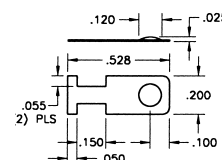

**CAT. NO. 230-1** .008 Thick, Spring Steel, Nickel Plate



# AMEYA360

Components Supply Platform

Authorized Distribution Brand :



Website :

Welcome to visit [www.ameya360.com](http://www.ameya360.com)

Contact Us :

➤ Address :

401 Building No.5, JiuGe Business Center, Lane 2301, Yishan Rd  
Minhang District, Shanghai , China

➤ Sales :

Direct     +86 (21) 6401-6692  
  
Email        amall@ameya360.com  
  
QQ           800077892  
  
Skype        ameyasales1 ameyasales2

➤ Customer Service :

Email        service@ameya360.com

➤ Partnership :

Tel           +86 (21) 64016692-8333  
  
Email        mkt@ameya360.com