



Features

- Magnetically operated position sensor
- Matching actuator available
- Compact size requires only 3.2cm² board space
- Screw down or adhesive mounting
- Customer defined sensitivity
- Choice of cable length
- Leads can exit from LH or RH side

Benefits

- No standby power requirement
- Operates through non-ferrous materials such as wood, plastic or aluminium
- Hermetically sealed, magnetically operated contacts continue to operate long after optical and other technologies fail due to contamination

Applications

- Position and limit sensing
- Security system switch
- Linear actuators
- Door switch

DIMENSIONS (in) mm

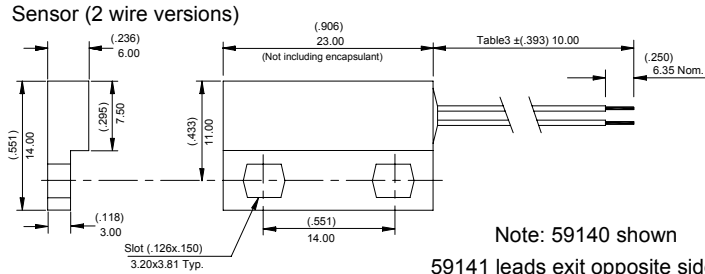
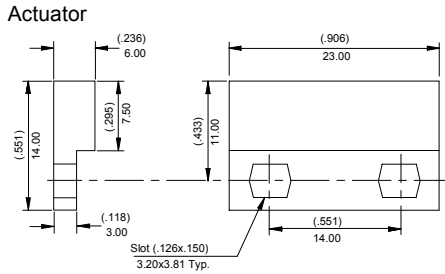

Note: 59140 shown
59141 leads exit opposite side

SCHEMATICS

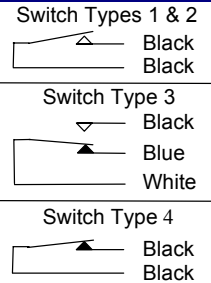

CUSTOMER OPTIONS - Switching Specifications

| TABLE 1 Switch Type | | Select Option | 1 | 2 | 3 | 4 |
|---------------------|------------------|---------------|------------------|-----------------------|-----------------|-----------------|
| | | Contact Type | Normally Open | Normally Open High V. | Change Over | Normally Closed |
| Contact Rating | Power | Watts - max | 10 | 10 | 5 | 5 |
| Voltage | Switching | Vdc - max. | 200 | 300 | 175 | 175 |
| | Breakdown | Vdc - min. | 250 | 450 | 200 | 200 |
| Current | Switching | A - max. | 0.5 | 0.5 | 0.25 | 0.25 |
| | Carry | A - max. | 1.2 | 1.5 | 1.5 | 1.5 |
| Resistance | Contact, Initial | Ohms - max. | 0.2 | 0.2 | 0.2 | 0.2 |
| | Insulation | Ohms - min. | 10 ¹⁰ | 10 ¹⁰ | 10 ⁹ | 10 ⁹ |
| Temperature | Operating | °C | -40 to +105 | -20 to +105 | -40 to +105 | -40 to +105 |
| | Storage | °C | -65 to + 105 | -65 to +105 | -65 to +105 | -65 to +105 |
| Time | Operate | ms - max. | 1.0 | 1.0 | 3.0 | 3.0 |
| | Release | ms - max. | 1.0 | 1.0 | 3.0 | 3.0 |
| Capacitance | Contact | pF - typ. | 0.3 | 0.2 | 0.3 | 0.3 |
| Shock | 11ms ½ sine | G - max. | 100 | 100 | 50 | 50 |
| Vibration | 50-2000 Hz. | G - max. | 30 | 30 | 30 | 30 |

CUSTOMER OPTIONS - Sensitivity, Cable Length and Termination Specifications

| TABLE 2 Sensitivity | | TABLE 3 Cable Length | | TABLE 4 Termination (2 wire versions shown) | | |
|--|------------------|--|------------------|---|------------------|------------------------------|
| Activate distances (d) are approximate using Hamlin 57140-000 actuator as illustrated. | | (Cable 24AWG 7/32 PVC 105°C UL1430 / UL1569) | | Select Option Description Diagram | | |
| Switch AT before modification | | Select Option Length(in)mm | | A or F Tinned or untinned | | |
| | | 02 (11,81) 300 05 (39,37)1,000 | | | | |
| Select Option | S | T | U | V | | |
| Switch Type | Pull-In AT Range | Activate Distance (d) (in)mm | Pull-In AT Range | Activate Distance (d) (in)mm | Pull-In AT Range | Activate Distance (d) (in)mm |
| 1 | 12-18 | (.453) | 17-23 | (.374) | 22-28 | (.315) |
| 2 | 11.5 | 17-23 | 9.5 | 22-28 | 8.0 | 27-33 |
| 3 | 15-20 | (.413) | 20-25 | (.354) | 25-30 | (.295) |
| 4 | 10.5 | 20-25 | 9.0 | 25-30 | 7.5 | |

ORDERING INFORMATION

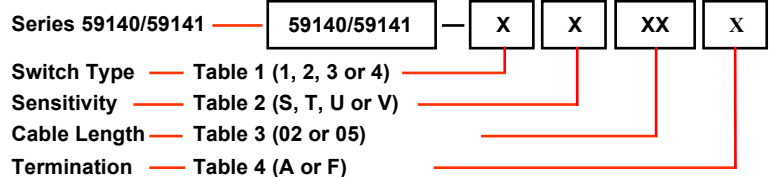

AMEYA360

Components Supply Platform

Authorized Distribution Brand :



Website :

Welcome to visit www.ameya360.com

Contact Us :

➤ Address :

401 Building No.5, JiuGe Business Center, Lane 2301, Yishan Rd
Minhang District, Shanghai , China

➤ Sales :

Direct +86 (21) 6401-6692

Email amall@ameya360.com

QQ 800077892

Skype [ameyasales1](#) [ameyasales2](#)

➤ Customer Service :

Email service@ameya360.com

➤ Partnership :

Tel +86 (21) 64016692-8333

Email mkt@ameya360.com