

## SPECIFICATION

Part No. : **GP.1575.25.4.A.02**

Product Name : **4mm thick GPS Patch Antenna**

Features : 25mm\*25mm\*4mm  
Halogen Free  
ROHS Compliant

:



# 1. Introduction

This miniaturized ceramic GPS patch antenna is based on smart **XtremeGain™** technology. It is mounted via pin and double-sided adhesive and has been tuned as optimal solution for the customer device environment.

# 2. Specification Table

Original Patch Specification tested on 50\*50mm ground plane

No	Parameter	Specification
1	Range of Receiving Frequency	1575.42MHz +/- 1.023MHz
	Center Frequency	1575MHz +/- 3MHz
2	Impedance	50Ω
3	Bandwidth	10 MHz min Return Loss <-10dB
4	VSWR	1.2:1
5	Gain toward Zenith	1.55 dBic typ.
6	Gain at 10°Elevation	-2.5 dBic typ.
7	Axial Ratio	3dB Max.
8	Polarization	Right Hand Circular Polarization
9	Frequency Temperature Coefficient ( Tf )	0 ± 20ppm/°C
	Operating Temperature	-40°C to +85°C

### 3. Electrical Specification

#### 3.1 Return Loss

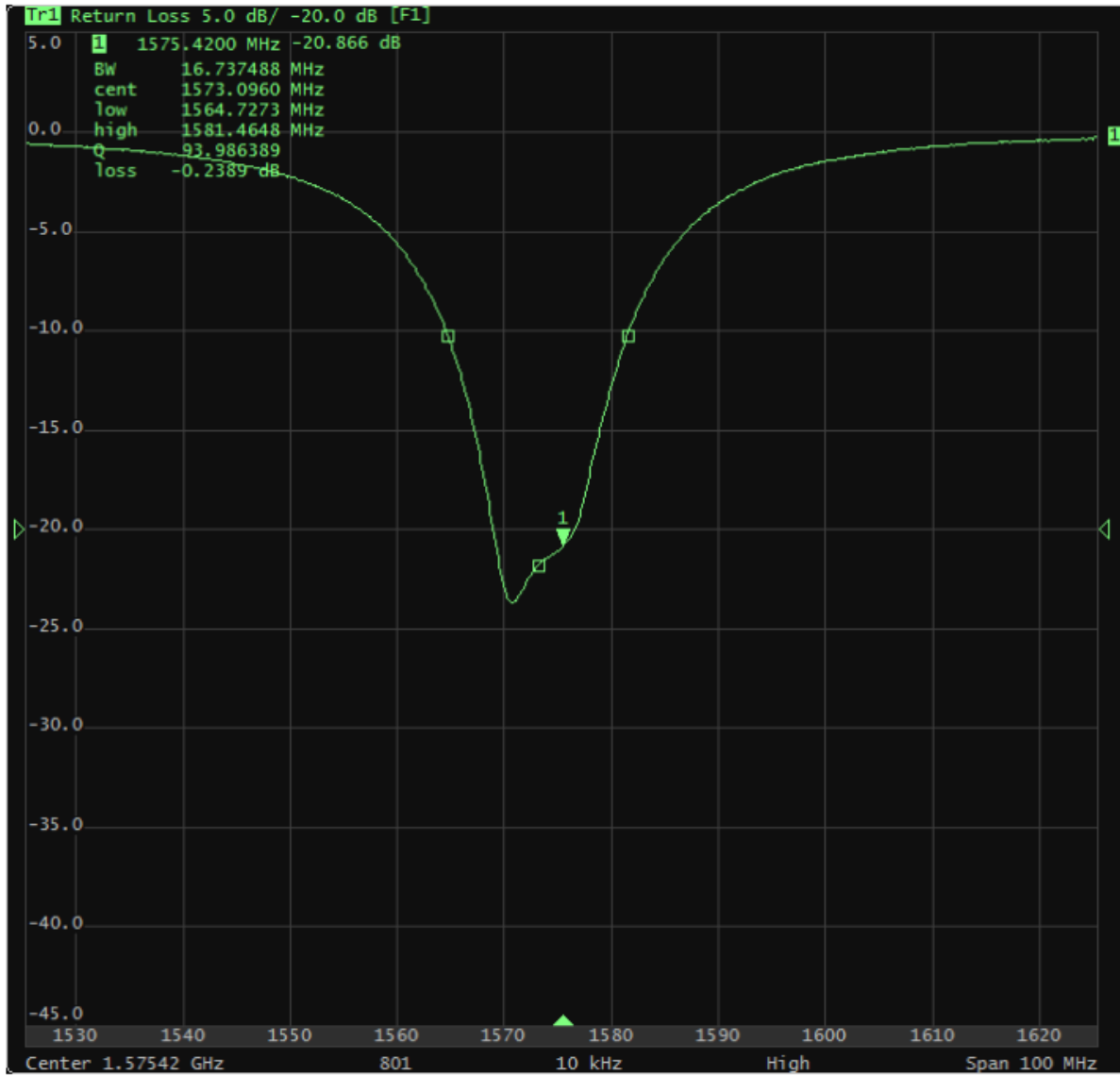

### 3.2 Smith Chart

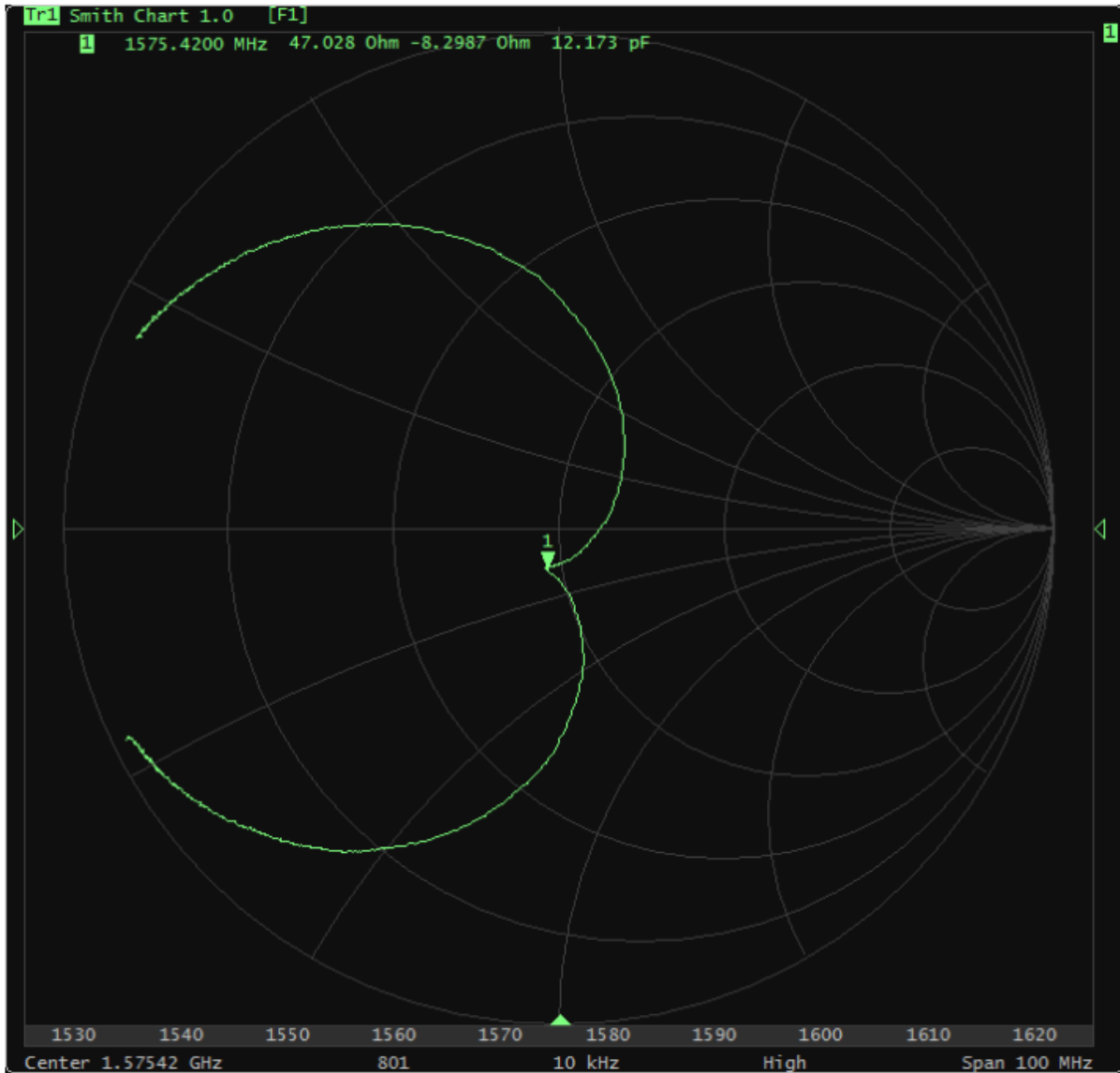

### 3.3VSWR

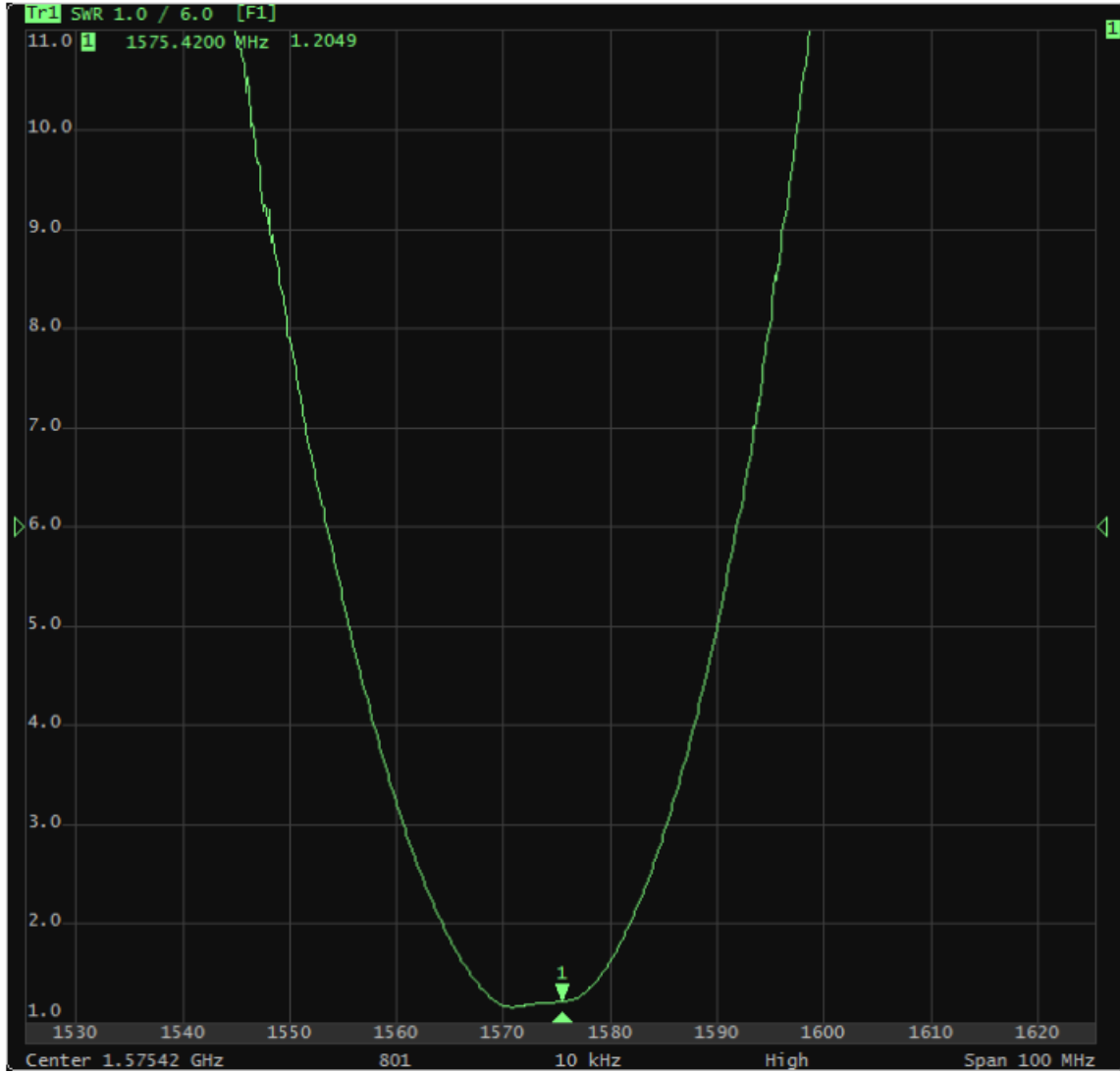

### 4. 2D Radiation Patterns

XZ-Plane

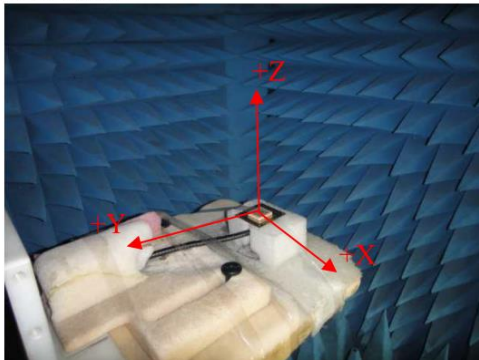

YZ-Plane

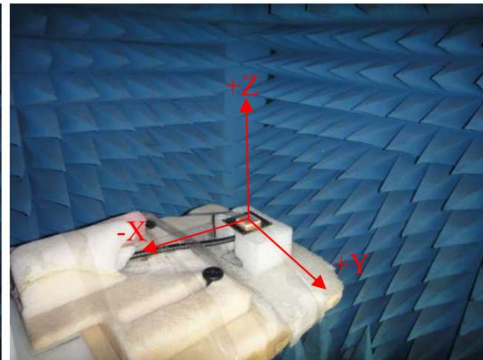

## 4.1 XZ Patterns

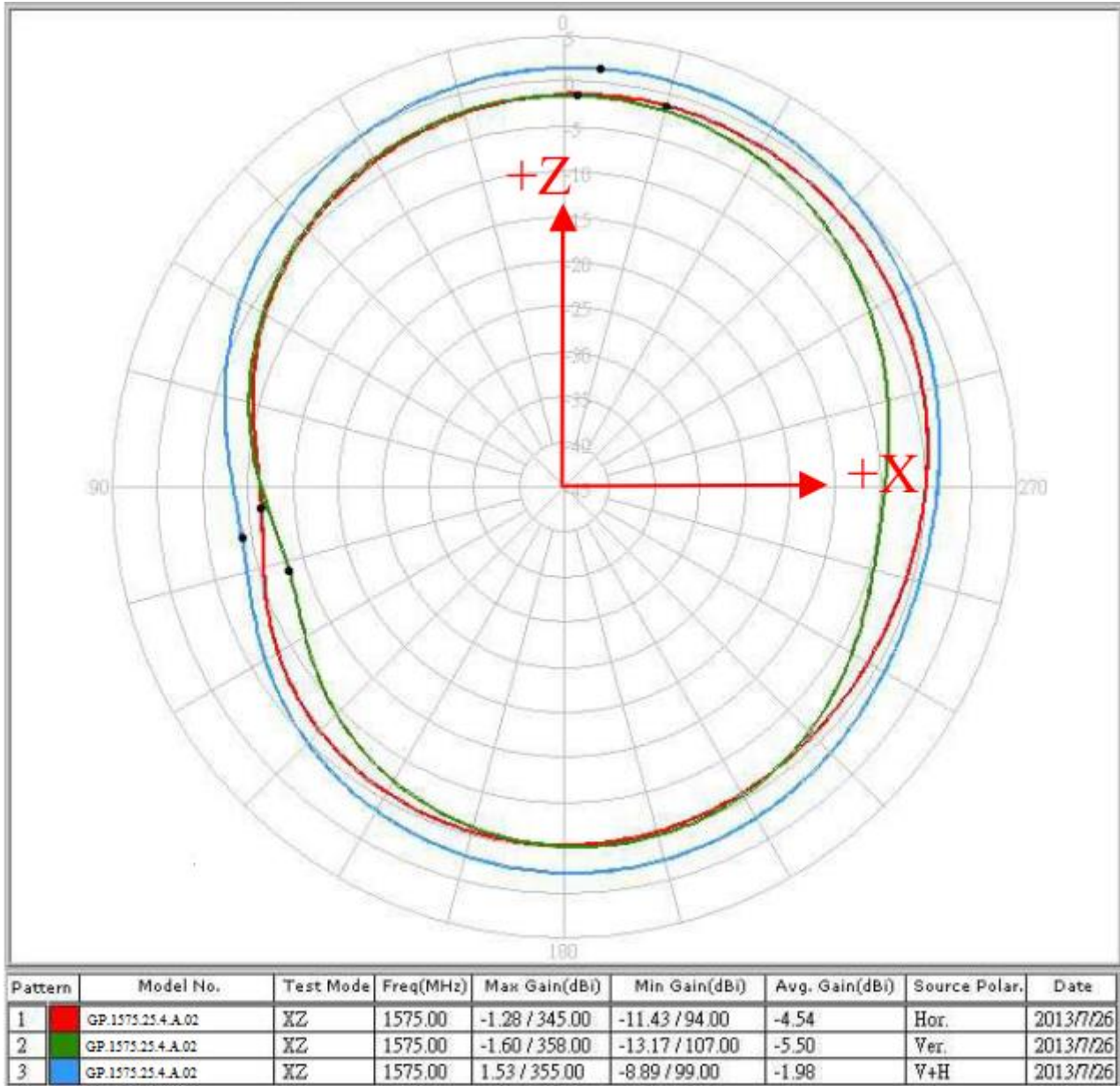

## 4.2 YZ Patterns

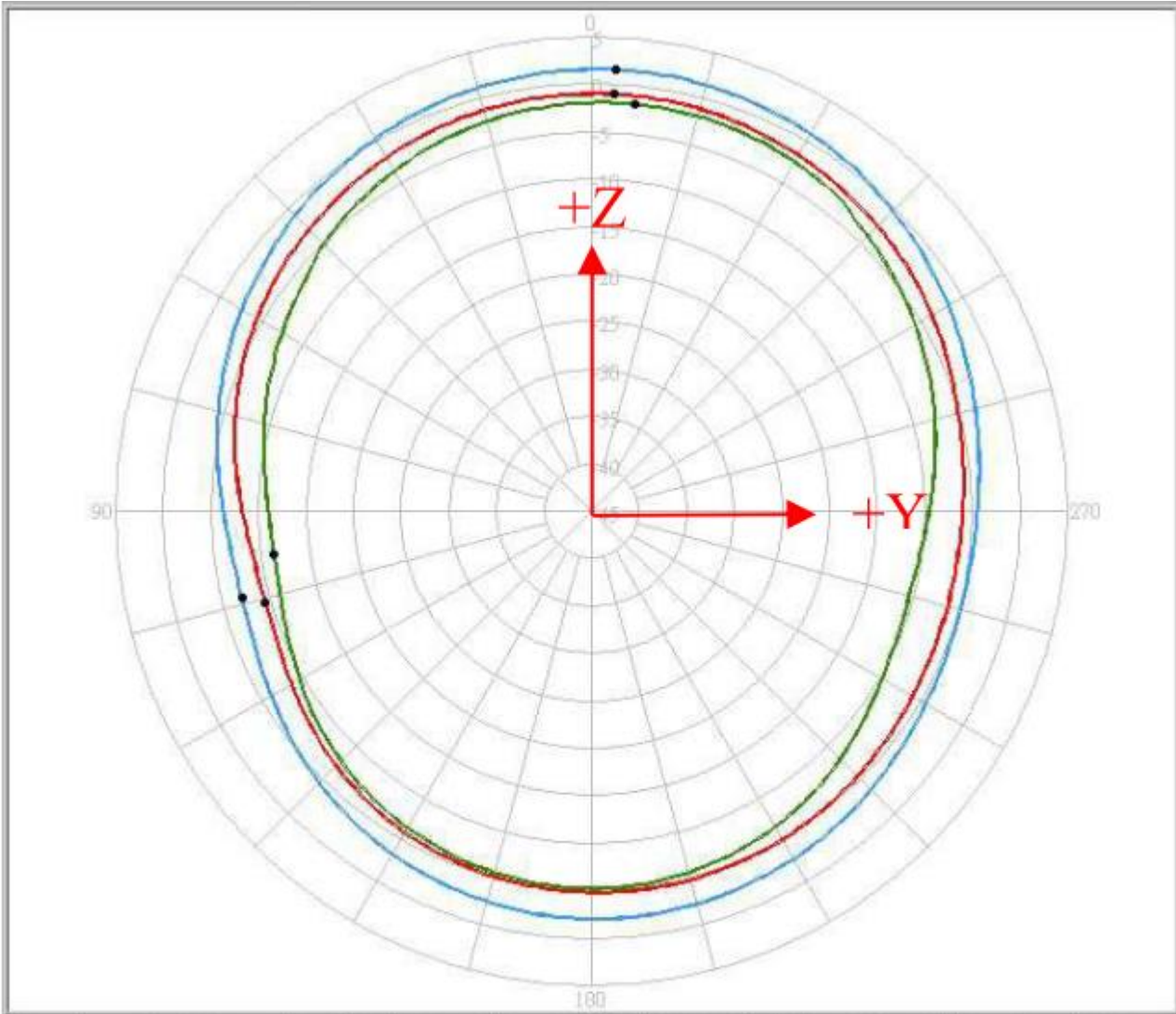

Pattern	Model No.	Test Mode	Freq(MHz)	Max Gain(dBi)	Min Gain(dBi)	Avg. Gain(dBi)	Source Polar.	Date
1	GP.1575.25.4.A.02	YZ	1575.00	-1.00 / 356.97	-9.42 / 105.88	-4.18	Hor.	2013/7/26
2	GP.1575.25.4.A.02	YZ	1575.00	-1.88 / 353.83	-11.35 / 97.71	-5.68	Ver.	2013/7/26
3	GP.1575.25.4.A.02	YZ	1575.00	1.59 / 356.91	-7.16 / 103.89	-1.87	Y+H	2013/7/26



## 5. Gain Pattern Value

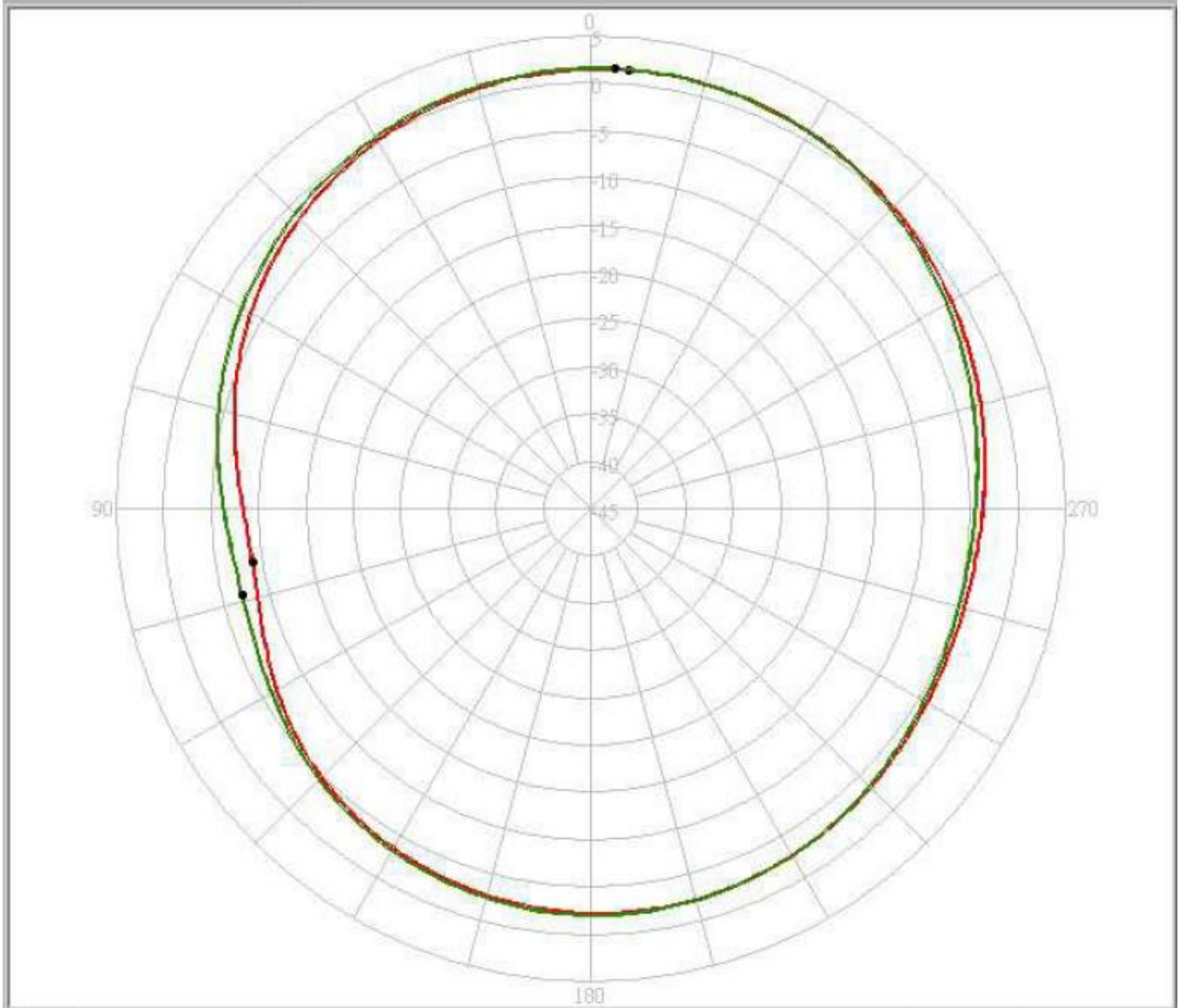

Pattern	Model No.	Test Mode	Freq(MHz)	Max Gain(dBi)	Min Gain(dBi)	Avg. Gain(dBi)	Source Polar.	Date
1	GP.1575.25.4.A.02	XZ	1575.00	1.53 / 355.00	-8.89 / 99.00	-1.98	V+H	2013/7/26
2	GP.1575.25.4.A.02	YZ	1575.00	1.59 / 356.91	-7.16 / 103.89	-1.87	V+H	2013/7/26



Angle	XZ-Plane	YZ-Plane
90°	-8.37	-6.59
75°	-6.12	-4.70
60°	-3.66	-2.80
45°	-1.65	-1.05
30°	-0.11	0.26
15°	0.94	1.14
0°	1.45	1.55
345°	1.46	0.00
330°	0.99	0.00
315°	0.11	0.57
300°	-1.10	-0.82
285°	-2.45	-2.45
270°	-3.69	-3.94

(Unit : dBi)

## 6. Axial Ratio Pattern

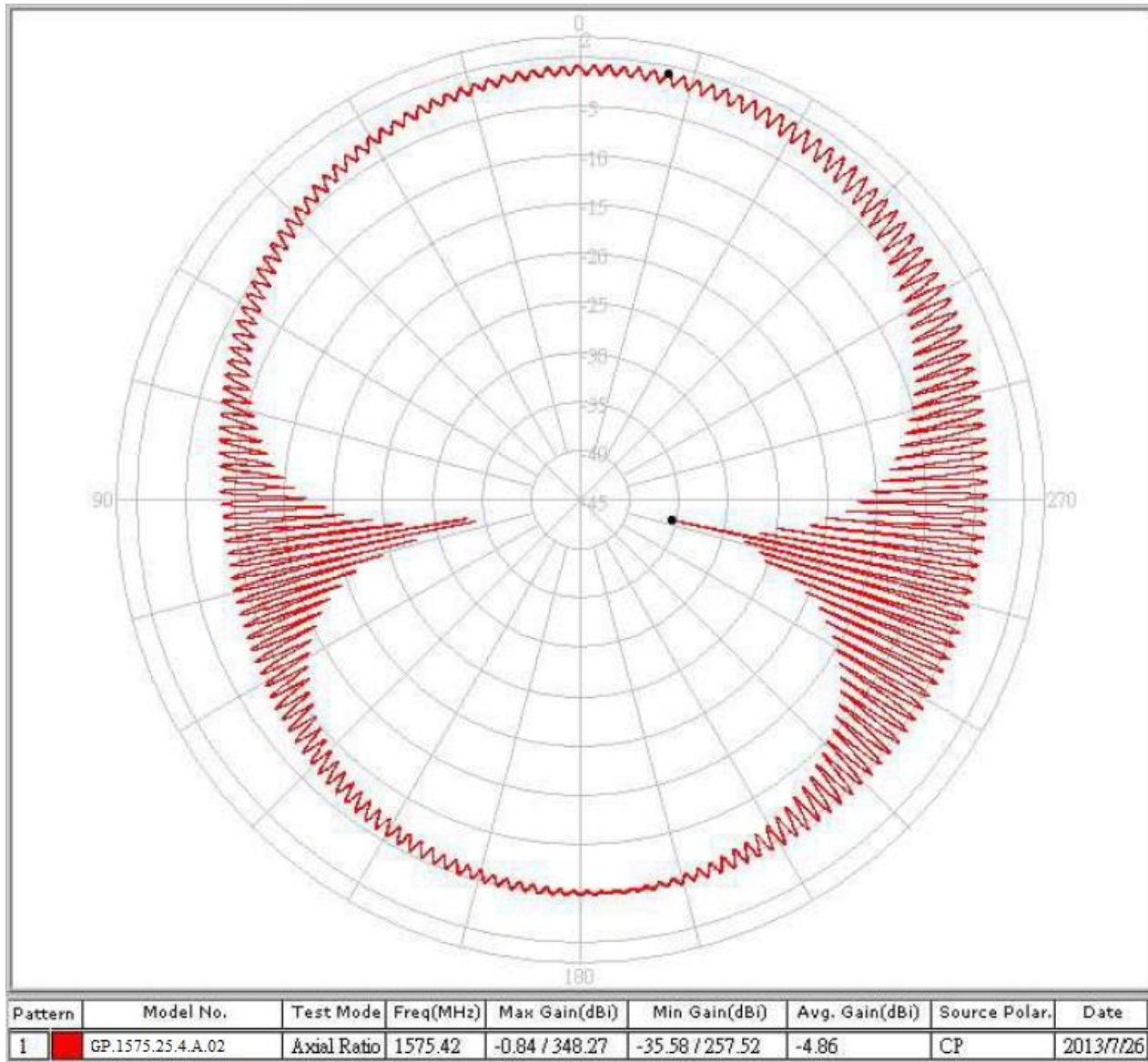

Angle	Axial Ratio
90°	10.17
75°	3.27
60°	2.03
45°	1.51
30°	1.14
15°	0.87
0°	0.83
345°	1.14
330°	1.88
315°	2.94
300°	4.58
285°	6.86
270°	12.88

( At 1575.42MHz )

## 7. 2D Mechanical Drawing

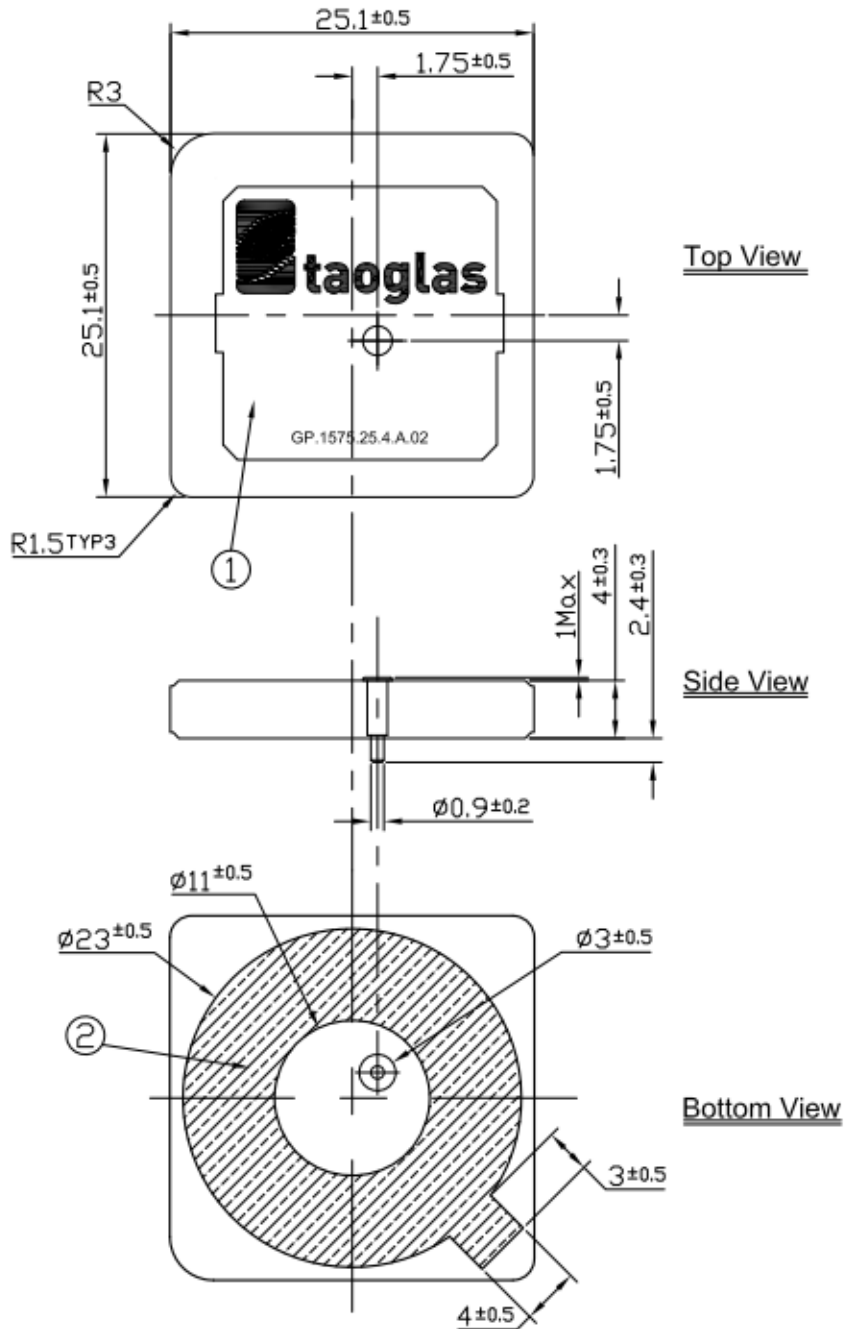

**NOTES:**

1. Double sided adhesive area 

	Name	Material	Finish	QTY
1	GP.1575 Patch 25x25x4	Ceramic	Clear	1
2	Double sided Adhesive	NITTO 5015	White Liner	1

### 5.1 Layout Dimension

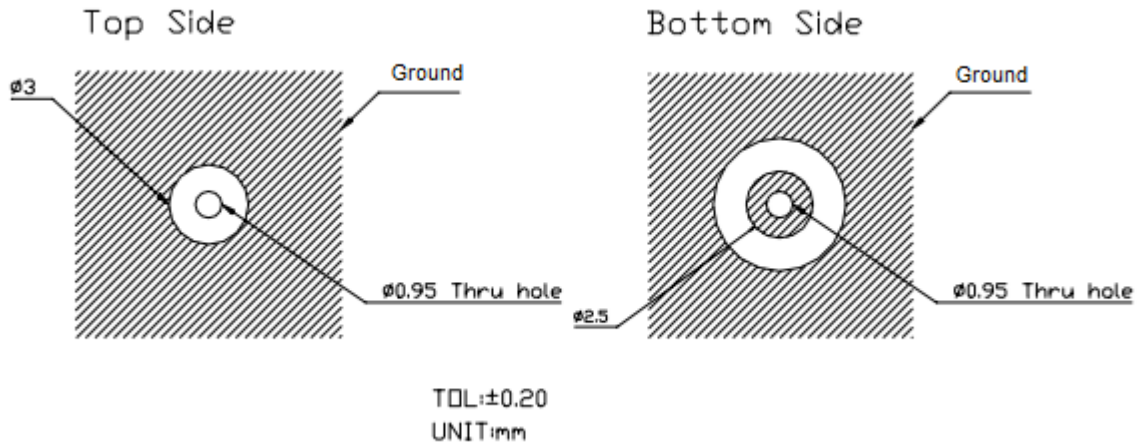

\*Note Layout Dimensions may be affected by the thickness of the PCB

### 8. Test Jig and Dimension

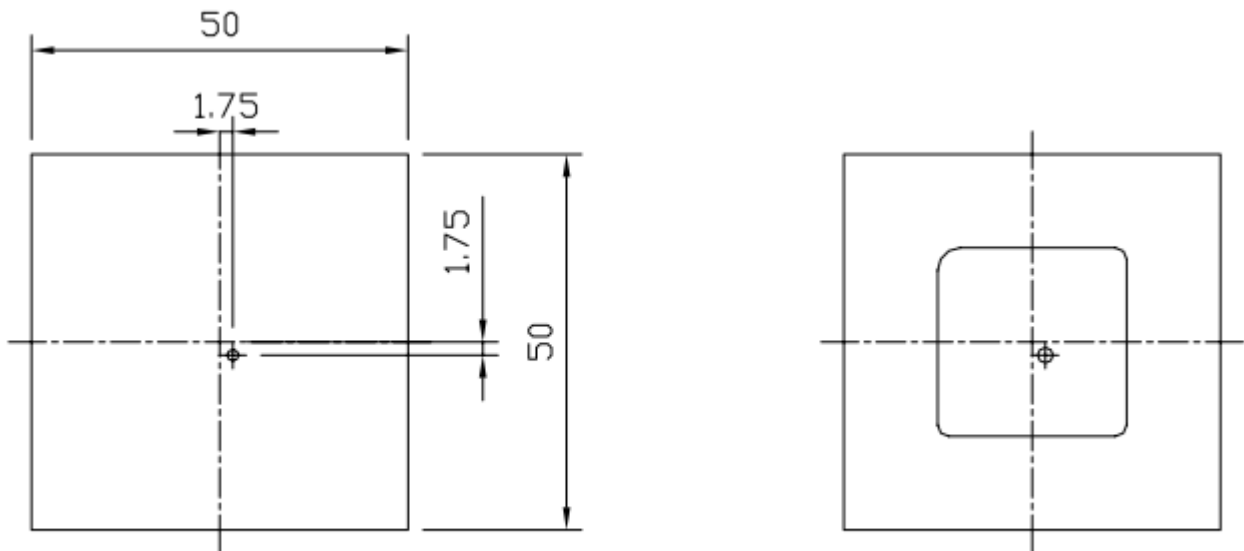

## 8.1 Test Fixture Antenna Setup and Measurements

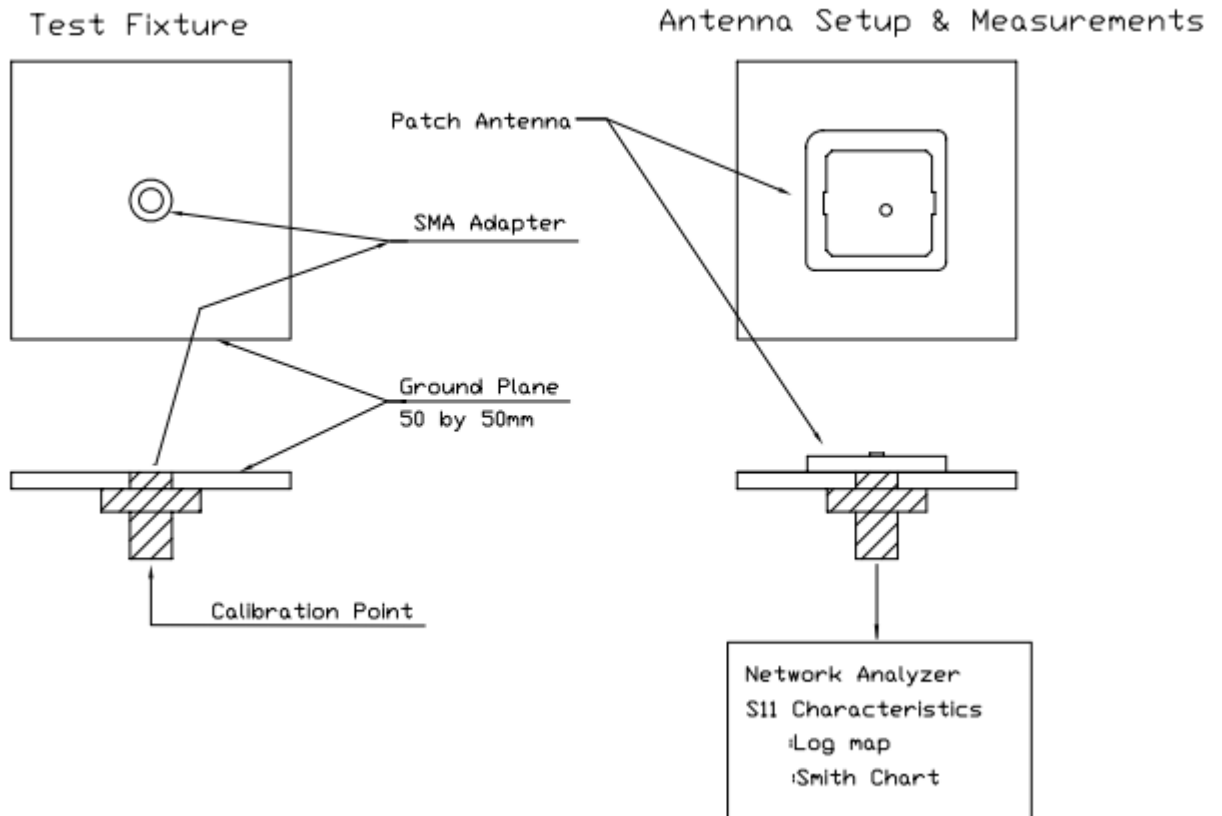

## 9. Packaging

50 pieces per Tray

200 per Inner Carton

4 x 200 – 800 pieces per Outer Carton

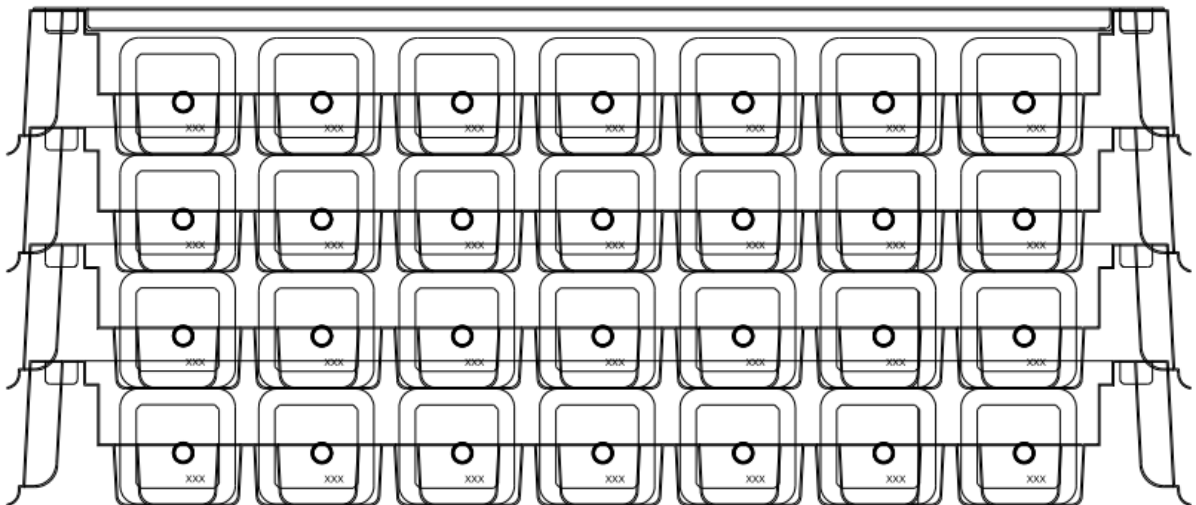
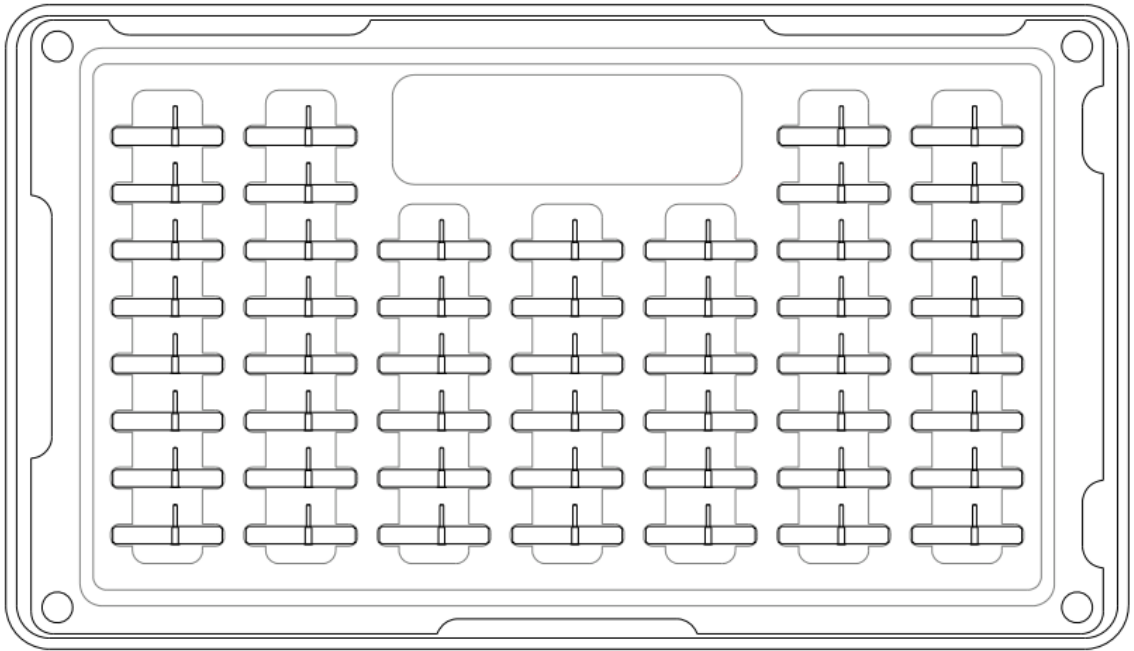



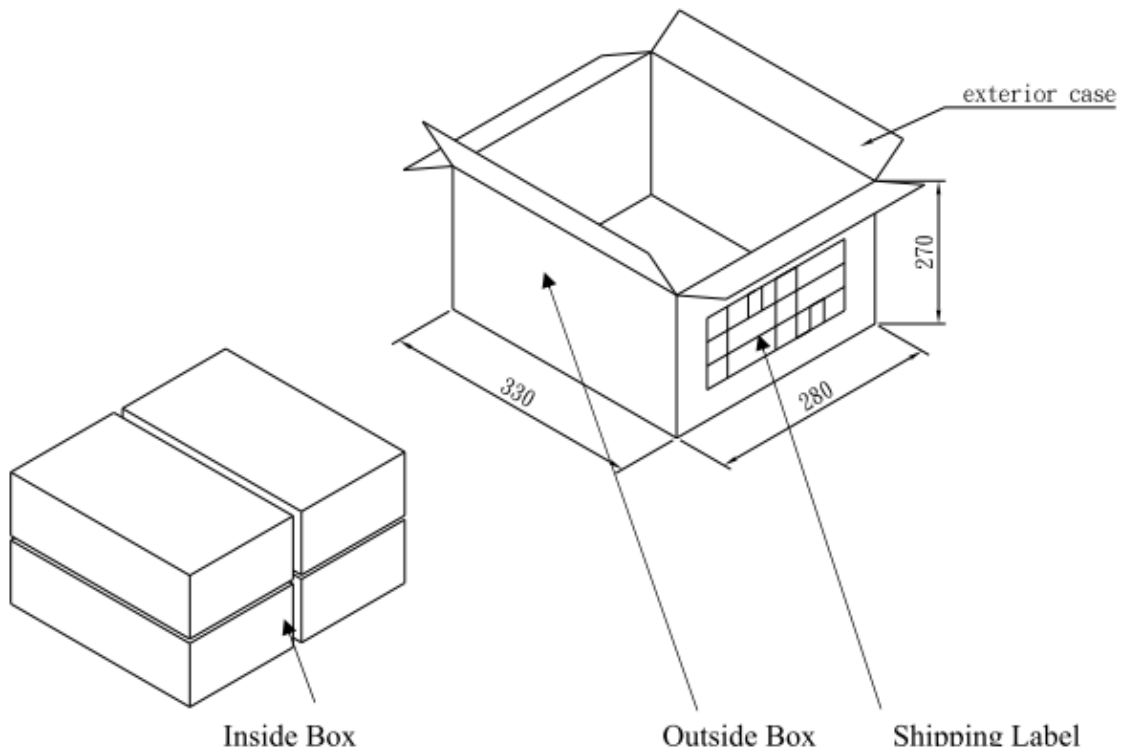
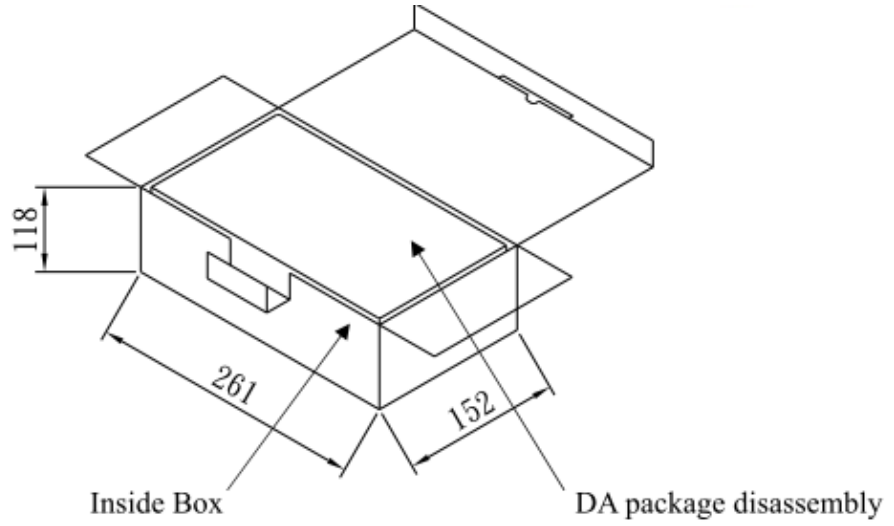

# AMEYA360

## Components Supply Platform

### Authorized Distribution Brand :



### Website :

Welcome to visit [www.ameya360.com](http://www.ameya360.com)

### Contact Us :

#### ➤ Address :

401 Building No.5, JiuGe Business Center, Lane 2301, Yishan Rd  
Minhang District, Shanghai , China

#### ➤ Sales :

Direct +86 (21) 6401-6692

Email [amall@ameya360.com](mailto:amall@ameya360.com)

QQ 800077892

Skype [ameyasales1](#) [ameyasales2](#)

#### ➤ Customer Service :

Email [service@ameya360.com](mailto:service@ameya360.com)

#### ➤ Partnership :

Tel +86 (21) 64016692-8333

Email [mkt@ameya360.com](mailto:mkt@ameya360.com)