

## Features

### LED Driver

- 6W AC-DC Class II LED Power Supply
- 350mA to 700mA CC/CV Output
- ENEC, UL, RCM and CB Certified
- Universal Input Voltage Range
- Fused Input, Protected Output
- 3.75kVAC Isolation
- Low Cost
- 3 Year Warranty

### Description

A compact universal input 6W constant current switching power module suitable for driving up to 12 high power LEDs. The output (dual constant voltage / constant current mode) current limit is fixed at 350mA, 500mA or 700mA. At lower output currents, the output is constant voltage.

### Selection Guide

Part Number	Nominal Input Voltage (VAC)	Input Current at full load (mA)	Output Voltage Range (VDC)	Output Current (mA)	Max # LEDs	Efficiency typ. (%)
RACD06-350	universal	120	2.5-24	350	6 x 1W	79
RACD06-500	universal	120	2.5-15	500	12 x 0.5W	70
RACD06-700	universal	120	2.5-12	700	3 x 2W	72

### Specifications (typical at 25°C and after warm up time unless otherwise specified )

Input Voltage Range	90-264VAC or 120-370VDC	
Rated Power	6W nom. / 7.5W max.	
Input Frequency Range	47-63 Hz	
Power Factor	Full Load, 115VAC/230VAC	0.4
Output Voltage Range	350mA CC	2.5 - 22VDC
	0-300mA CV	24V typ.
	500mA CC	2.5 - 13VDC
	0-490mA CV	15V typ.
	700mA CC	2.5 - 10VDC
	0-600mA CV	12V typ.
Inrush Current (<2mS)	115VAC/230VAC	10A max.
Leakage Current	115VAC/240VAC - 60/50Hz	0.4mA typ.
Input Fuse (Built-in)	Standard	T2A
Input Current	Full Load, Nominal Vin	see table
Output Current Accuracy	(combined Tolerance, Load Regulation and Line Regulation)	±10%
Minimum Load	Open Circuit Protected	1 LED
Output Ripple		0.2Ap-p max.
Hold Up Time		18ms min.
Operating Frequency		132kHz max.
AC RMS Isolation Voltage	I/P to O/P	3.75kV / 1 minute
Temperature Coefficient		±0.02%/°C typ.
Overload Protection		120% typ.
Short Circuit Protection		Continuous Current Limit
Output Overvoltage Protection	350mA Version	24V Zener Diode Clamp
	500mA Version	14V Zener Diode Clamp
	700mA Version	12V Zener Diode Clamp
Overtemperature Protection	Shutdown, Automatic restart after cooling down	
Operating Temperature Range (free air convection, according to CE/UL)	Ambient Temperature	-20°C to +40°C
	Case Temperature	70°C max.
Operating Temperature Range (free air convection, according to ENEC)	Ambient Temperature	-20°C to +50°C
	Case Temperature	70°C max.

continued on next page

**LIGHTLINE**  
AC/DC-Converter  
with 3 year Warranty

**RECOM**

**6 Watt  
Single  
Output**



**UL-8750 Certified  
EN 61347 Certified  
ENEC Certified**

**RACD06**

Refer to Application Notes

## Specifications (typical at 25°C and after warm up time unless otherwise specified )

Storage Temperature Range	-40°C to +85°C		
Humidity	95% RH max.		
IP Rating	IP20, Indoor Use Only		
Weight	34g		
Packing Quantity	10pc		
PCB Material	(UL94V-0)	Plastic Resin with Fibreglass	
Case Material	(UL94V-0)	Plastic	
Designed to meet Standards	Electrical Lighting, EMC Emissions	EN55015:2006 + A1: 2007 + A2:2009	
	Limits for Harmonics Emissions	EN 61000-3-2:2006	
	EMC Compatability: Flicker and Voltage Variations	EN 61000-3-3:2006	
	Electrical Lighting: EMC Immunity	EN 61547:1995 + A1:2000	
	Class II Power Supply Safety	UL1310	
	FCC	FCC18A	
Certifications	LED Lighting Safety (E340696)	UL8750	
	RCM (U21382)	AS/NZS 61347.1:2002, IEC 61347-2-13	
	ENEC General Safety	EN 61347-1: 2008	
	ENEC Safety of AC supplied Control Gear for LED Modules	EN 61347-2-13: 2006	
	PSE	J61347-1(H20), J61347-2-13(H21), J55015(H20)	
Design Lifetime	25°C ambient	>20 x 10 <sup>3</sup> hours in operation	
Connections	AC Input	Screw terminal	
	LED Output	Screw Terminal	

### Note:

All LED Drivers may not be used without a load. They must be switched on the primary side only. Noncompliance may damage the LED or reduce its lifetime.

## Characteristics

### Constant Current (CC) and Constant Voltage (CV) Graph

RACD06-350

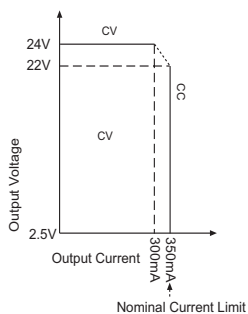

RACD06-500

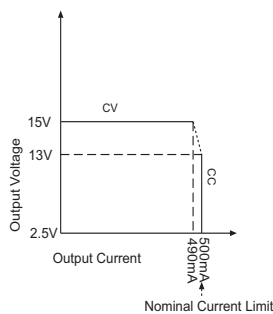

RACD06-700

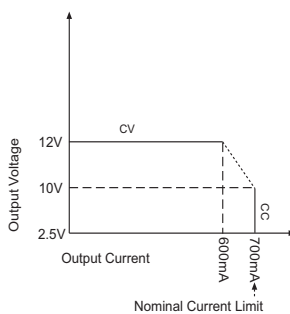

### Maximum Number of LED drivers per circuit breakers

Condition	Circuit Breaker	Circuit Breaker Current			
	Typ	10A	16A	20A	25A
115VAC, 10hm 90° phase angle	C	221	247	337	430
230VAC, 10hm 90° phase angle	B	80	157	200	254
	C	265	317	437	550
277VAC, 10hm 90° phase angle	B	92	180	229	291
	C	304	363	501	631

## Package Style and Pinning

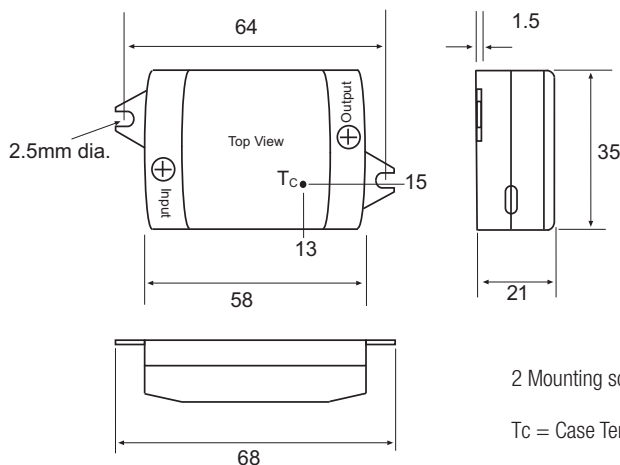

2 Mounting screws are included

T<sub>c</sub> = Case Temperature Measuring Point

### Connections

CN1	Function
L	VAC in (L)
N	VAC in (N)
CN2	Function
+	LED+
-	LED-

### Tolerance

XX = +/-0.5mm

XX.X = +/-0.25mm

The product information and specifications are subject to change without prior notice. RECOM products are not authorized for use in safety-critical applications (such as life support) without RECOM's explicit written consent. A safety-critical application is defined as an application where a failure of a RECOM product may reasonably be expected to endanger or cause loss of life, inflict bodily harm or damage property. The buyer shall indemnify and hold harmless RECOM, its affiliated companies and its representatives against any damage claims in connection with the unauthorized use of RECOM products in such safety-critical applications.

# AMEYA360

## Components Supply Platform

### Authorized Distribution Brand :



### Website :

Welcome to visit [www.ameya360.com](http://www.ameya360.com)

### Contact Us :

#### ➤ Address :

401 Building No.5, JiuGe Business Center, Lane 2301, Yishan Rd  
Minhang District, Shanghai , China

#### ➤ Sales :

Direct +86 (21) 6401-6692

Email [amall@ameya360.com](mailto:amall@ameya360.com)

QQ 800077892

Skype ameyasales1 ameyasales2

#### ➤ Customer Service :

Email [service@ameya360.com](mailto:service@ameya360.com)

#### ➤ Partnership :

Tel +86 (21) 64016692-8333

Email [mkt@ameya360.com](mailto:mkt@ameya360.com)