

GENERAL SPECIFICATIONS

Electrical Capacity (Resistive Load)

Power Level (Silver Contacts): 5A @ 125V AC or 3A @ 250V AC or 30V DC

Other Ratings

Contact Resistance: 10 milliohms maximum
Insulation Resistance: 200 megohms minimum @ 500V DC
Dielectric Strength: 1,000V AC minimum between contacts; 1,500V AC minimum between contacts & case
Mechanical Life: 30,000 operations minimum
Electrical Life: 10,000 operations minimum
Nominal Operating Force: 1,300 grams for momentary; 1,200 grams for alternate action
Travel: 1.0mm (.039") pretravel; 4.0mm (.157") overtravel; 5.0mm (.196") total travel





Materials & Finishes

Caps: Polycarbonate
Plunger: Polyacetal resin
Bushing: Brass with chrome plating
Housing: Steel, chromate over zinc
Movable Contact: Silver
Stationary Contacts: Silver with silver plating
Base: Phenolic resin
Common Terminals: Copper with silver plating
End Terminals: Copper with silver plating
Lamp Terminals: Brass with nickel plating

Standards & Certifications

UL Recognized: All models recognized at 5A @ 125V AC; UL File No. E44145
 Add "/U" to end of part number to order UL mark on switch.

BASIC SWITCH

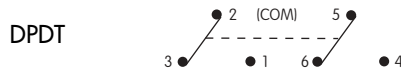
| | | Plunger Position () = Momentary | | Connected Terminals | | Terminals |
|--|------|---|---|---|---|--|
| Model | Pole | Normal  | Down  | Normal  | Down  | Terminal numbers are not actually on the switch. |
| DLB2141W01 DLB2141W03 DLB2145W01 DLB2145W03 | DP | ON ON ON ON | (ON) (ON) ON ON | 2-3 5-6 | 2-1 5-4 | Solder Lug Straight PC Solder Lug Straight PC |
| Throw & Power/Lamp Schematics | |  | | | | Lamp circuit is isolated and requires external power source. |

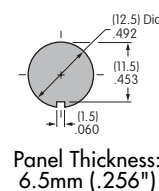
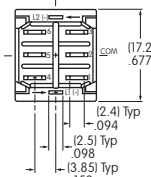
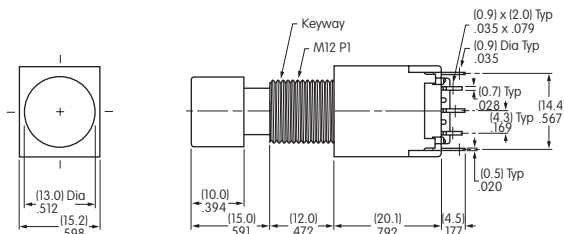

DLB2145W01 with Cap AT418

Standard Hardware:
AT504
Knurled Face Nut,
AT508
Lockwasher,
AT527
Hex Nut.
Detail in Accessories & Hardware section (see Index page Y1).

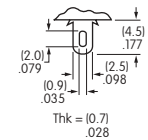

Solder Lug (W01)

Power terminals accommodate one solid 20-gauge wire or two solid or stranded 22-gauge wires. Lamp terminals accommodate one solid 20-gauge wire.

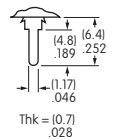

Straight PC (W03)

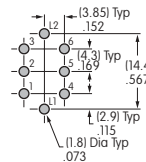

PC Footprint

LAMPS & ELECTRICAL SPECIFICATIONS

Electrical specifications are determined at a basic temperature of 25°C. Lamp circuit is independent of switch operation. The ballast resistor calculation and more lamp detail are shown in the Supplement; see Supplement Index (page Z1).

Incandescent & Neon Lamps for Caps AT419, AT417, AT418, & AT446

| Part Number | Lamp Type | Voltage | Current | Endurance |  |
|-------------|--------------|---------|---------|--------------|---|
| AT604-6V | Incandescent | 6V | 200mA | 1,000 hours | |
| AT604-14V | Incandescent | 14V | 80mA | 750 hours | |
| AT604-28V | Incandescent | 28V | 40mA | 1,000 hours | |
| AT604N | Neon | 110V | 1.5mA | 10,000 hours | |

Use Neon with AT417 & AT418 white caps only. Recommended Resistors: 33K ohms for 110V AC; 100K ohms for 220V AC

Single Element LED in Spot Illuminated Black Opaque Cap

| Part Number | LED Color & Cap Description | Forward Peak Current | Continuous Fwd Current | Forward Voltage | Reverse Peak Voltage | Current Reduction Above 25°C |
|-------------|-----------------------------|----------------------|------------------------|-----------------|----------------------|------------------------------|
| AT463C | Red LED in Square Cap | 35mA | 25mA | 1.65V | 3V | 0.57mA/°C |
| AT463F | Green LED in Square Cap | 30mA | 20mA | 2V | 3V | 0.43mA/°C |
| AT464C | Red LED in Round Cap | 35mA | 25mA | 1.65V | 3V | 0.57mA/°C |
| AT464F | Green LED in Round Cap | 30mA | 20mA | 2V | 3V | 0.43mA/°C |

AT463

Can be combined with Square Mounter AT517.

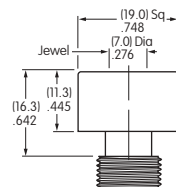



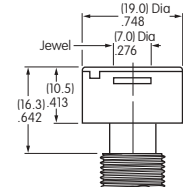

AT464

Can be combined with Round Mounter AT528.

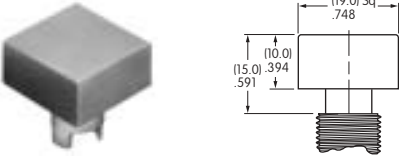

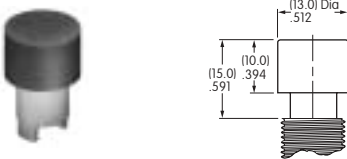
CAP TYPES & COLORS

| | | | Part Number | Cap | Color |
|--|---------------------------------|--|---------------|----------------|--------|
| AT419  | Can be used with Square Mounter | | AT419B | .748" Square | White |
| | | | AT419C | .748" Square | Red |
| | | | AT419D | .748" Square | Orange |
| | | | AT419E | .748" Square | Yellow |
| | | | AT419F | .748" Square | Green |
| | | | AT419G | .748" Square | Blue |
| AT417  | | | AT417B | .346" Diameter | White |
| | | | AT417C | .346" Diameter | Red |
| | | | AT417D | .346" Diameter | Orange |
| | | | AT417E | .346" Diameter | Yellow |
| | | | AT417F | .346" Diameter | Green |
| | | | AT417G | .346" Diameter | Blue |
| AT418  | | | AT418B | .512" Diameter | White |
| | | | AT418C | .512" Diameter | Red |
| | | | AT418D | .512" Diameter | Orange |
| | | | AT418E | .512" Diameter | Yellow |
| | | | AT418F | .512" Diameter | Green |
| | | | AT418G | .512" Diameter | Blue |
| AT446  | Can be used with Round Mounter | | AT446 | .748" Diameter | |
| Black opaque holder; white, red, green, & blue translucent lenses are provided. | | | | | |

OPTIONAL SNAP-IN MOUNTERS

AT517A

Mounter for Square Caps

Provided with assembly instructions

Material: Fiberglass reinforced nylon

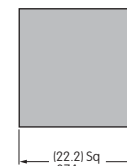
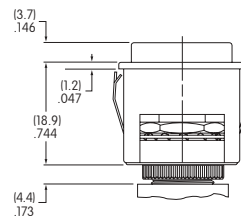

Panel Cutout



DLB2145W01
with Cap AT419 & Square Mounter

Panel Thickness: 1.0 ~ 4.0mm (.039 ~ .157")

AT528A

Mounter for .748" Round Caps

Provided with assembly hardware and instructions

Material: Fiberglass reinforced nylon

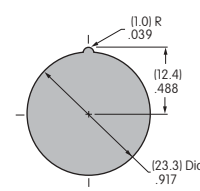
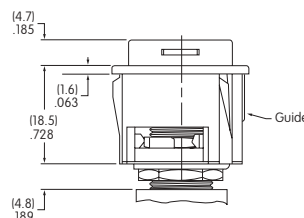

Panel Cutout



DLB2145W01
with Cap AT446 & Round Mounter

Panel Thickness: 1.0 ~ 4.0mm (.039 ~ .157")

AMEYA360

Components Supply Platform

Authorized Distribution Brand :



Website :

Welcome to visit www.ameya360.com

Contact Us :

➤ Address :

401 Building No.5, JiuGe Business Center, Lane 2301, Yishan Rd
Minhang District, Shanghai , China

➤ Sales :

Direct +86 (21) 6401-6692

Email amall@ameya360.com

QQ 800077892

Skype ameyasales1 ameyasales2

➤ Customer Service :

Email service@ameya360.com

➤ Partnership :

Tel +86 (21) 64016692-8333

Email mkt@ameya360.com