

THIS COPY IS PROVIDED ON A RESTRICTED BASIS AND IS NOT TO BE USED IN ANY WAY DETRIMENTAL TO THE INTERESTS OF PANDUIT CORP.

| PANDUIT PART NUMBER ** | PANEL THICKNESS | A ±TOL. | B ±0.015 (0.38) | C ±0.015 (0.38) | D +0.020 (0.51) -0.015 (0.38) | E REF. | F * ±TOL. | G * REF |
|------------------------|--------------------------------|------------------------------|--------------------|--------------------|-------------------------------------|-----------------|--------------------------------------|-----------------|
| GE_36F-C | 0.026 - 0.036 (0.66 - 0.91) | 0.025 ±0.010 (0.64 ±0.25) | 0.045 (1.14) | 0.087 (2.21) | 0.030 (0.76) | 0.106 (2.69) | 0.060 +0.005 (0.13) -0.025 (0.64) | 0.150 (3.81) |
| GE_62F-C | 0.036 - 0.062 (0.91 - 1.57) | 0.035 ±0.013 (0.89 ±0.33) | 0.070 (1.78) | 0.130 (3.30) | 0.030 (0.76) | 0.131 (3.33) | 0.105 +0.005 (0.13) -0.025 (0.64) | 0.150 (3.81) |
| GE_99F-C | 0.062 - 0.099 (1.57 - 2.51) | 0.054 ±0.013 (1.37 ±0.33) | 0.108 (2.74) | 0.155 (3.94) | 0.030 (0.76) | 0.169 (4.29) | 0.125 +0.005 (0.13) -0.025 (0.64) | 0.150 (3.81) |
| GE_144F-C | 0.099 - 0.144 (2.51 - 3.66) | 0.090 ±0.013 (2.29 ±0.33) | 0.152 (3.86) | 0.192 (4.88) | 0.030 (0.76) | 0.213 (5.41) | 0.160 +0.005 (0.13) -0.035 (0.89) | 0.150 (3.81) |
| GE_189F-C | 0.144 - 0.189 (3.66 - 4.80) | 0.12 ±0.030 (3.2 ±0.76) | 0.206 (5.23) | 0.255 (6.48) | 0.046 (1.17) | 0.297 (7.55) | — | — |

NOTES:

- * 1) DIM'S F & G APPLY ONLY TO SLOTTED GROMMET EDGING.
- ** 2) PART NO. EXAMPLE:

| | | | | | | |
|-------------------------|---|----|---|---|---|---|
| GE | S | 36 | F | - | C | 0 |
| GROMMET EDGING | | | | | | |
| S=SOLID E=SLOTTED | | | | | | |
| MAX. PANEL THICKNESS | | | | | | |
| F-POLYETHYLENE | | | | | | |
| WEATHER RESISTANT BLACK | | | | | | |
| 100 FOOT ROLL | | | | | | |
- 3) SEE CURRENT PRICE SHEET FOR PART NO. SUFFIX DESIGNATION FOR PACKAGE SIZE.
- 4) COLOR: a) NATURAL
b) -0 AFTER PART NO. DENOTES WEATHER RESISTANT BLACK
- 5) SLOTTED WALL STYLE IS RECOMMENDED FOR INSIDE EDGE OF PANEL CUT OUTS.
SOLID WALL STYLE IS RECOMMENDED FOR STRAIGHT, OUTSIDE EDGES.
- 6) REELS MAY CONTAIN A MAXIMUM OF THREE SPLICES.

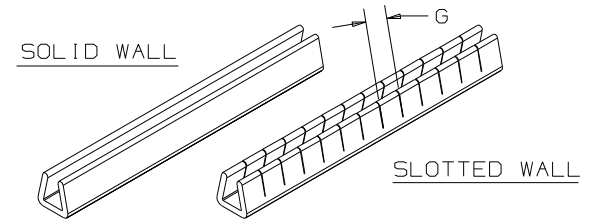
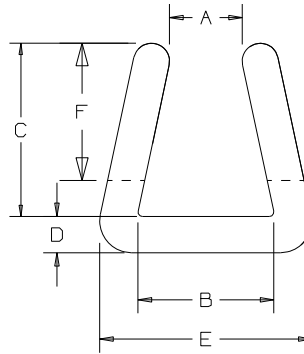

(DIMENSIONS IN PARENTHESES ARE IN METRIC.)

CAD FILENAME/LAYERS G03597DM_DC_GB0239FU_05B.PRT



ROLL FORM GROMMET EDGING
(CUSTOMER DRAWING)

UNLESS OTHERWISE SPECIFIED,
DIMENSIONAL TOLERANCES ARE:
(.X) ± ---- (.XXX) ± ----
(.XX) ± ---- ANGLES ± ----



UNLESS OTHERWISE SPECIFIED,
ALL DIMENSIONS ARE GIVEN
IN INCHES, THIRD ANGLE PROJECTION.

| REV | DATE | BY | CHK | DESCRIPTION | ECN | R | CUST | SUP | QC |
|-----|----------|------|-----|---|----------|---|------|-----|----|
| 5 | 5/20/13 | LEF | VJS | C. ADDED NOTE #6 D. TITLE BLOCK NAME CHANGE E. REPLACED TOLERANCES IN TITLE BLK | GB0239FU | 5 | RAMI | | |
| 4 | 10/18/11 | SHOR | VJS | A. ADDED THICKNESS FOR GE_36F-C, B. ADDED TOLERANCES FOR A, B, C, D, & F | GB0239FU | 4 | RAMI | | |
| 3 | 2/4/03 | LGG | | UPDATED DIM 'A' ON GE_189F-C WAS 0.125 (3.18) | GB0239FU | 3 | | | |
| 2 | 6/12/02 | LGG | | UPDATED DIM 'F' AS REFERENCE | GB0239FU | 2 | | | |
| 1 | 4/10/02 | LGG | | CHG 'G' DIM TO REF | GB0239FU | 1 | | | |
| R | 8-5-98 | CPE | | ADDED NOTE #5, UPDATED FILE NAME | GB0239FU | R | | | |

DRAWN BY
CEW

MAT'L:

SCALE NONE

DATE
5-24-85

SEE NOTE #2

DRAWING NO.

GB0239FU

DWG

A

SIZE

AMEYA360

Components Supply Platform

Authorized Distribution Brand :



Website :

Welcome to visit www.ameya360.com

Contact Us :

➤ Address :

401 Building No.5, JiuGe Business Center, Lane 2301, Yishan Rd
Minhang District, Shanghai , China

➤ Sales :

Direct +86 (21) 6401-6692

Email amall@ameya360.com

QQ 800077892

Skype [ameyasales1](#) [ameyasales2](#)

➤ Customer Service :

Email service@ameya360.com

➤ Partnership :

Tel +86 (21) 64016692-8333

Email mkt@ameya360.com