

## Sub-Miniature Slide Switches

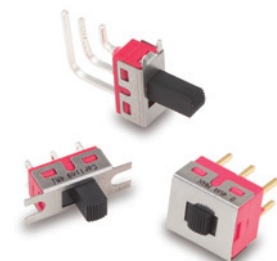

### Miniature Slide Switch

Contact Rating . . . . .	refer to ordering scheme
Electrical Life . . . . .	30,000 make & break cycles at full load
Contact Resistance. . . . .	10 mΩ max. initial @ 2-4 VDC 100mA for both silver & gold plated contacts.
Insulation Resistance . . .	1000 MΩ min.
Dielectric Strength . . . . .	1500 Volts RMS @ sea level
Operating Temperature . . .	-30°C to +85°C
Solder Heat Resistance. . .	MIL-STD-202, Method 210
Actuator Travel . . . . .	25°

Case ..... Diallyl phthalate (DAP) (UL 94V-0)  
Slide Handle. .... Nylon  
Housing. .... Stainless Steel  
Terminal Seal ..... Epoxy

## 4S1-Series Ordering Scheme



#### 4S1 Sub-Miniature Slide Switch

**FSP** single pole

**Switching Position:**

	2-1	OPEN	2-3
1	ON	NONE	
2	ON	NONE	(ON)
3	ON	OFF	ON

**M2** PCB  
**M6** PC Mount, 90° horizontal

	Material	Terminal Plating	Rating
<b>G</b>	silver <sup>1</sup>	gold over silver <sup>3</sup>	3A @ 125VAC or 28VDC; 1.5A @ 250VAC
<b>K</b>	gold <sup>2</sup>	tin-lead <sup>4</sup>	0.4VA max. @ 20V max (AC/DC)
<b>P</b>	silver <sup>1</sup>	tin-lead <sup>4</sup>	3A @ 125VAC or 28VDC; 1.5A @ 250VAC
<b>Q</b>	silver <sup>1</sup>	silver <sup>1</sup>	3A @ 125VAC or 28VDC; 1.5A @ 250VAC
<b>R</b>	gold <sup>2</sup>	gold <sup>2</sup>	0.4VA max. @ 20V max (AC/DC)

Tin-lead option available with PC type terminations only.

- 1 Moveable contact & terminals: copper alloy, silver plate
- 2 Moveable contact & terminals: copper alloy with gold plate over nickel plate
- 3 Terminals: silver plate with outer layer in gold plating

**E** epoxy seal

Switches are bulk packed, unless **T/R** is specified at the end of the part number.  
**T/R** tape reel - 500 pieces per reel

## 4M1-Series Ordering Scheme

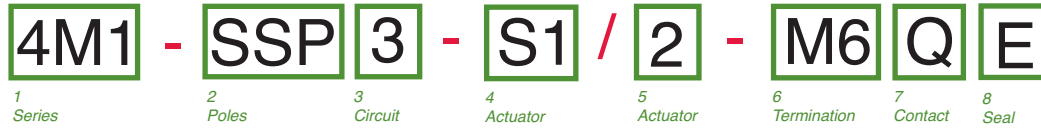

### 1 SERIES

**4M1** Miniature Slide Switch

### 2 POLES

**SSP** single pole **SDP** double pole

### 3 CIRCUIT *Switching Position*

	2-1, 5-4	OPEN	2-3, 5-6
1	ON	NONE	ON
3	ON	OFF	ON

### 4 ACTUATOR

<b>S1</b>	.201 [5.10] high
<b>S2</b>	.285 [7.25] high
<b>S3</b>	.370 [9.40] high
<b>S4</b>	.140 [3.55] high
<b>S5</b>	.053 [1.35] high (for DPDT only)
<b>S6</b>	.482 [12.25] high
<b>S7</b>	.311 [7.90] high
<b>T1</b>	.201 [5.10] high (for DPDT only)

### 5 ACTUATOR COLOR<sup>1</sup>

1 white	3 red	5 yellow	7 blue	9 gray
2 black	4 orange	6 green	8 brown	

<sup>1</sup> White, black & red are standard. Other colors available for quantities of 5K or more.

### 6 TERMINATION

<b>M1</b>	Solder Lug
<b>M2</b>	PCB
<b>M3</b>	Quick Connect
<b>M5-1</b>	Wire Wrap .750 [19.05]
<b>M5-2</b>	Wire Wrap [24.48]

**M5-3** Wire Wrap [10.80]

**M5-4** Wire Wrap [26.97]

**M6** PC Mount, 90° horizontal

**M7** PC Mount, 90° vertical

**VS2** PC Mount, U bracket, .620 mounting x .460 high

### 7 CONTACT

	Material	Terminal Plating	Rating	Approvals
<b>G</b>	silver <sup>1</sup>	gold over silver <sup>3</sup>	5A@125VAC or 28VDC; 2A @ 250VAC	UL, CSA
<b>K</b>	gold <sup>2</sup>	tin-lead <sup>4</sup>	0.4VA max. @20V max (AC/DC)	
<b>P</b>	silver <sup>1</sup>	tin-lead <sup>4</sup>	5A@125VAC or 28VDC; 2A @ 250VAC	UL, CSA
<b>Q</b>	silver <sup>1</sup>	silver <sup>1</sup>	5A@125VAC or 28VDC; 2A @ 250VAC	UL, CSA
<b>R</b>	gold <sup>2</sup>	gold <sup>2</sup>	0.4VA max. @20V max (AC/DC)	

#### NOTE:

Tin-lead option available with PC type terminations only.

1 Moveable contact & terminals: copper alloy, silver plate

2 Moveable contact & terminals: copper alloy with gold plate over nickel plate

3 Terminals: silver plate with outer layer in gold plating

4 Outer terminals: copper alloy with tin-lead over nickel plate

### 8 EPOXY SEAL

**E** epoxy seal

## 4S-Series Dimensional Specifications: in. [mm]

### 4S1-Series

### TERMINATION

#### M2

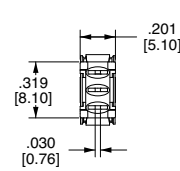
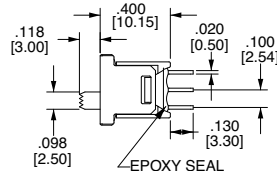
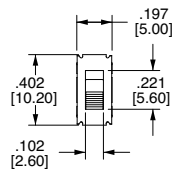

#### PC MOUNTING

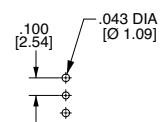

#### M6

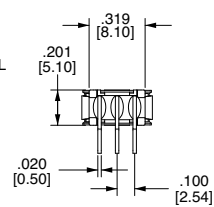
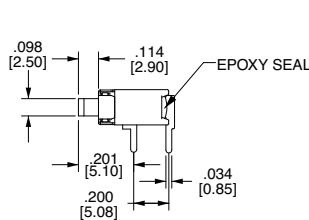
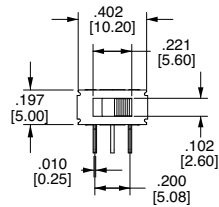

#### PC MOUNTING

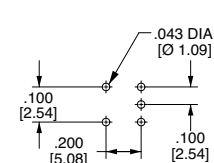

**4M1-Series Dimensional Specifications: in. [mm]**
**ACTUATOR**

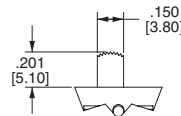
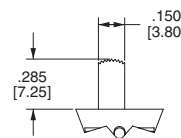
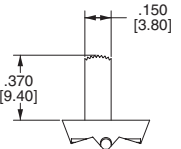
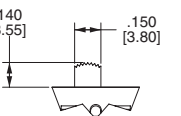
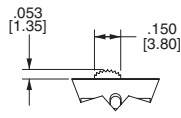
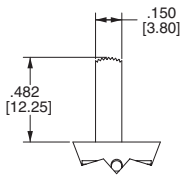
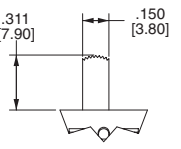
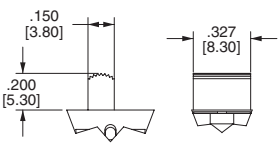
<b>S1</b> 	<b>S2</b> 	<b>S3</b> 	<b>S4</b> 
<b>S5 (For DPDT Only)</b> 	<b>S6</b> 	<b>S7</b> 	<b>T1 (For DPDT Only)</b> 

**TERMINATION**

<p><b>M1</b> STANDARD</p> <p>THK .030 [0.75]</p>	<p><b>M2</b></p> <p>THK .030 [0.75]</p>	<p><b>M3</b> QUICK CONNECT</p> <p>THK .030 [0.75]</p>	<p><b>M5</b></p> <p>THK .030 [0.75]</p>	<table><tr><th>OPTION CODE</th><th>DIM. "A"</th></tr><tr><td>M5-1</td><td>.750 [19.05]</td></tr><tr><td>M5-2</td><td>.964 [24.48]</td></tr><tr><td>M5-3</td><td>.425 [10.80]</td></tr><tr><td>M5-4</td><td>1.062 [26.97]</td></tr></table>	OPTION CODE	DIM. "A"	M5-1	.750 [19.05]	M5-2	.964 [24.48]	M5-3	.425 [10.80]	M5-4	1.062 [26.97]
OPTION CODE	DIM. "A"													
M5-1	.750 [19.05]													
M5-2	.964 [24.48]													
M5-3	.425 [10.80]													
M5-4	1.062 [26.97]													

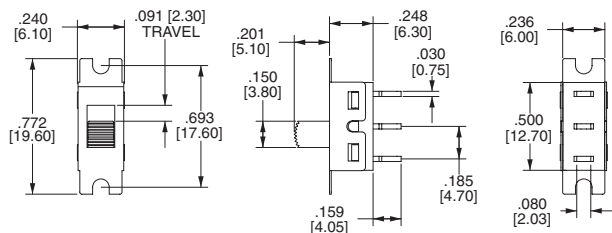
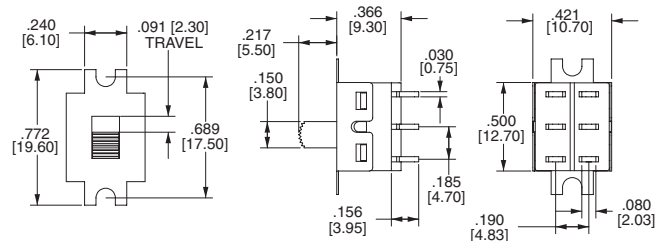
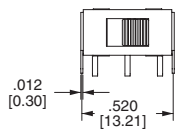
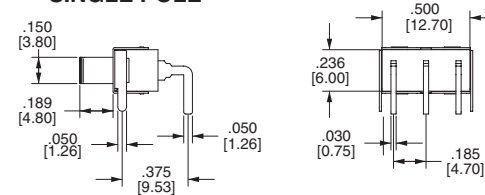
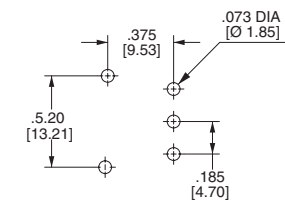
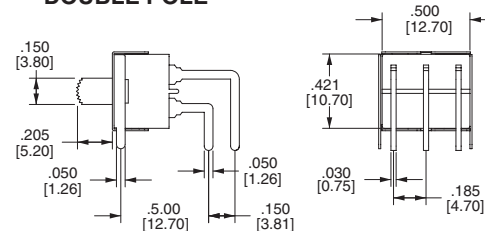
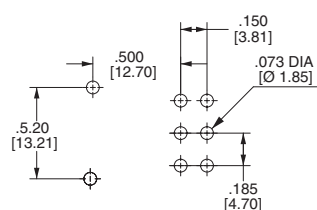
**SINGLE POLE**

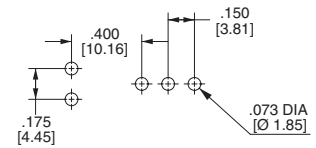
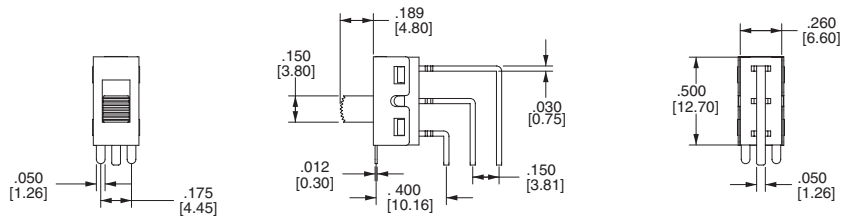
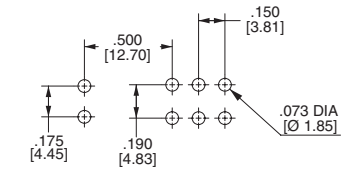
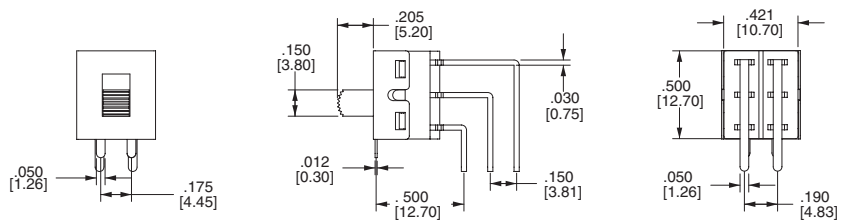
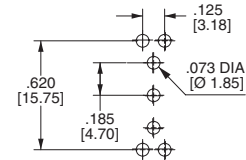
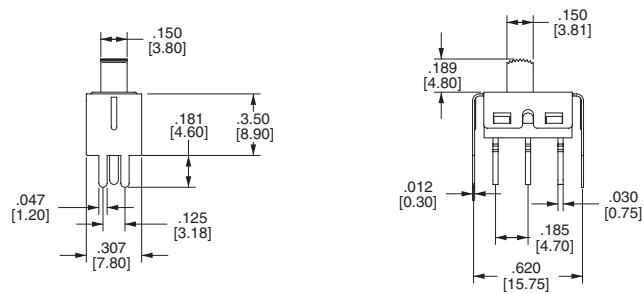
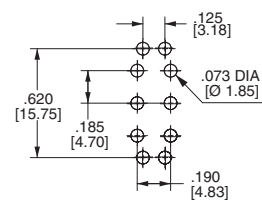
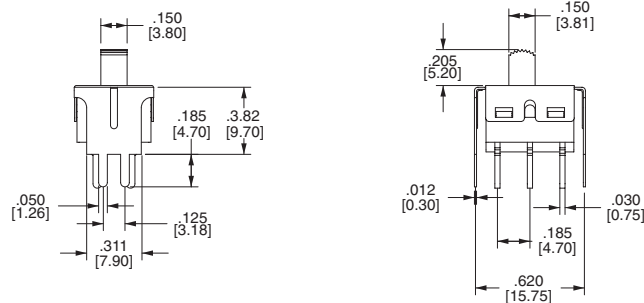
**DOUBLE POLE**

**M6**

**SINGLE POLE**

**PC MOUNTING**

**DOUBLE POLE**

**PC MOUNTING**

**4M1-Series Dimensional Specifications: in. [mm]**
**TERMINATION**
**M7**
**SINGLE POLE**
**PC MOUNTING**

**DOUBLE POLE**
**PC MOUNTING**

**VS2**
**SINGLE POLE**
**PC MOUNTING**

**DOUBLE POLE**
**PC MOUNTING**

# AMEYA360

Components Supply Platform

Authorized Distribution Brand :



Website :

Welcome to visit [www.ameya360.com](http://www.ameya360.com)

Contact Us :

➤ Address :

401 Building No.5, JiuGe Business Center, Lane 2301, Yishan Rd  
Minhang District, Shanghai , China

➤ Sales :

Direct     +86 (21) 6401-6692  
  
Email        amall@ameya360.com  
  
QQ            800077892  
  
Skype        ameyasales1 ameyasales2

➤ Customer Service :

Email        service@ameya360.com

➤ Partnership :

Tel            +86 (21) 64016692-8333  
  
Email        mkt@ameya360.com