

N-1X

Electrical Specifications (@25°C)

1. Maximum Power: 50 VA
2. Input Voltage: 230 V, 50 / 60 Hz
3. Output Voltage: 115V \pm 5%
4. Full Secondary Load: 0.87 Amps RMS

Construction:

Single winding on a double wall, nylon bobbin. This chassis mount design comes in a channel frame with .187" diameter holes in the mounting ears.

Description:

Secondary coil is a fraction of the entire winding for voltage step-down. This causes part of the power to be transferred conductively through the windings, rather than all of the power being transferred by induction.

Safety:

These units are designed with 1500V isolation between the winding and the core. Materials and construction are rated for Class B insulation system.

Dimensions: Unit: In inches

A	B	C	D
2.281	3.687	2.00	3.125

Weight: 1.5 lbs

Connections: 7.0 \pm 1" leads, 0.250 \pm 0.062" Skin & Tin

Schematic:

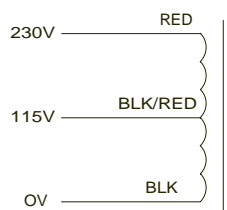

For 230V input: Blk to Red

For 115 output: Blk to Blk/Red

RoHS Compliance: As of manufacturing date February 2005, all standard products meet the requirements of 2002/95/EC, known as the RoHS initiative.

* Upon printing, this document is considered "uncontrolled". Please contact Triad Magnetics' website for the most current version.

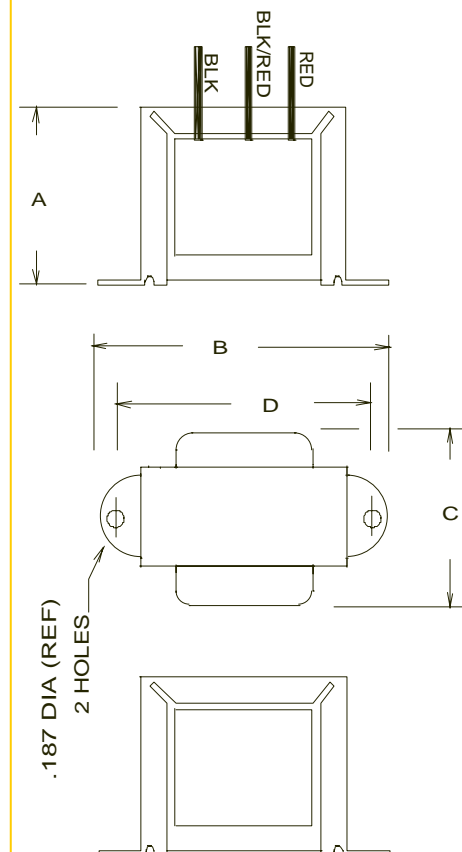
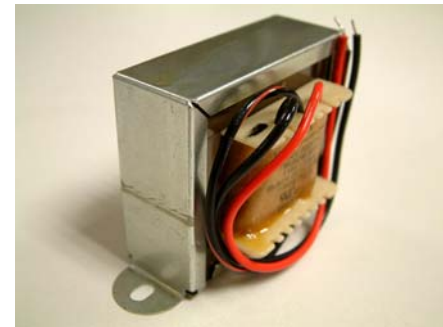

AMEYA360

Components Supply Platform

Authorized Distribution Brand :



Website :

Welcome to visit www.ameya360.com

Contact Us :

➤ Address :

401 Building No.5, JiuGe Business Center, Lane 2301, Yishan Rd
Minhang District, Shanghai , China

➤ Sales :

Direct +86 (21) 6401-6692

Email amall@ameya360.com

QQ 800077892

Skype ameyasales1 ameyasales2

➤ Customer Service :

Email service@ameya360.com

➤ Partnership :

Tel +86 (21) 64016692-8333

Email mkt@ameya360.com