

| Description | Material   | Finish |
|-------------|------------|--------|
| Body        | Brass      | Nickel |
| Socket      | BE CU      | Gold   |
| Insulation  | PTFE       | N/A    |
| Washer      | PH Bronze  | Nickel |
| Gasket      | SI Rubber  | Rubber |
| Crimp Ring  | Brass      | Nickel |
| Insulator   | PTFE       | N/A    |
| Cover       | Brass      | Nickel |
| Heat Shrink | Polyolefin | Black  |

| REVISIONS |   |           |      |
|-----------|---|-----------|------|
| REV       | DESCRIPTION   | DATE      | APPV |
| B         | Add Heat Shrink to Drawing                              | 28-JUL-09 | CJ   |
| C         | Updated dimensions, instructions; Added new title block | 2-JUL-12  | SAH  |

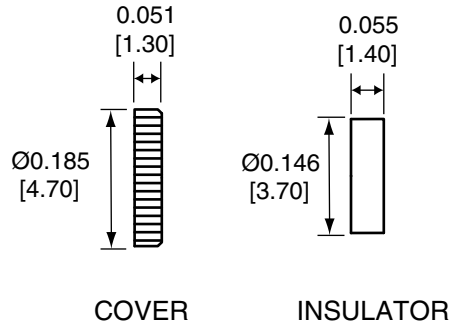

#### CONREVSMA012 ASSEMBLY INSTRUCTIONS

- Strip the cable to the recommended dimensions.
- Slip heat shrink and crimp ring onto stripped cable.
- Slide the cable into the body until the center conductor is centered in the fork.
- Push the braided shield over the barrel.
- Solder the center conductor into the center of the fork.
- Slide the crimp ring over the shield and crimp with a 0.128" hex crimp tool (or one labeled for use with RG-174 cable).
- Trim off any excess shield wire sticking out from the ring.
- Slip the heat shrink over the crimp ring until it is against the body and shrink.
- Insert insulator into body.
- Push the cover into the opening.

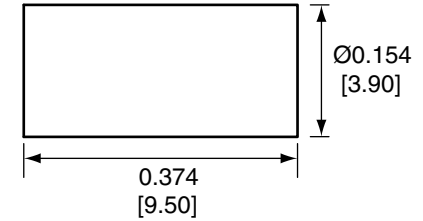
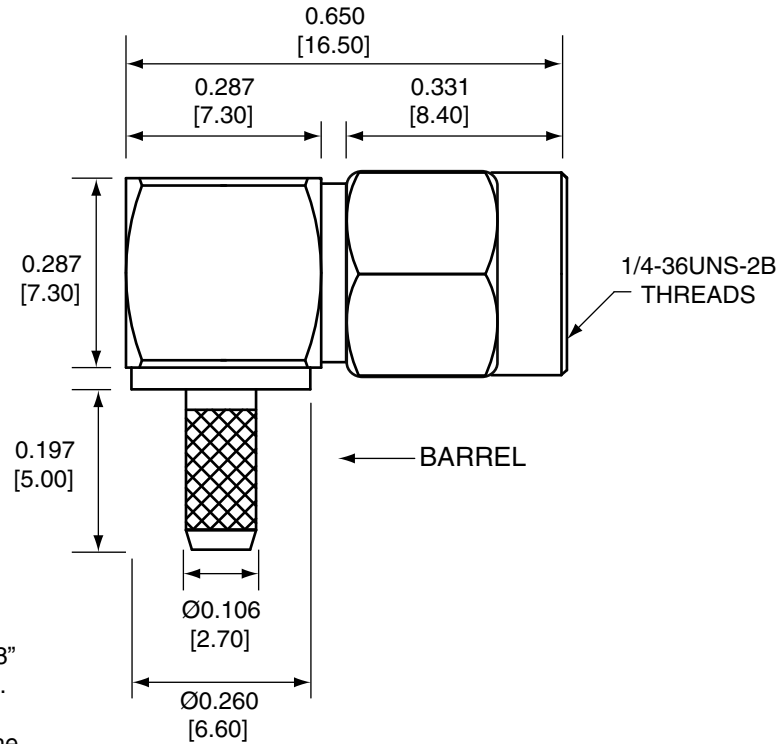

CRIMP RING

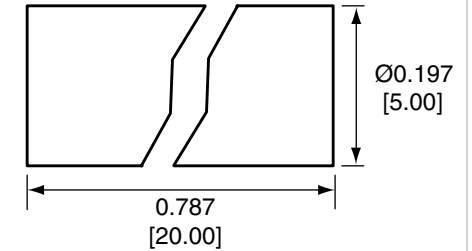

HEAT SHRINK

SIDE VIEW

NOTES: (UNLESS OTHERWISE SPECIFIED)

- ALL DIMENSIONS ARE IN INCHES [mm].
- DIMENSIONS APPLY AFTER FINISHING.
- MANUFACTURE TO BE COMPLIANT WITH EU RoHS DIRECTIVE.
- SAFETY BREAK ALL SHARP CORNERS AND EDGES .02 MAXIMUM.

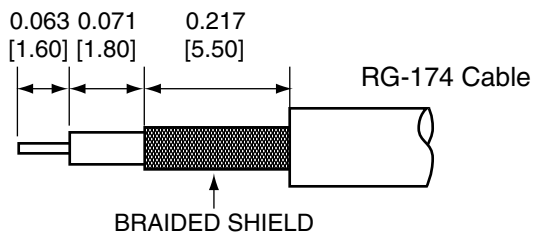

RECOMMENDED CABLE STRIPPING DIMENSIONS

**WARNING:** THIS DRAWING CONTAINS PROPRIETARY INFORMATION THAT IS THE SOLE PROPERTY OF LINX TECHNOLOGIES, AND SHALL BE TREATED AS SUCH. NO DISCLOSURE OR REPRODUCTION OF THIS DOCUMENT IS PERMITTED, IN WHOLE OR IN PART, WITHOUT THE EXPRESS WRITTEN PERMISSION OF LINX TECHNOLOGIES OR ITS DESIGNATED AGENTS.

|           |  |                              |
|-----------|--|------------------------------|
| MATERIAL: | TOLERANCES:<br>.020 [0.50]-.200 [5.00]= ±.008 [0.20]<br>.200 [5.00]-1.200 [30.00]= ±.016 [0.40]<br>1.20 [30.0]-4.75 [120.0]= ±.024 [0.60]<br>4.75 [120.0]-12.40 [315.0]= ±.040 [1.0] | PROJECTION:<br>              |
| FINISH:   | DRAWN: B.MURPHY<br>ENGR: S.HOGAN   | DT: 2-JUL-12<br>DT: 2-JUL-12 |

|  |                          |                                  |  |
|--|--------------------------|----------------------------------|--|
| <b>Linx</b>  |                          | 159 ORT LANE<br>MERLIN, OR 97532 |  |
| TITLE:<br>RP-SMA MALE RIGHT ANGLE<br>CABLE END CRIMP FOR RG174 CABLE |                          |                                  |  |
| SIZE<br><b>A</b>   | DWG. NO.<br>CONREVSMA012 | REV<br><b>C</b>                  |  |
| SCALE: 2:1   | DO NOT SCALE DRAWING     | SHEET 1 OF 1                     |  |

# AMEYA360

Components Supply Platform

Authorized Distribution Brand :



Website :

Welcome to visit [www.ameya360.com](http://www.ameya360.com)

Contact Us :

➤ Address :

401 Building No.5, JiuGe Business Center, Lane 2301, Yishan Rd  
Minhang District, Shanghai , China

➤ Sales :

Direct +86 (21) 6401-6692

Email [amall@ameya360.com](mailto:amall@ameya360.com)

QQ 800077892

Skype [ameyasales1](#) [ameyasales2](#)

➤ Customer Service :

Email [service@ameya360.com](mailto:service@ameya360.com)

➤ Partnership :

Tel +86 (21) 64016692-8333

Email [mkt@ameya360.com](mailto:mkt@ameya360.com)