

NOTES: FINISH  
1. MATERIALS AND FINISHES:  
BODY - BRASS, NICKEL PLATING  
CONTACT - BERYLLIUM COPPER, GOLD PLATING  
CONTACT - BRASS, GOLD PLATING  
INSULATOR - PTFE, NATURAL  
2. ELECTRICAL:  
A. IMPEDANCE: 50 OHM  
B. DIELECTRIC WITHSTANDING VOLTAGE: 1500 VRMS, MIN.  
3. MECHANICAL:  
A. DURABILITY: 500 CYCLES MIN.  
B. TEMPERATURE RANGE: -65° C TO +165° C

THIRD ANGLE PROJ.

REVISIONS				
REV	DESCRIPTION	DATE	ECO	APPR
--	RELEASE TO MFG.	----	----	----
E	SPRING WAS CHANGED	09-Aug-12	49157	TD

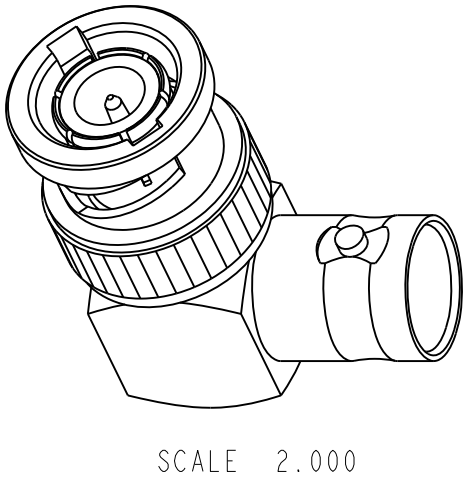
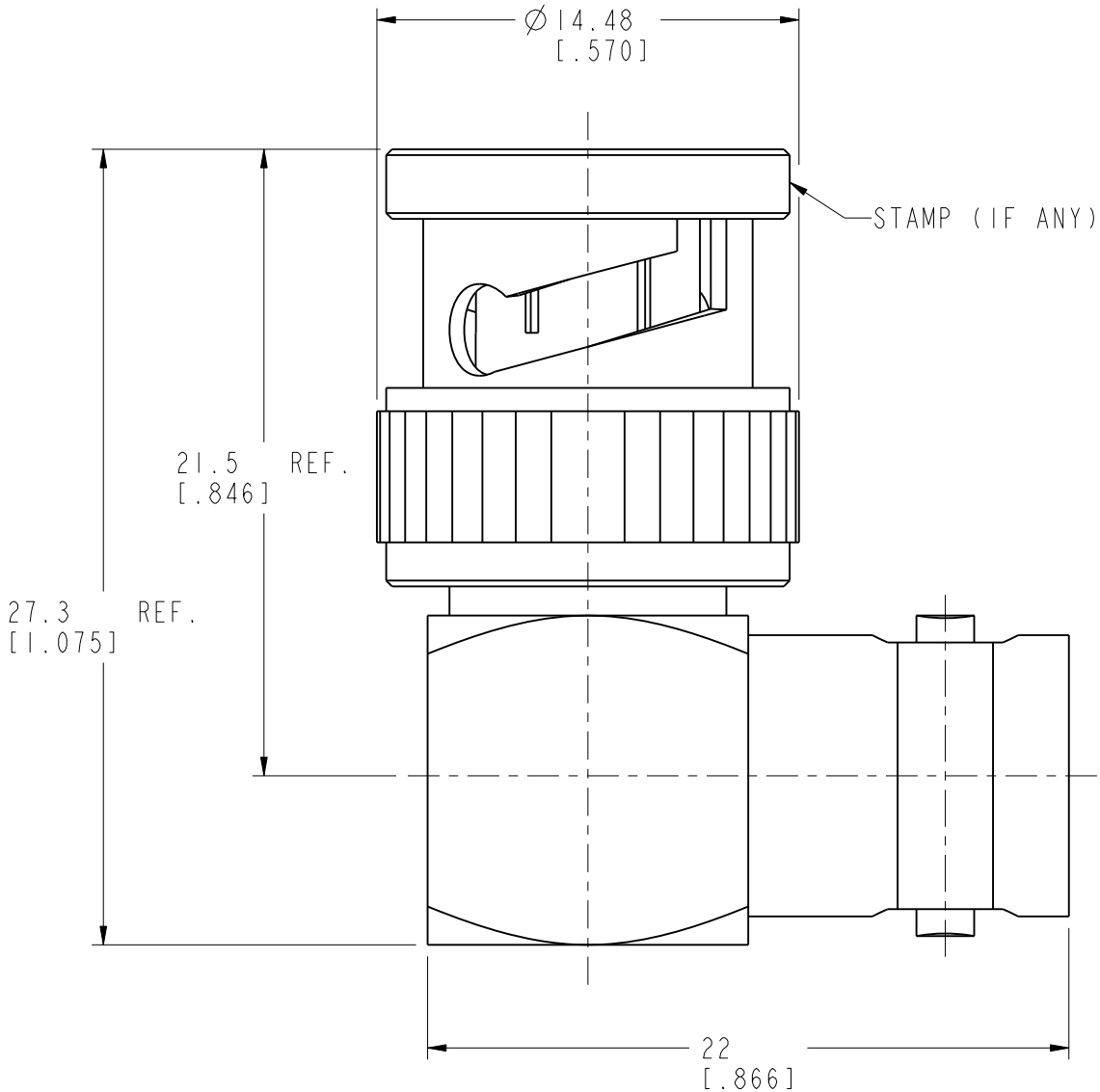

**CUSTOMER OUTLINE DRAWING**  
ALL OTHER SHEETS ARE FOR INTERNAL USE ONLY

<div>UNLESS OTHERWISE SPECIFIED, DIMENSIONS ARE IN METRIC AND TOLERANCES ARE: &lt;0.5mm ± 0.05mm    0.5 - 6mm ±0.1mm    6 - 30mm ±0.2mm    30 - 120mm ± 0.3mm    ANGLES ±1°</div> <div>NOTICE - These drawings, specifications, or other data (1) are, and remain the property of Amphenol corp. (2) must be returned upon request; and (3) are confidential and not to be disclosed to any person other than those to whom they are given by Amphenol Corp. the furnishing of these drawings, specifications, or other data by Amphenol Corp., or to any other person to anyone for any purpose is not to be regarded by implication or otherwise in any manner licensing, granting rights to permitting such holder or any other person to manufacture, use or sell any product, process or design, patented or otherwise, that may in any way be related to or disclosed by said drawings, specifications, or other data.</div>	MATERIAL	DRAWN T.DENG	DATE 09-Aug-12	TITLE BNC MALE TO FEMALE R/A ADAPTOR		Amphenol RF Danbury CT USA, Tainan, Taiwan, Shenzhen, China www.amphenolrf.com	
	REFERENCE EAR 962370-0  CONFIGURATION LEVEL:	ENGINEER D.ROYCE	DATE 14-Jun-91				
		APPROVED S.HSIEH	DATE 09-Aug-12				
		CAD FILE	SCALE: 4.0:1.0		SHEET 2 OF 2	DRAWING NO.B5072A1-001-NT3G-50	
	FINISH	I:\BNC\B5072A1-001-NT3G-50		DWG SIZE B	REV E	ITEM NO. 015072AAAA00NA5F	PART NO. 31-9-RFX

Authorized Distribution Brand :



Website :

Welcome to visit [www.ameya360.com](http://www.ameya360.com)

Contact Us :

➤ Address :

401 Building No.5, JiuGe Business Center, Lane 2301, Yishan Rd  
Minhang District, Shanghai , China

➤ Sales :

Direct +86 (21) 6401-6692

Email [amall@ameya360.com](mailto:amall@ameya360.com)

QQ 800077892

Skype ameyasales1 ameyasales2

➤ Customer Service :

Email [service@ameya360.com](mailto:service@ameya360.com)

➤ Partnership :

Tel +86 (21) 64016692-8333

Email [mkt@ameya360.com](mailto:mkt@ameya360.com)