

THERMOPLASTIC FUSE RATED 36V

RoHS



Specifications

Complies with: DIN 72581-1

Ordering Information

Part Number	Package Size
0214xxx.LXN	50
0214xxx.K	10000

Description

Consisting of a heat resistant body, the fuse element stretches over the exterior of the body from end to end. The body varies in color indicating the current ratings.

Dimensions

Dimensions in mm

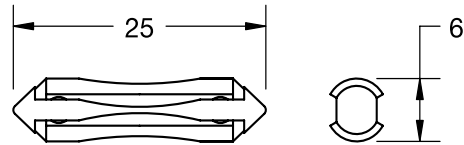

Ratings

Part Number	Current Rating	Housing Color	Typ. Voltage Drop Littelfuse max
0214005_	5A	Yellow	50mV
0214008_	8A	White	50mV
0214016_	16A	Red	50mV
0214025_	25A	Blue	50mV
0214040_	40A	Grey	50mV

AMEYA360

Components Supply Platform

Authorized Distribution Brand :



Website :

Welcome to visit www.ameya360.com

Contact Us :

➤ Address :

401 Building No.5, JiuGe Business Center, Lane 2301, Yishan Rd
Minhang District, Shanghai , China

➤ Sales :

Direct +86 (21) 6401-6692

Email amall@ameya360.com

QQ 800077892

Skype [ameyasales1](#) [ameyasales2](#)

➤ Customer Service :

Email service@ameya360.com

➤ Partnership :

Tel +86 (21) 64016692-8333

Email mkt@ameya360.com