

Ordering a market-ready enclosure® is made fast and affordable with our complete in-house capabilities. New Age provides machined openings to fit your PCB, pad printing for your graphics, custom enclosures, custom colors, final assembly, testing and fulfillment services to save you additional time and money. Ask your representative for a free quote today 805-595-1310.

Fast and Affordable Customization

**CNC Modifications
Pad Printing
Colored Resins
EMI/RF Shielding
Custom Enclosure
Assembly & Testing**

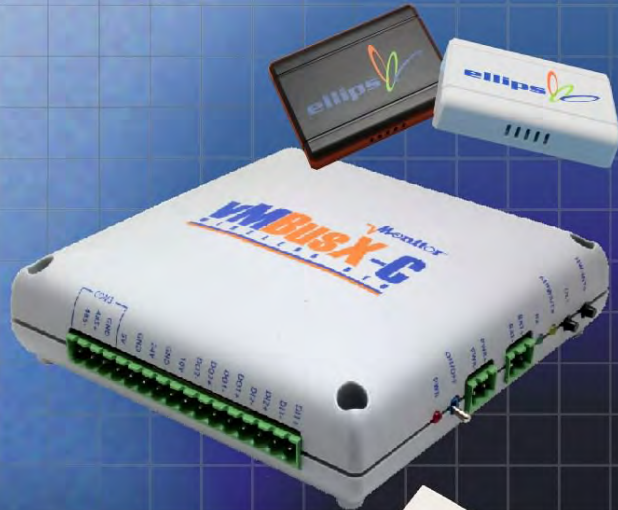

ISO quality
off-the-shelf
to market-ready®

NEW AGE ENCLOSURES

www.NewAgeEnclosures.com

4330 Santa Fe Road • San Luis Obispo, CA 93401 • T 805.595.1310 • F 805.595.1024

NOTES: UNLESS OTHERWISE SPECIFIED

- CORNERS DRAWN SHARP TO BE R.005 MAXIMUM.
- EXTERIOR SURFACE TEXTURE TO BE LIGHT EDM FINISH. EQUIVELANT TO MT-11010.
- INTERIOR SURFACE TEXTURE: NONE
- ALL INSIDE RADII .010R. UNLESS OTHERWISE SPECIFIED.
- ALL EXTERNAL DIMENSIONS AFFECTED BY THE DRAFT APPLY AT THE LARGE END OF THE FEATURE, AND ALL INTERNAL FEATURES AFFECTED BY THE DRAFT APPLY AT THE SMALL END OF THE FEATURE UNLESS OTHERWISE SPECIFIED.
- 1 DEGREES DRAFT IN THE DIRECTION OF PULL IS PERMISSIBLE UNLESS OTHERWISE SPECIFIED.
- THIS ENCLOSURE IS A PRESS FIT ASSEMBLY. FOR PERMANENT CLOSURE: A DROP ADHESIVE OR ULTRASONIC WELDING IS REQUIRED.
- MATERIAL / COLOR: ABS PLASTIC IS STANDARD IN BLACK OR WHITE. CUSTOM MATERIALS AND COLORS ARE AVAILABLE UPON REQUEST FOR QUOTE.
- PCB SIZES ARE RECOMMENDATIONS ONLY. FINAL SIZES AND VERIFICATION OF IT'S FIT ARE THE SOLE RESPONSIBILITY OF EACH OWNER.
- THE GATE REMNANT FOR THIS ENCLOSURE IS LOCATED IN THIS POSITION TO MINIMIZE ANY COSMETIC IMPACT. IT IS HOWEVER VISIBLE AND VARIES IN SIZE / SHAPE. IT IS EASILY REMOVED WITH CLIPPERS. IF YOU WOULD LIKE NEW AGE TO CLIP THIS FOR YOU, PLEASE ASK YOUR SALES REPRESENTIVE FOR A FREE QUOTE.

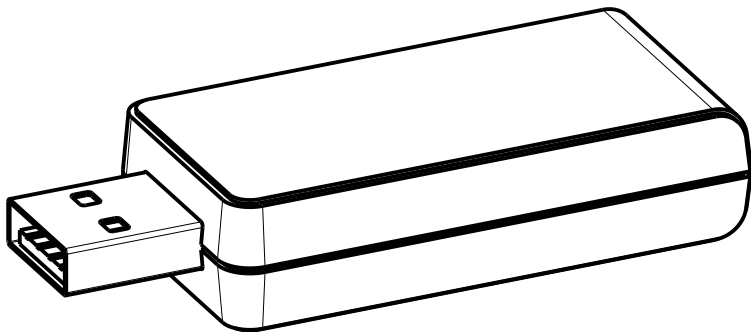

SCALE 1.500

P201005(x) CONFIGURATIONS

| | -S | -U | -62S | -62U |
|--|----|----|------|------|
| 201005 COVER | 1 | | 1 | |
| 201005 COVER w/ USB OPENING | | 1 | | 1 |
| 201005 BASE | 1 | | | |
| 201005 BASE (.062" PCB) | | | 1 | |
| 201005 BASE w/ USB OPENING | | 1 | | |
| 201005 BASE (.062" PCB) w/ USB OPENING | | | | 1 |

| 3 | 201005_PCB | 201005 PCB - REFERENCE | .031" THICK | CUSTOMER SUPPLIED | 1 |
|------|--------------|--------------------------|-------------|-------------------|------|
| 2 | 201005_COVER | 201005U COVER - STANDARD | ABS | BLACK or WHITE | 1 |
| 1 | 201005_BASE | 201005U BASE - STANDARD | ABS | BLACK or WHITE | 1 |
| ITEM | FILE NAME | DESCRIPTION | MATERIAL | COLOR | QTY. |

BILL OF MATERIALS

REVISION

| REV. | DRAWN BY | ECO No | DESCRIPTION | DATE | APPROVED |
|------|----------|--------|---|-----------|----------|
| 1 | M BOYER | | PRELIMINARY RELEASE | 21-May-07 | D.C. |
| 2 | M BOYER | | ADD WIDE PCB CONFIGURATION | 06-Jun-07 | D.C. |
| 3 | M BOYER | | MOVE PCB POSTS OUTWARD .03 PER SIDE | 30-Jul-07 | D.C. |
| 4 | M BOYER | | UPDATE TO AS BUILT | 12-Oct-07 | D.C. |
| 5 | M BOYER | 0208 | UPDATE FORMAT AND RELEASE | 04-Apr-08 | D.C. |
| 5.1 | M BOYER | 0710 | UPDATE FORMAT | 30-Mar-10 | D.C. |
| 5.2 | M BOYER | 0810 | ADD NOTE 10 | 08-Apr-10 | D.C. |
| 6.0 | M BOYER | 2910 | UPDATE BOARD THICKNESS INFORMATION | 16-Aug-10 | D.C. |
| 6.1 | M BOYER | 3010 | DOCUMENT CHANGE | 24-Aug-10 | D.C. |
| 6.2 | M BOYER | 2711 | CHANGE ASSEMBLY DIMENSIONS TO "PRESS FIT" | 21-Oct-11 | D.C. |
| 7.0 | M BOYER | 1913 | INCLUDE .062" PCB OPTION | 09-Apr-13 | D.C. |
| 7.1 | R CRUZ | 8713 | REMOVE .062" COVER OPTION | 18-Dec-13 | |

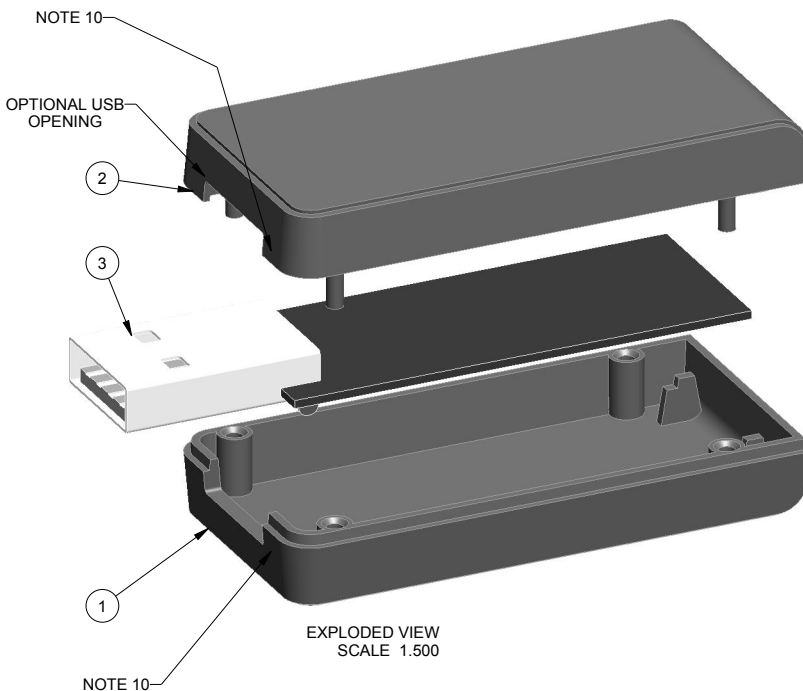

THIRD ANGLE PROJECTION
DO NOT SCALE DRAWING

TOLERANCES: UNLESS OTHERWISE SPECIFIED
DIMENSIONS ARE IN U.S. INCHES.
X.XX = .015 X.XXXX = .001
X.XXX = .010 X.X° = 1°

NEW AGE ENCLOSURES

Customer's Part No: 201005

| APPROVAL | BY | DATE |
|----------|----------|------|
| CHECK | | |
| ENG. | | |
| SCALE | AS NOTED | |

DRAWN BY
M BOYER 21-May-07

NEW AGE ENCLOSURES
4330 Santa Fe Road San Luis Obispo, CA. 93401
ph. (805) 595-1310 fax (805) 595-1024
www.newageenclosures.com

**STANDARD - USB DEVICE
PXX-201005X ASSEMBLY**

SIZE A DRAWING NAME 201005_R7_1 SHEET 1 OF 6 REV.DOC 7.1

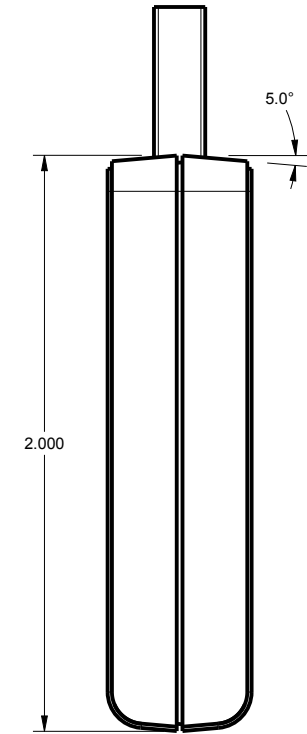
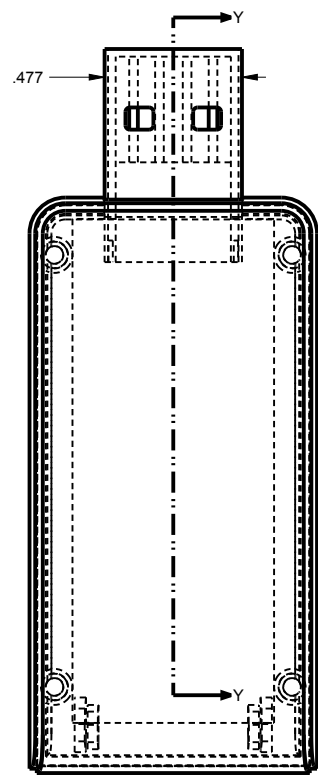
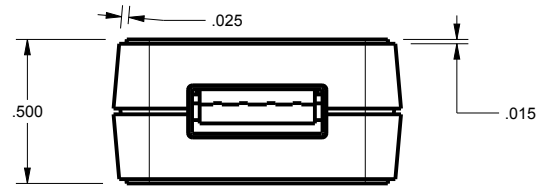
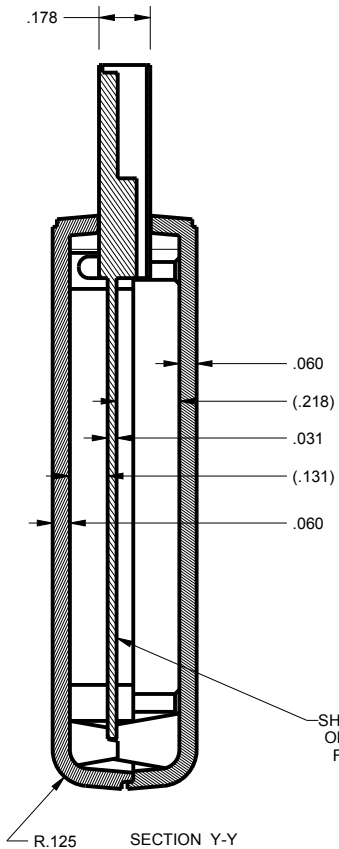

SCALE 1.500

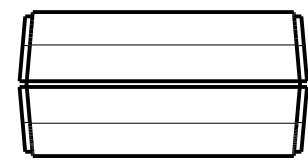

| | | | | | |
|---|----------|------|----------------|---|-----------------|
| TOLERANCES- UNLESS OTHERWISE SPECIFIED DIMENSIONS ARE IN U.S. INCHES. X.XX = .015 X.XXXX = .001 X.XXX = .010 X.X° = 1° | | | | NEW AGE ENCLOSURES 4330 Santa Fe Road San Luis Obispo, CA. 93401 ph. (805) 595-1310 fax (805) 595-1024 www.newageenclosures.com | |
| NEW AGE ENCLOSURES Customer's Part No: 201005 | | | | | |
| APPROVAL | BY | DATE | | | |
| CHECK | | | | | |
| ENG. | | | | | |
| SCALE | AS NOTED | | | | |
| DRAWN BY M BOYER | | | SIZE A | DRAWING NAME 201005_R7_1 | SHEET 2 OF 6 |
| 21-May-07 | | | REV.DOC 7.1 | | |

201005U COVER

Dimensions and Tolerances:

- Top View: .160, R.015, .081, .026, .015, .020, .081, .060, .124, .825, .480, .800, .700, .035, .650, .038, (.218), R.125, .240
- Section Y-Y: .020, .081, .060, .825, .038, (.218), R.125
- Bottom View: .240

SCALE 2.000

"PRESS FIT"

TOLERANCES: UNLESS OTHERWISE SPECIFIED
DIMENSIONS ARE IN U.S. INCHES.
X.XX = .015 X.XXXX = .001
X.XXX = .010 X.X° = 1°

NEW AGE ENCLOSURES
4330 Santa Fe Road San Luis Obispo, CA. 93401
ph. (805) 595-1310 fax (805) 595-1024
www.newageenclosures.com

Customer's Part No: 201005

APPROVAL BY DATE
CHECK
ENG.
SCALE AS NOTED

DRAWN BY M BOYER 21-May-07

SIZE A DRAWING NAME 201005_R7_1

SHEET 3 OF 6 REV. DOC 7.1

STANDARD - USB DEVICE
PXX-201005X ASSEMBLY

**TOLERANCES: UNLESS OTHERWISE SPECIFIED
DIMENSIONS ARE IN U.S. INCHES.**

| | |
|---------------------|----------------------|
| X.XX = .015 | X.XXXX = .001 |
| X.XXX = .010 | X.X° = 1° |

NEW AGE ENCLOSURES

Customer's Part No: 201005

| | | |
|----------|----------|------|
| APPROVAL | BY | DATE |
| CHECK | | |
| ENG. | | |
| SCALE | AS NOTED | |

| | |
|----------|-----------|
| DRAWN BY | |
| M BOYER | 21-May-07 |

**NEW AGE
ENCLOSURES**

4330 Santa Fe Road San Luis Obispo, CA. 93401
ph. (805) 595-1310 fax (805) 595-1024
www.newageenclosures.com

STANDARD - USB DEVICE
PXX-201005X ASSEMBLY

| | | | |
|------------------|------------------------------------|------------------------|-----------------------|
| SIZE A | DRAWING NAME 201005_R7_1 | SHEET 3 OF 6 | REV.DOC 7.1 |
|------------------|------------------------------------|------------------------|-----------------------|

201005U BASE

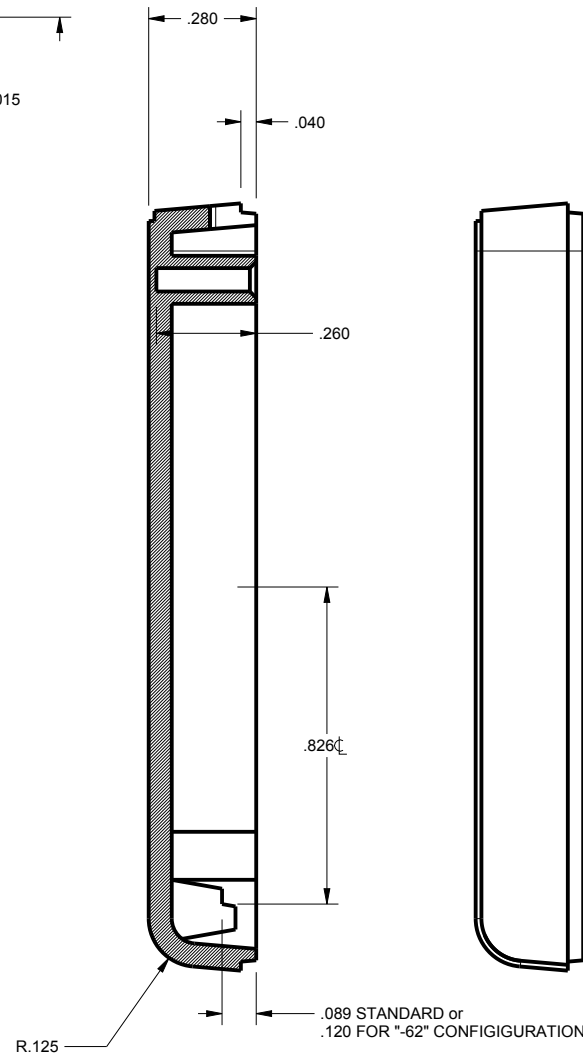
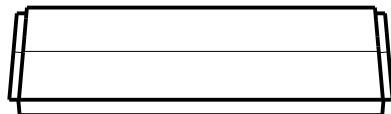
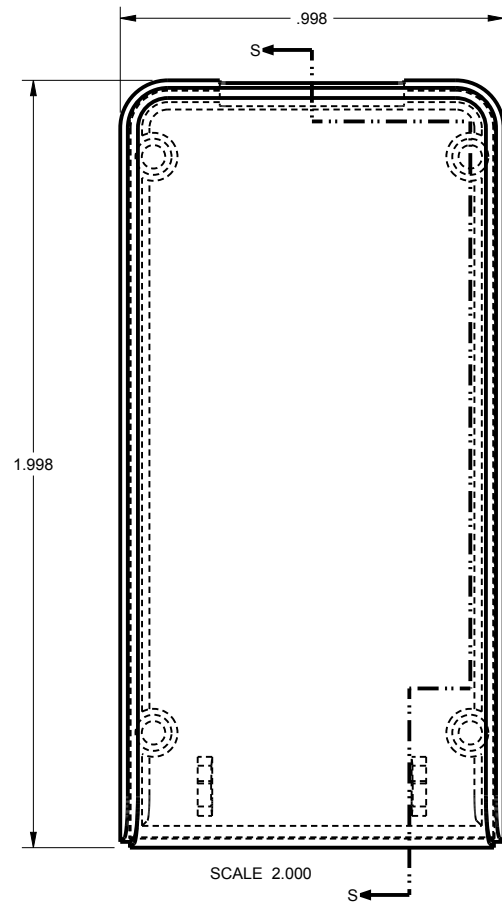
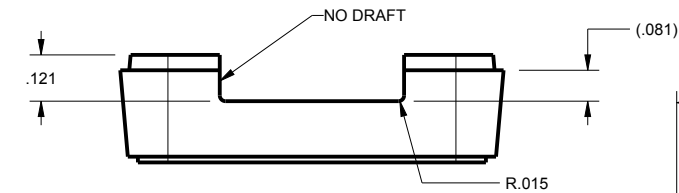

SECTION S-S

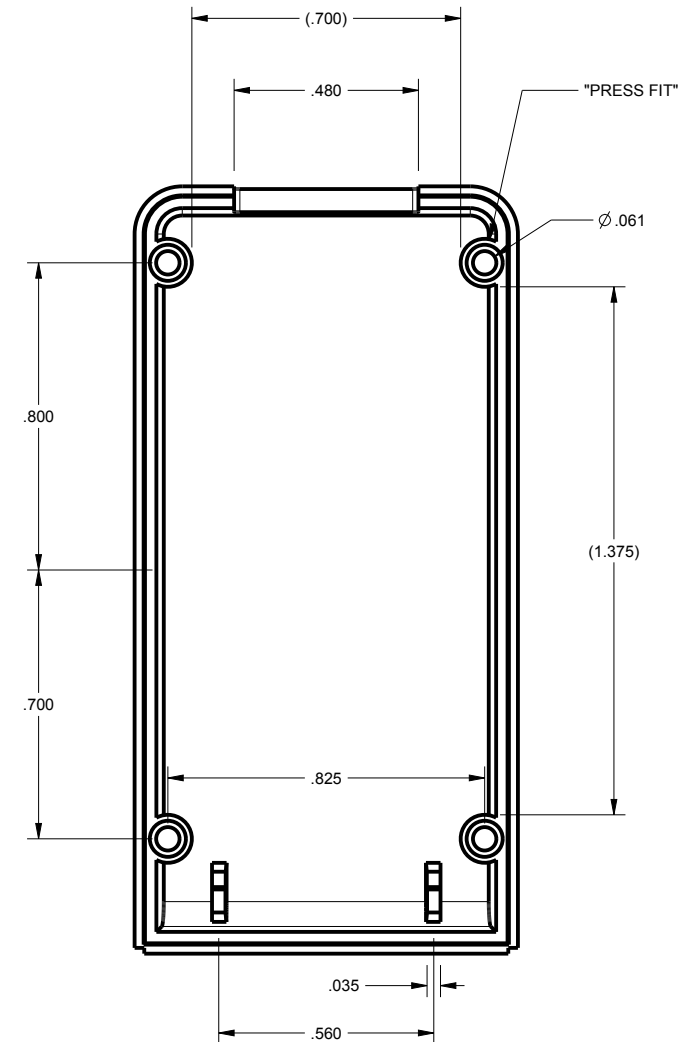

TOLERANCES: UNLESS OTHERWISE SPECIFIED
DIMENSIONS ARE IN U.S. INCHES.
X.XX = .015 X.XXXX = .001
X.XXX = .010 X.X° = 1°

NEW AGE ENCLOSURES

Customer's Part No: 201005

| | | |
|----------|----------|------|
| APPROVAL | BY | DATE |
| CHECK | | |
| ENG. | | |
| SCALE | AS NOTED | |

| | |
|----------|-----------|
| DRAWN BY | 21-May-07 |
| M BOYER | |

NEW AGE ENCLOSURES
4330 Santa Fe Road San Luis Obispo, CA. 93401
ph. (805) 595-1310 fax (805) 595-1024
www.newageenclosures.com

STANDARD - USB DEVICE
PXX-201005X ASSEMBLY

| | | | |
|------|--------------|--------|---------|
| SIZE | DRAWING NAME | SHEET | REV.DOC |
| A | 201005_R7_1 | 4 OF 6 | 7.1 |

201005 PCB - CUSTOMER SUPPLIED

PCB SIZES ARE RECOMMENDATIONS ONLY. FINAL
SIZES AND VERIFICATION OF IT'S FIT ARE THE
SOLE RESPONSIBILITY OF THE OEM.

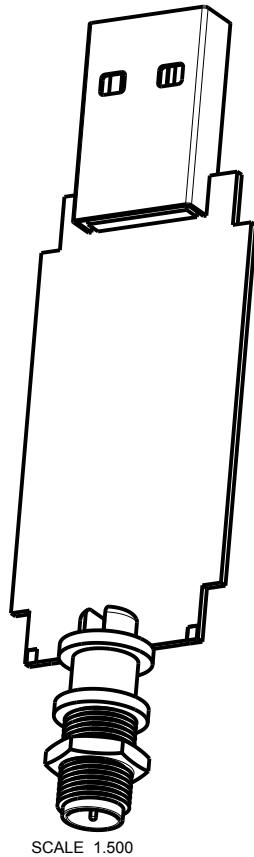

SCALE 1.500

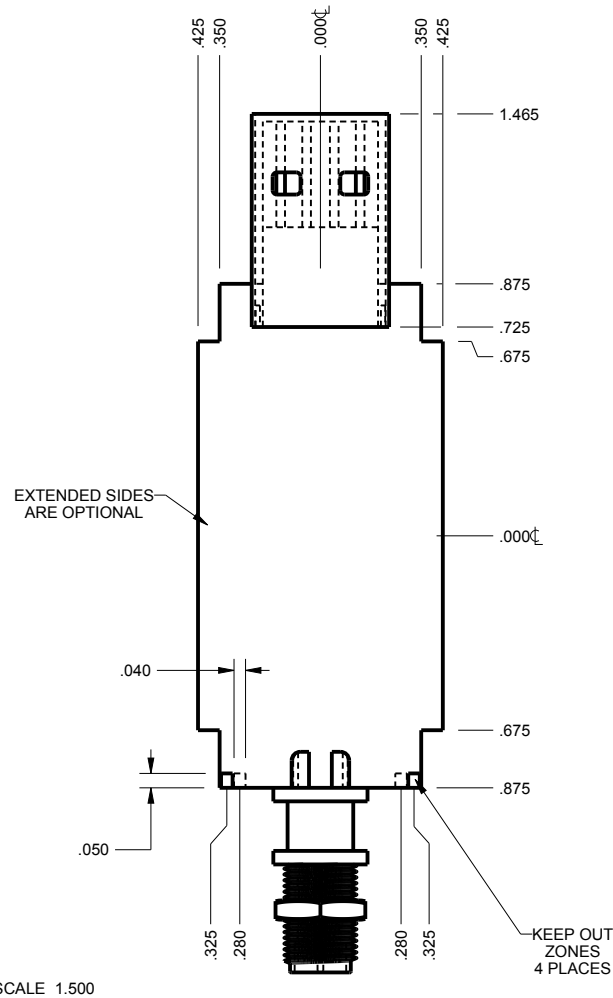

SCALE 1.500

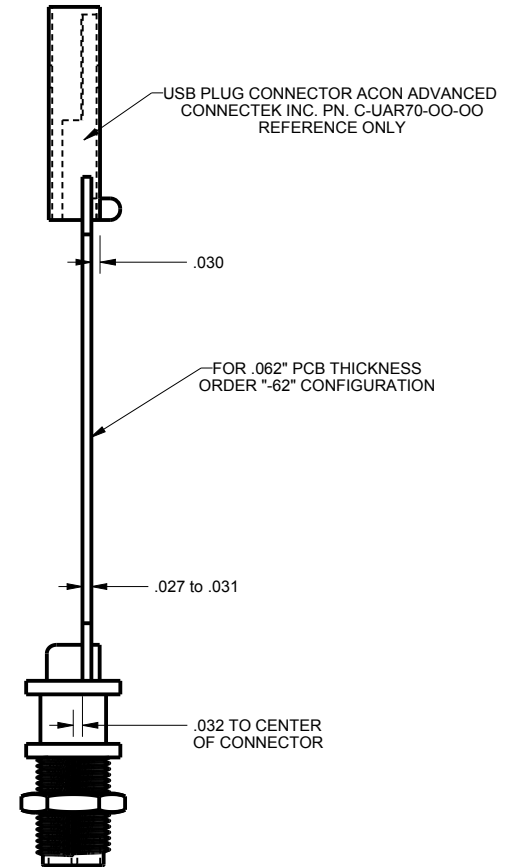

** = RECOMMENDED BOARD THICKNESS IS .031" or .062" THICK, OPTIONS
ARE AVAILABLE TO ALLOW OTHER THICKNESSES. ASK YOUR SALES REP FOR A QUOTE.

| | |
|--|-----------|
| TOLERANCES- UNLESS OTHERWISE SPECIFIED DIMENSIONS ARE IN U.S. INCHES. | |
| X.XX = .015 X.XXXX = .001 | |
| X.XXX = .010 X.X" = 1° | |
| NEW AGE ENCLOSURES | |
| Customer's Part No: 201005 | |
| APPROVAL | BY DATE |
| CHECK | |
| ENG. | |
| SCALE | AS NOTED |
| DRAWN BY | 21-May-07 |
| M BOYER | |

| | |
|---|--------------|
| NEW AGE ENCLOSURES | |
| 4330 Santa Fe Road San Luis Obispo, CA. 93401 | |
| ph. (805) 595-1310 fax (805) 595-1024 | |
| www.newageenclosures.com | |
| STANDARD - USB DEVICE PXX-201005X ASSEMBLY | |
| SIZE | DRAWING NAME |
| A | 201005_R7_1 |
| SHEET | REV.DOC |
| 5 OF 6 | 7.1 |

2nd OPERATION DETAILS

New Age Enclosures DELIVERS YOUR ENCLOSURE MARKET-READY WITH IN-HOUSE
CNC MACHINING, PAD PRINTING, ASSEMBLY, AND FULFILLMENT.
ALL SURFACES AND AREAS ARE AVAILABLE FOR CNC ALTERATION BY New Age Enclosures
CALL (805) 595-1310 FOR PRICING AND SCHEDULE.
THE INSIDE RADIUS OF ANY MACHINED FEATURES SHOULD BE NO SMALLER THAN .031"

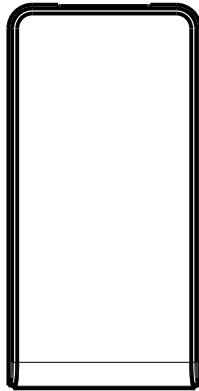
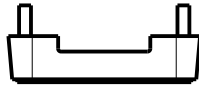

201005U COVER
SCALE 1.000

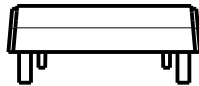
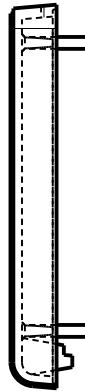

201005U BASE
SCALE 1.000

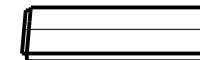

PXX-201005U-XXX COVER - ABS, BLACK

| STEP NO | DESCRIPTION | CUTTER | FIXTURE | ORIENTATION | PROGRAM |
|---------|-------------|---------------|---------|-------------|---------|
| 1 | - | T2 = .062" EM | 103 | - | |
| 2 | - | T2 = .062" EM | 103 | - | |

PXX-201005U-XXX BASE - ABS, BLACK

| STEP NO | DESCRIPTION | CUTTER | FIXTURE | ORIENTATION | PROGRAM |
|---------|-------------|---------------|---------|-------------|---------|
| 3 | - | T2 = .062" EM | 103 | - | |
| 4 | - | T2 = .062" EM | 103 | - | |

TOLERANCES: UNLESS OTHERWISE SPECIFIED
DIMENSIONS ARE IN U.S. INCHES.
X.XX = .015 X.XXXX = .001
X.XXX = .010 X.X° = 1°

NEW AGE ENCLOSURES

Customer's Part No: 201005

| | | |
|----------|-----------|------|
| APPROVAL | BY | DATE |
| CHECK | | |
| ENG. | | |
| SCALE | AS NOTED | |
| DRAWN BY | 21-May-07 | |
| M BOYER | | |

NEW AGE ENCLOSURES

4330 Santa Fe Road San Luis Obispo, CA. 93401
ph. (805) 595-1310 fax (805) 595-1024
www.newageenclosures.com

**STANDARD - USB DEVICE
PXX-201005X ASSEMBLY**

| | | | |
|------|--------------|--------|---------|
| SIZE | DRAWING NAME | SHEET | REV.DOC |
| A | 201005_R7_1 | 6 OF 6 | 7.1 |

AMEYA360

Components Supply Platform

Authorized Distribution Brand :



Website :

Welcome to visit www.ameya360.com

Contact Us :

➤ Address :

401 Building No.5, JiuGe Business Center, Lane 2301, Yishan Rd
Minhang District, Shanghai , China

➤ Sales :

Direct +86 (21) 6401-6692

Email amall@ameya360.com

QQ 800077892

Skype ameyasales1 ameyasales2

➤ Customer Service :

Email service@ameya360.com

➤ Partnership :

Tel +86 (21) 64016692-8333

Email mkt@ameya360.com