

Instrument Lite Relampable Indicator Lights

Description and Features

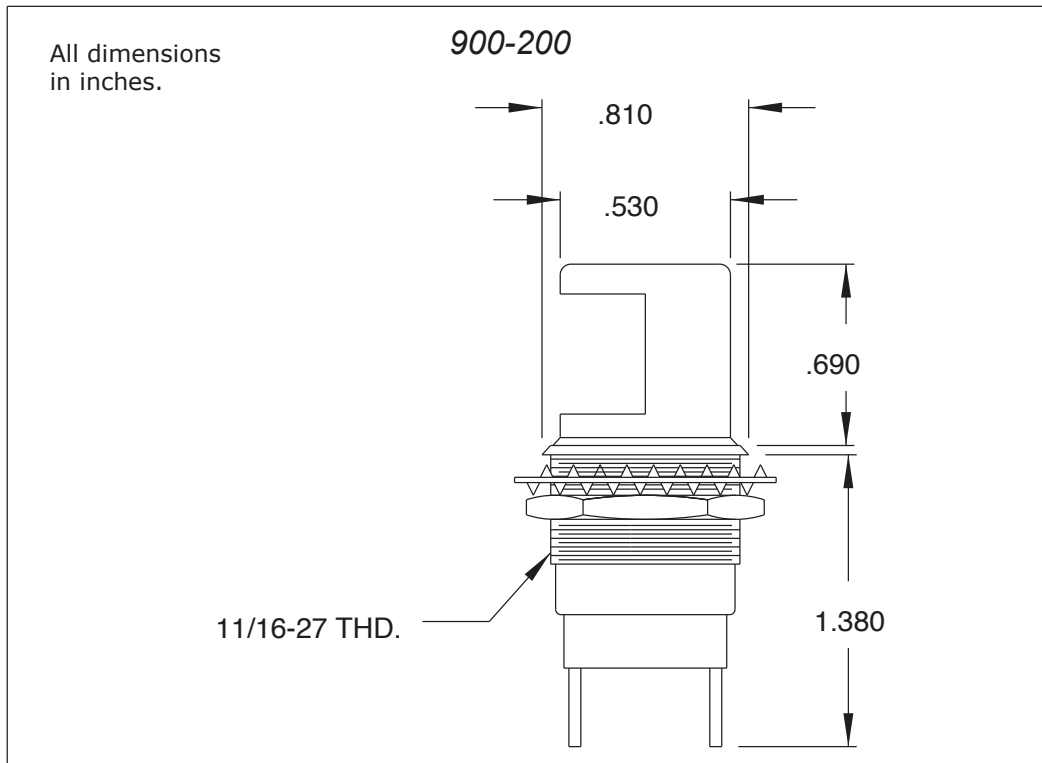

Chicago Miniature Lamp Instrument Lites are specifically designed to provide localized light for illuminating panels, meters, switches and legends. The Chicago Miniature Lamp Instrument Lite features a highly reflective surface on the inside of the hood to assure peak light output and is easily relamped from the front of the panel. The lamp is not included with this indicator light; please order the required lamp separately.

Specifications

	900-200
Mounting Hole:	.688
Mounting Centers:	.969
Maximum Panel Thickness:	.406
Housing/Material:	Black anodized aluminum
Hood Material:	Black matte on aluminum
Terminals:	Solder lug terminals
Hex Nut:	Zinc Plated steel
Lockwasher:	Chrome treated steel
Electrical Rating:	up to 250 Volts, up to 3 Watts
Lamp Used:	T-2 or T-3 1/4 Miniature bayonet

AMEYA360

Components Supply Platform

Authorized Distribution Brand :



Website :

Welcome to visit www.ameya360.com

Contact Us :

➤ Address :

401 Building No.5, JiuGe Business Center, Lane 2301, Yishan Rd
Minhang District, Shanghai , China

➤ Sales :

Direct +86 (21) 6401-6692

Email amall@ameya360.com

QQ 800077892

Skype ameyasales1 ameyasales2

➤ Customer Service :

Email service@ameya360.com

➤ Partnership :

Tel +86 (21) 64016692-8333

Email mkt@ameya360.com