

FEATURES AND BENEFITS

- DuraBlue™ Shock and Vibration Technology
- Up to 1,000,000 duty cycles or 10 year DC life*
- Highest power and energy
- Up to 18 kW/kg of Specific Power²
- Up to 4.00 Wh of Stored Energy²
- Threaded terminals or laser-weldable posts

TYPICAL APPLICATIONS

- High shock and vibration environments
- Automotive subsystems
- Wind turbine pitch control
- Hybrid vehicles
- Rail
- Heavy industrial equipment
- UPS & telecom systems



PRODUCT SPECIFICATIONS

ELECTRICAL	BCAP3400
Rated Capacitance ¹	3,400 F
Minimum Capacitance, initial ¹	3,400 F
Typical Capacitance, initial ^{1,2}	3,550 F
Maximum Capacitance, initial ¹	3,740 F
Typical ESR _{DC} , initial ^{1,2}	0.22 mΩ
Maximum ESR _{DC} , initial ¹	0.28 mΩ
Test Current for Capacitance and ESR _{DC} ¹	100 A
Rated Voltage	2.85 V
Absolute Maximum Voltage ³	3.0 V
Absolute Maximum Current	2,500 A

POWER & ENERGY	
Minimum Usable Specific Power, P_d^5	6.7 kW/kg
Typical Usable Specific Power, $P_d^{2,5}$	8.5 kW/kg
Minimum Impedance Match Specific Power, P_{max}^6	14 kW/kg
Typical Impedance Match Specific Power, $P_{max}^{2,6}$	18 kW/kg
Minimum Specific Energy, E_{max}^7	7.4 Wh/kg
Typical Specific Energy, $E_{max}^{2,7}$	7.7 Wh/kg
Minimum Stored Energy, $E_{stored}^{8,12}$	3.84 Wh
Typical Stored Energy, $E_{stored}^{2,8,12}$	4.00 Wh

SHOCK & VIBRATION	
Vibration Specification	ISO 16750-3, Tables 12 & 14
Shock Specification	SAE J2464, IEC 60068-2-27, -29

SAFETY	
Short Circuit Current, typical (Current possible with short circuit from rated voltage. Do not use as an operating current.)	10,000 A
Certifications	UL810a, RoHS, REACH

TYPICAL CHARACTERISTICS

TEMPERATURE	BCAP3400
Operating temperature range (Cell case temperature)	
Minimum	-40°C
Maximum	65°C
Storage temperature range (Stored uncharged)	
Minimum	-40°C
Maximum	70°C

ELECTRICAL	
Leakage Current at 25°C, typical ⁴	15 mA

LIFE	
DC Life at High Temperature ¹ (held continuously at Rated Voltage & Maximum Operating Temperature)	1,500 hours
Capacitance Change (% decrease from minimum initial value)	25%
ESR Change (% increase from maximum initial value)	110%
Projected DC Life at 25°C ¹ (held continuously at Rated Voltage)	10 years
Capacitance Change (% decrease from minimum initial value)	20%
ESR Change (% increase from maximum initial value)	100%
Projected Cycle Life at 25°C ^{1, 10, 11}	1,000,000 cycles
Capacitance Change (% decrease from minimum initial value)	20%
ESR Change (% increase from maximum initial value)	100%
Test Current	100 A
Shelf Life (Stored uncharged at 25°C)	4 years

*Results may vary. Additional terms and conditions, including the limited warranty, apply at the time of purchase. See the warranty details for applicable operating and use requirements.

PRODUCT SPECIFICATIONS (Cont'd)

THERMAL	BCAP3400	PHYSICAL	BCAP3400
Thermal Resistance (R_{th} , Case to Ambient), typical ⁹	3.2°C/W	Mass, typical	520 g
Thermal Capacitance (C_{th}), typical	640 J/°C	Terminals	Threaded or Weldable
Maximum Continuous Current ($\Delta T = 15^{\circ}\text{C}$) ⁹	131 A _{RMS}	Maximum Terminal Torque (K04)	14 Nm
Maximum Continuous Current ($\Delta T = 40^{\circ}\text{C}$) ⁹	211 A _{RMS}		

MOUNTING RECOMMENDATIONS

Do not reverse polarity. Please refer to document number 1016419, available at maxwell.com for welding recommendations.

NOTES

- Capacitance and ESR_{DC} measured at 25°C using specified test current in K2 2.7V Series Datasheet.
- Typical values represent mean values of a production sample.
- Absolute maximum voltage, non-repeated. Not to exceed 1 second.
- After 72 hours at rated voltage. Initial leakage current can be higher.
- Per IEC 62391-2, $P_d = \frac{0.12V^2}{ESR_{DC} \times \text{mass}}$
- $P_{max} = \frac{V^2}{4 \times ESR_{DC} \times \text{mass}}$
- $E_{max} = \frac{\frac{1}{2} CV^2}{3,600 \times \text{mass}}$
- $E_{stored} = \frac{\frac{1}{2} CV^2}{3,600}$
- $\Delta T = I_{RMS}^2 \times ESR \times R_{ca}$
- Cycle using specified test current per waveform in K2 2.7V Series Datasheet.
- Cycle life varies depending upon application-specific characteristics. Actual results will vary.
- Per United Nations material classification UN3499, all Maxwell ultracapacitors have less than 10 Wh capacity to meet the requirements of Special Provisions 361. When packaged according to the regulation, both individual ultracapacitors and modules composed of those ultracapacitors shipped by Maxwell can be transported without being treated as dangerous goods (hazardous materials).

MARKINGS

Products are marked with the following information: Rated capacitance, rated voltage, product number, name of manufacturer, positive terminal, warning marking, serial number.

BCAP3400 P285 K04

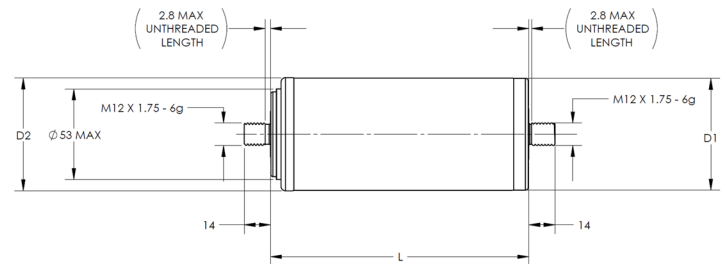

BCAP3400 P285 K05

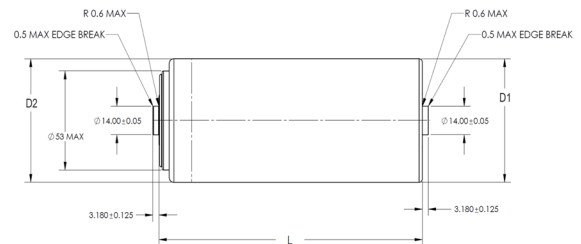

Part Description	Dimensions (mm)			Package Quantity
	L (±0.3mm)	D1 (±0.2mm)	D2 (±0.7mm)	
BCAP3400 P285 K04/05	138	60.4	60.7	15

Product dimensions are for reference only unless otherwise identified. Product dimensions and specifications may change without notice.

Please contact Maxwell Technologies directly for any technical specifications critical to application. All products featured on this datasheet are covered by the following U.S. patents and their respective foreign counterparts: 6643119, 7295423, 7342770, 7352558, 7384433, 7440258, 7492571, 7508651, 7580243, 7791860, 7791861, 7859826, 7883553, 7935155, 8072734, 8098481, 8279580.



Maxwell Technologies, Inc.
Global Headquarters
 3888 Calle Fortunada
 San Diego, CA 92123
 USA
 Tel: +1 858 503 3300
 Fax: +1 858 503 3301



Maxwell Technologies SA
 Route de Montena 65
 CH-1728 Rossens
 Switzerland
 Tel: +41 (0)26 411 85 00
 Fax: +41 (0)26 411 85 05



Maxwell Technologies, GmbH
 Leopoldstrasse 244
 80807 München
 Germany
 Tel: +49 (0)89 / 4161403 0
 Fax: +49 (0)89 / 4161403 99



Maxwell Technologies, Inc.
Shanghai Trading Co. Ltd.
 Unit A2,C 12th Floor
 Huarun Times Square
 500 Zhangyang Road,
 Pudong New Area
 Shanghai 200122,
 P.R. China
 Phone: +86 21 3852 4000
 Fax: +86 21 3852 4099



Maxwell Technologies Korea Co., Ltd.
 Room 1524, D-Cube City
 Office Tower, 15F #662
 Gyeongin-Ro, Guro-Gu,
 Seoul, 152-706
 South Korea
 Phone: +82 10 4518 9829

MAXWELL TECHNOLOGIES, MAXWELL, MAXWELL CERTIFIED INTEGRATOR, ENABLING ENERGY'S FUTURE, BOOSTCAP, C CELL, D CELL and their respective designs and/or logos are either trademarks or registered trademarks of Maxwell Technologies, Inc. and may not be copied, imitated or used, in whole or in part, without the prior written permission from Maxwell Technologies, Inc. All contents copyright © 2014 Maxwell Technologies, Inc. All rights reserved. No portion of these materials may be reproduced in any form, or by any means, without prior written permission from Maxwell Technologies, Inc.

AMEYA360

Components Supply Platform

Authorized Distribution Brand :



Website :

Welcome to visit www.ameya360.com

Contact Us :

➤ Address :

401 Building No.5, JiuGe Business Center, Lane 2301, Yishan Rd
Minhang District, Shanghai , China

➤ Sales :

Direct +86 (21) 6401-6692

Email amall@ameya360.com

QQ 800077892

Skype ameyasales1 ameyasales2

➤ Customer Service :

Email service@ameya360.com

➤ Partnership :

Tel +86 (21) 64016692-8333

Email mkt@ameya360.com