

UNCONTROLLED DOCUMENT

29F0428-0T0-10



PHYSICAL DIMENSIONS:

A	10.88 [.428]	+ 0.15 [.006]
B	10.88 [.428]	+ 0.15 [.006]
C	10.57 [.416]	+ 0.20 [.008]
D	7.62 [.300]	+ 0.13 [.005]
E	2.54 [.100]	+ 0.05 [.002]
G	3.18 [.125]	+ 0.38 [.015]
H	11.43 [.450]	+ MAX

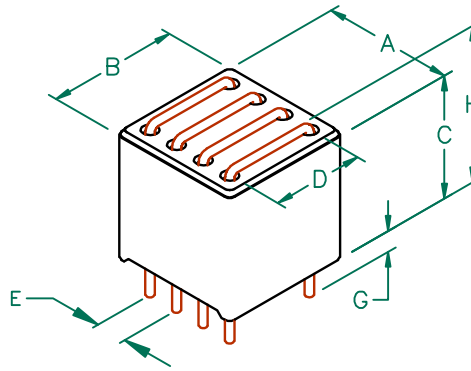

ELECTRICAL CHARACTERISTICS:

Z @ 100MHz (Ω)	DCR (Ω)	Rated Current
Nominal	342	
Minimum	257	
Maximum	427	10,000 mA

NOTES: UNLESS OTHERWISE SPECIFIED

1. BULK PACKED 910 per CASE.
2. COMPONENTS SHOULD BE ADEQUATELY PREHEATED BEFORE SOLDERING.
3. TERMINATION FINISH IS 100% TIN.

HOLE PATTERN FOR THRU-HOLE INSERTION

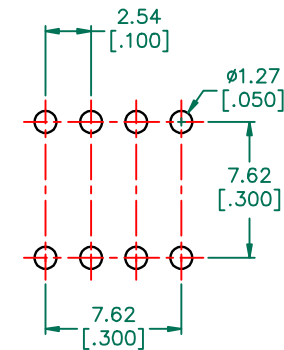
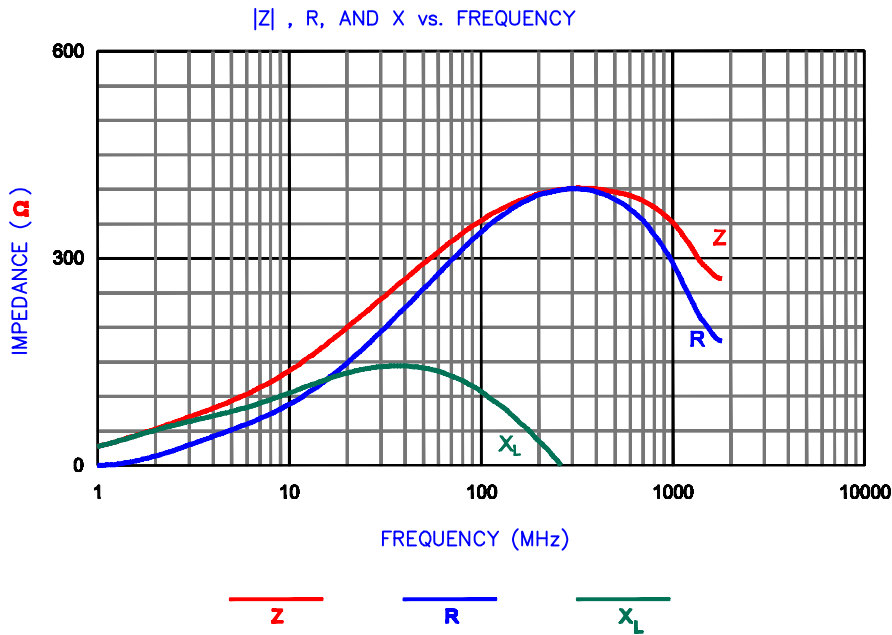

DIMENSIONS ARE IN mm [INCHES]				This print is the property of Laird Tech. and is loaned in confidence subject to return upon request and with the understanding that no copies shall be made without the written consent of Laird Tech. All rights to design or invention are reserved.			
PROJECT/PART NUMBER:				REV	PART TYPE:	DRAWN BY:	
C UPDATE COMPANY LOGO ADD ROHS SYM 10/21/08 JRK				C	CNZ ASSEMBLY	JRK	
B UPDATE COMPANY LOGO 05/01/07 JRK				DATE:	NTS	SHEET:	
A ORIGINAL DRAFT 04/30/04 JRK				04/30/04		2 of 3	
REV DESCRIPTION DATE INT				GAD #	TOOL #		
				29F0428-0T0-10-C-2	H0428		

AMEYA360

Components Supply Platform

Authorized Distribution Brand :



Website :

Welcome to visit www.ameya360.com

Contact Us :

➤ Address :

401 Building No.5, JiuGe Business Center, Lane 2301, Yishan Rd
Minhang District, Shanghai , China

➤ Sales :

Direct +86 (21) 6401-6692

Email amall@ameya360.com

QQ 800077892

Skype [ameyasales1](#) [ameyasales2](#)

➤ Customer Service :

Email service@ameya360.com

➤ Partnership :

Tel +86 (21) 64016692-8333

Email mkt@ameya360.com